

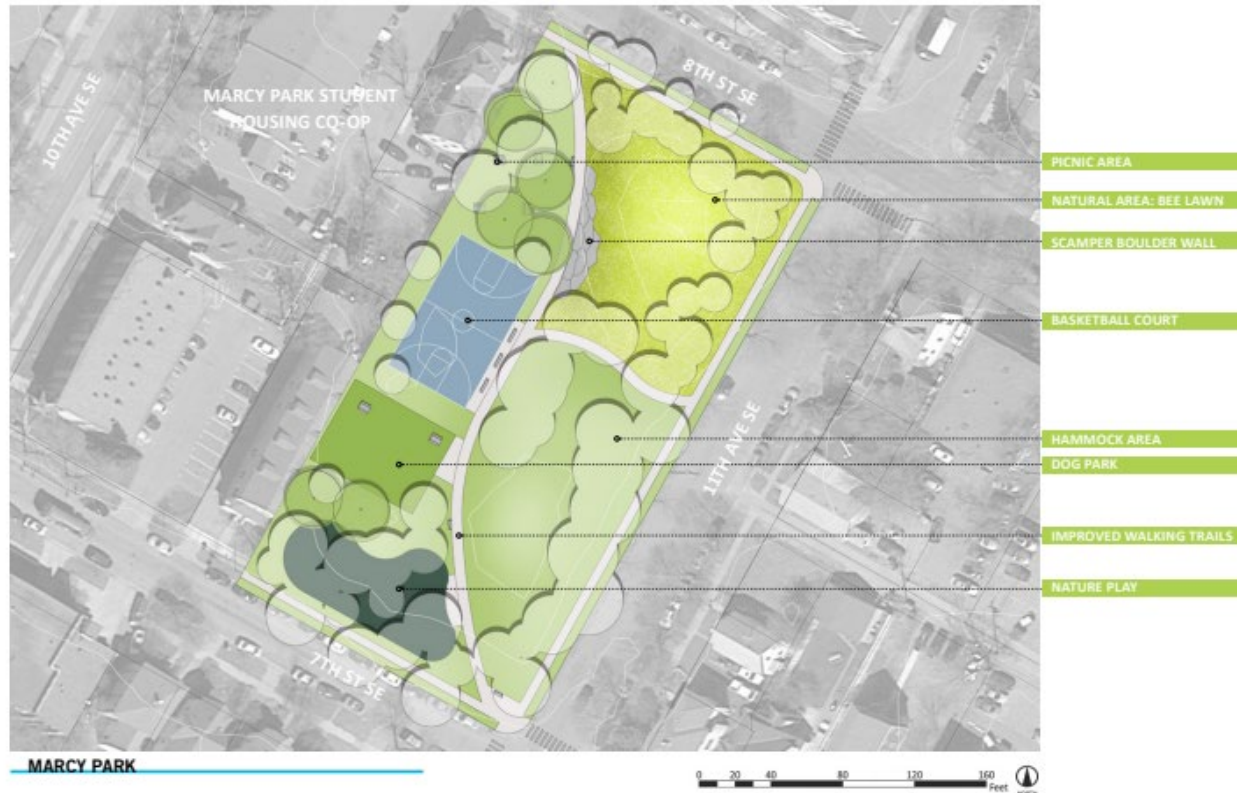

# Marcy Park

## Proposed Concept Plan - Site Improvements





# Marcy Park

## Proposed Concept Plan - Site Improvements

**Tonight: Seeking Board approval for the Proposed Concept Plan  
and Site Improvements for Marcy Park**



# Marcy Park

## Proposed Concept Plan - Site Improvements

### Marcy Park Master Plan

Concept is based on the East of the River Park Plan for Marcy Park approved by the Board on March 27<sup>th</sup>, 2019 after one and a half years of intensive engagement. The approved master plan includes:

- a picnic area,
- naturalized areas or bee lawn,
- a scamper boulder wall,
- a basketball court,
- a hammock area,
- a dog park,
- improved walking trails, and
- multi-generational nature play
- Young adult and university student age focus to park design





# Marcy Park

## Proposed Concept Plan - Site Improvements

### Community Engagement Process

- Project webpage
- .gov email announcements
- Neighborhood website and newsletter
- Park signs
- Emails to community stakeholders including preschool, etc.
- Several online surveys
  - 1<sup>st</sup> survey with multiple design concepts: 120 respondents
  - 2<sup>nd</sup> survey of final design: 18 respondents
- Mailed communications
- Neighborhood organization annual meeting engagement (presentation)
- Park Dedication Fee Task Force with Marcy-Holmes engagement
- MPRB staff Project Advisory Committee
- Efforts to engage students: MPRB staff solicited comments from U of M students through student organization representatives via our survey or email.



# Marcy Park

## Proposed Concept Plan - Site Improvements

### **Proposed Concept Plan Design Considerations**

- Master plan, community feedback, and staff input guided master plan development.
- Total funding available is \$536,495 – 2020-21 Capital Improvement Program.
- Site has debris from former school mixed with ash scattered throughout the park.
- Concept to minimize excavation and removing soils due to cost of disposal.
- Need for updated pathways throughout the park since the existing park paths were professionally assessed as in very poor condition.
- The electrical service was identified by staff as in urgent need of updating, during our scoping phase.
- The pavilion and unusable drinking fountain also need to be removed per staff recommendation.
- Improvements focus on new accessible internal trails, a new half basketball court, a new dog park with a stormwater infiltration area, and a new electrical service. Several alternates are included.
- Alternates include picnic tables, benches, a new drinking fountain, re-feeding all pedestrian lights in the park, hammock stands, a full basketball court, and restoring disturbed turf with bee lawn.
- The existing 5-12 play area will remain during this phase of improvements.
- Future phases may include boulder scamper wall, nature play, and items not able to be added that are listed as alternates.



# Marcy Park

## Proposed Concept Plan - Site Improvements

### Concept Priorities

- Fenced in Dog Park with Stormwater Treatment
- Half Basketball Court (Full is an Alternate)
- Replacement Trees
- New Paths Providing Accessible Routes to Park Amenities
- New Electrical Service

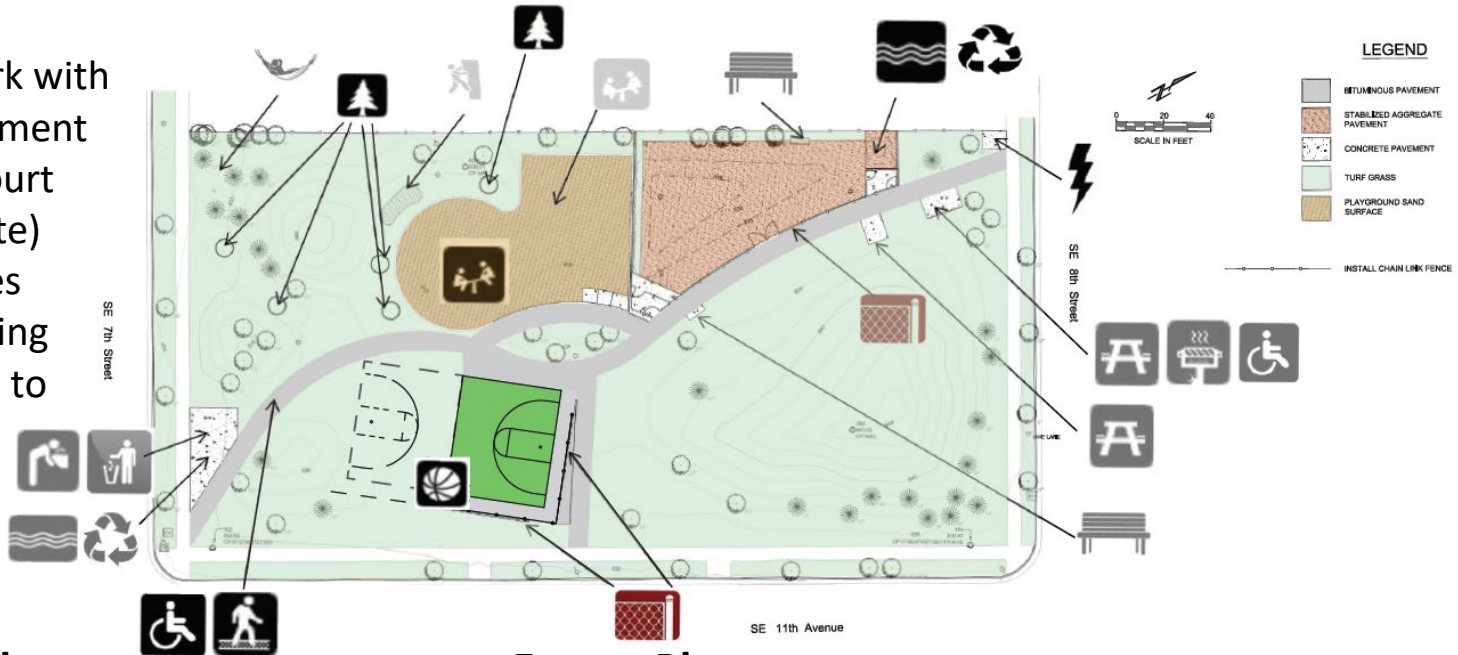

### Alternates in this Phase

- Benches
- Picnic Tables (one ADA) with Grill
- Drinking Fountain with Area for Trash
- Hammock Stands
- Bee Lawn where Turf is Disturbed
- Re-feeding all Internal Pedestrian Lighting.
- Full Court Basketball (Non-Regulation)

### Future Phase

- Bouldering Wall
- Nature Play
- Items Not Updated in Phase 1

Note: Final elements are subject to approval of regulatory authorities, bids fitting into project budget, and a successful<sup>6</sup> bid award. Design is conceptual. Final elements may vary slightly.



# Marcy Park

## Proposed Concept Plan - Site Improvements

### **What did we hear during Community Engagement?**

#### Community Engagement Scoping and Priorities Phase – Spring- Summer 2020

- Community members expressed interest in a variety of improvements and preserving green space.
- Neighborhood Park Dedication Fee Task Force expressed interest in developing park amenities which better fit the needs of university students, including support for basketball and a dog park.

#### Community Engagement Concept Feedback – Fall- Winter 2020-21

- Feedback was varied – no dominant themes
- Interest in nature play area implementation (planned for future phase and not a strong theme in first survey with many respondents; was primarily from outside neighborhood zip code)
- Several requests for pollinator areas or native plants (will work to incorporate in plantings if there are opportunities in this project and in future projects - as funding permits)
- Two commenters were very excited about dog park; one against
- Two community requests for full court basketball if funding becomes available (court oriented for expansion)
- A few requests for hammock posts
- A comment to focus on things other than park improvements
- A request for swings
- One request for a community garden
- Support for increased accessibility from new paths



# Marcy Park

## Proposed Concept Plan - Site Improvements

**Questions?**