

# STEWART PARK

## APPROVED MASTER PLAN

The Stewart Park Master Plan image below is from the South Area Master Plan. The master plan was approved in 2016, and is the result of two years of intensive community engagement.

Our project funding is earmarked for implementing site improvements indicated in, or consistent with, the approved Master Plan. We are have been engaging the community to identify priorities for improvements that fit into our project budget.

We’ve been asking about the items noted below as “New” and have also heard requests for a few items that are consistent with the master-plan. We don’t have enough funding to implement everything currently shown below.

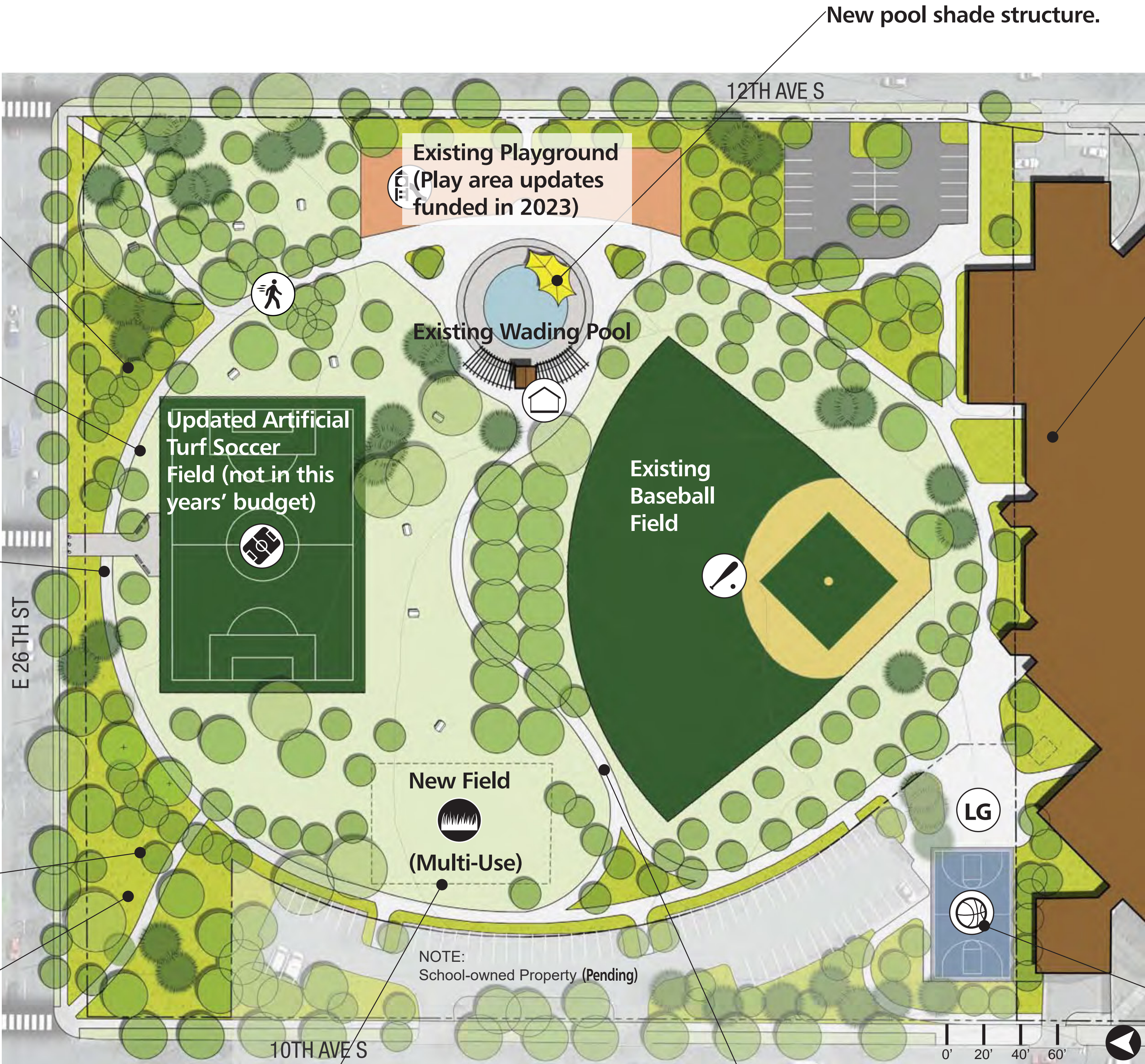

New natural planted areas or bee lawn.

New - more benches and/or bleachers.

New - safety improvements to field along E 26th such as taller fencing or net. (not in master plan, but recommended by neighborhood and consistent with master plan.

New - more picnic tables.

New natural planted areas or bee lawn.

Multi-use Field (open grassy area that may be used for soccer or other sports)

Recreation Center improvements are not part of the master plan. Recreation Centers are addressed in *Closing the Gap, Investing in Youth*, and will be addressed by other funding sources.

MPRB would like to delay work and improvements for the basketball court which will no longer be on parkland after the land exchange takes place, due to a pending land exchange between the school and MPRB.



# STEWART PARK COMMUNITY ENGAGEMENT RESULTS

## Engagement Dashboard

The dashboard below shows engagement information and general responses.



9

Nine community engagement events. (Includes a neighborhood meeting, pop-up on-site surveys with park users, and attending other stakeholder events.)



429

In-person contacts at events.



35

Thirty-five online survey respondents from either Anderson School or from those visiting our project webpage.

## Priorities Expressed Aligning With Stewart Park Approved Master Plan

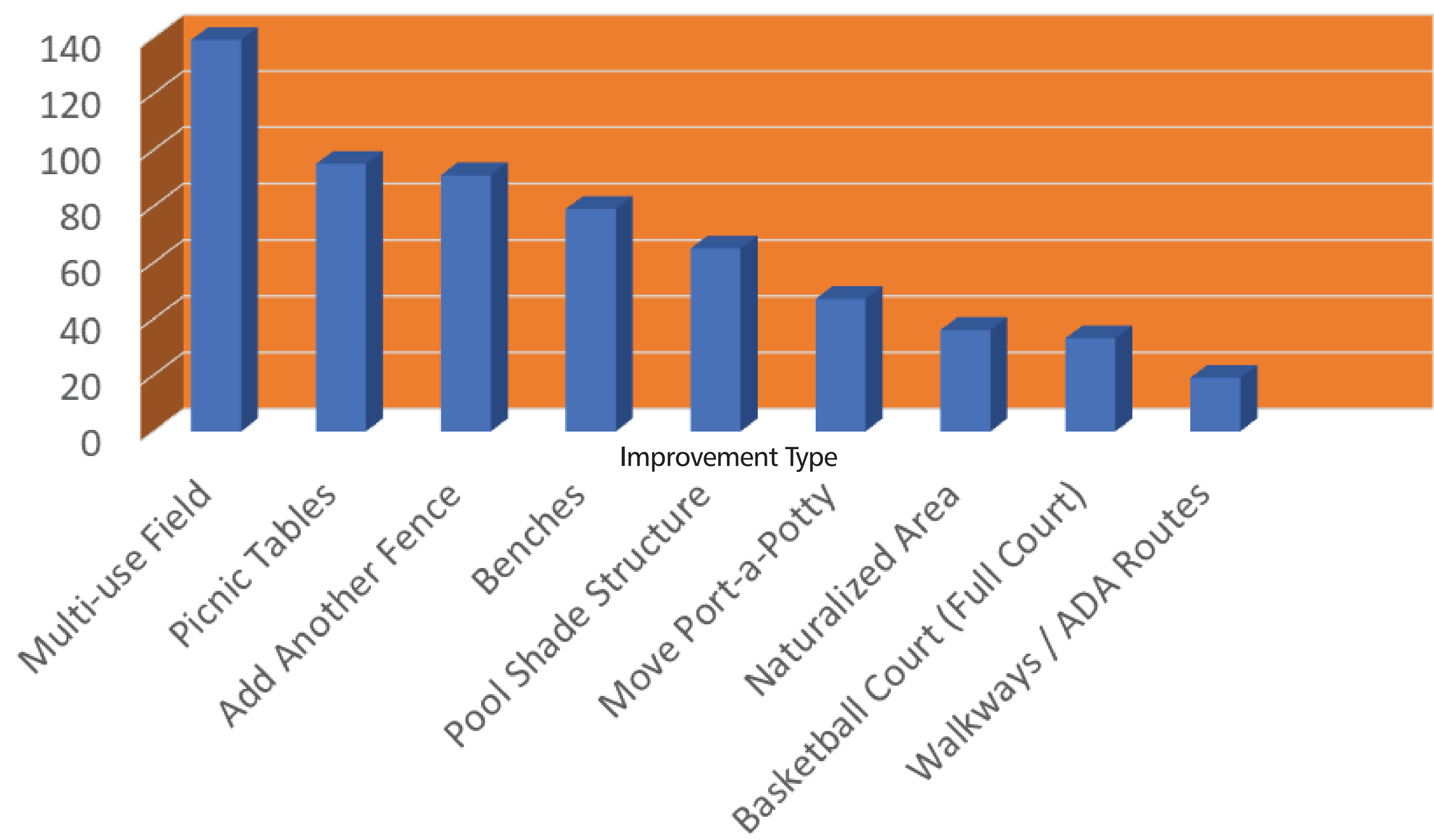

## Next Steps!

Note: Updated 8/19/20 due to modified next steps.

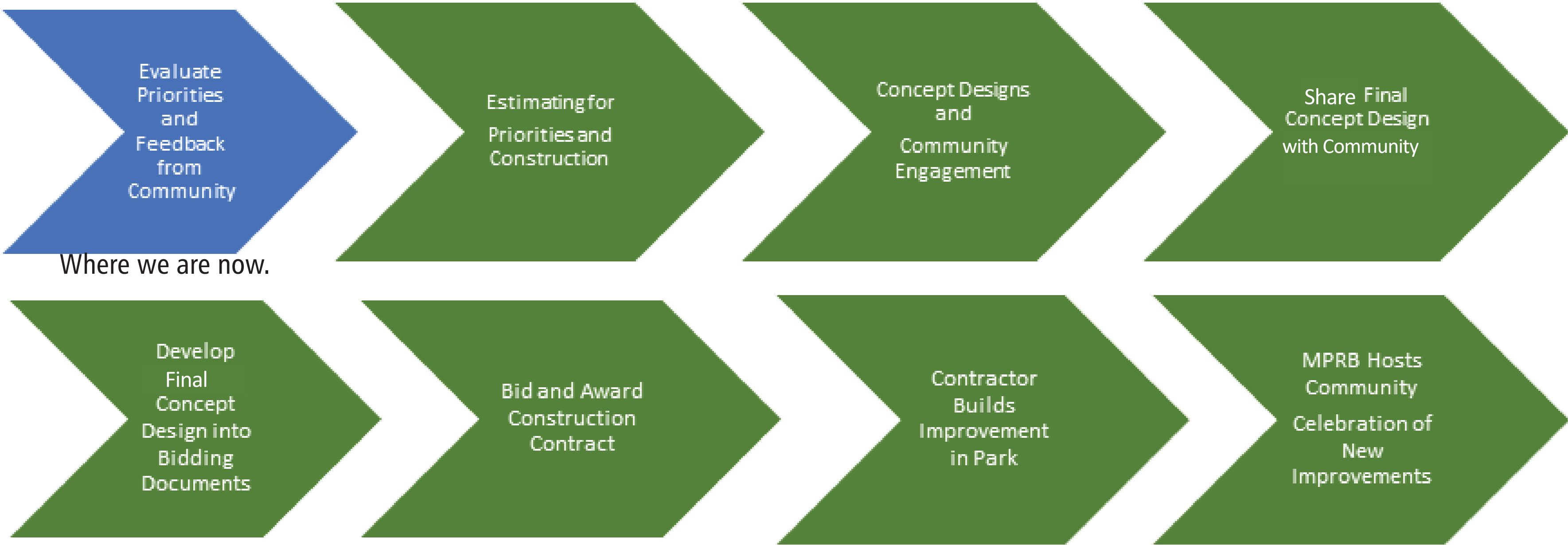

# STEWART PARK

## COMMUNITY ENGAGEMENT RESULTS

### Engagement Dashboard

The dashboard below shows engagement information and general responses.



9

Nine community engagement events. (Includes a neighborhood meeting, pop-up on-site surveys with park users, and attending other stakeholder events.)



429

In-person contacts at events.



35

Thirty-five online survey respondents from either Anderson School or from those visiting our project webpage.

### Priorities Expressed Aligning With Stewart Park Approved Master Plan

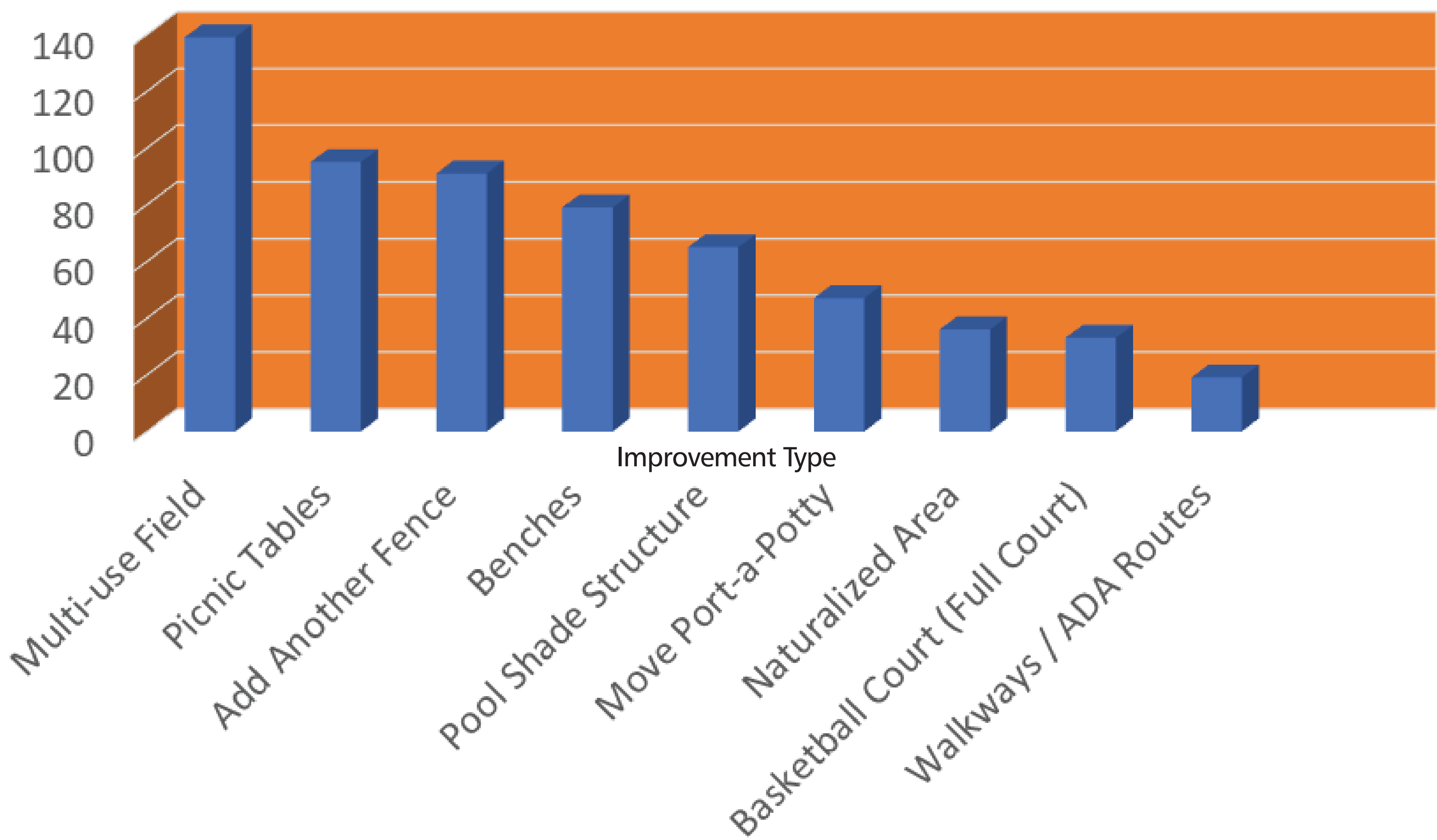

### Next Steps!

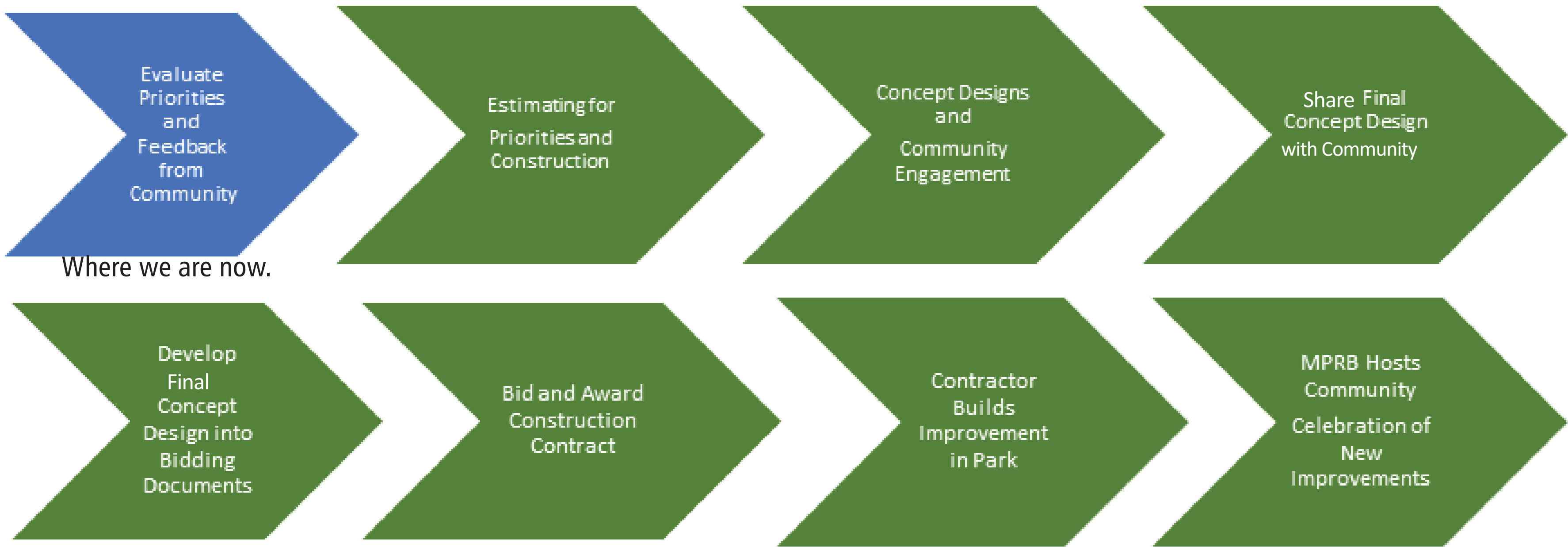

# STEWART PARK

# COMMUNITY ENGAGEMENT RESULTS

## Other Comments and Ideas with MPRB Planning Responses

The following is a summary of the comments collected, including verbal comments made to staff, written comments left on maps at the meetings and public engagement activities, and comments the online survey. The comments have been summarized by staff. Some comments are combined. Included below are responses from MPRB Planning.

| Category/Comments  | MPRB Planning Response   |
|--|--|
| Safety   |  |
| For safety recommend crosswalk flashing lights on E 26th ST and 11th Ave   | This falls under the City of Minneapolis.  |
| For safety recommend no parking on E 26th ST on MPRB property  | The City added parking along E 26th St. in 2018. Parking is on City property and not on parkland.  |
| For safety recommend a designated left turn only on E 26th ST to turn onto 10th Ave  | This falls under the City of Minneapolis.  |
| Current drug use? Will it continue post construction? Will money be spent, and no one will still use it?   | MPRB staff is not sure of the context of this comment. None of the potential improvements are anticipated to have a major impact to limit drug use.  |
| From safety perspective No naturalized areas – vermin, trash, needles  | No naturalized areas are being considered in Phase 1 improvements due to safety and maintenance concerns.  |
| From safety perspective move the porta-potty anywhere it can be monitored with the camera  | MPRB is getting estimates for this work and is considering including it in the Phase 1 scope.  |
| Cameras outside need to be monitored inside by the park board.   | This is not a current MPRB Policy and Procedure. This request falls outside our scope but it will be passed along to MPRB staff.   |
| Need more cameras and lights   | Additional cameras were added on the building in 2019. No additional cameras are currently being considered in Phase 1 improvements, since it wasn't considered one of the highest priorities and because of high estimated costs.   |
| Raise the E 26th St. fence, add a fence, or add a net.   | MPRB is getting estimates for this work and is considering including it in the Phase 1 scope.  |
|  |  |
| Comfort and Convenience  |  |
| Benches need to be placed all over the park (around the soccer turf field, by the playground and under the trees between the baseball diamond and the soccer turf field) | MPRB is getting estimates for this work and is considering including it in the Phase 1 scope.  |
| Picnic tables need to have grills and should be small  | MPRB is getting estimates for this work and is considering including it in the Phase 1 scope.  |
| Heated benches for more winter use   | Due to budgeting constraints and because this is not a current standard in the park system, heated benches are not currently being considered in Phase 1 improvements.   |
| Review need for outside electricity for events   | MPRB has disabled one electrical receptacle outside due to misuse. This is not currently being considered in Phase 1 improvements.   |
| Water fountains  | MPRB will consider this in a future phase of work due to high estimated costs, approximately \$100,000.  |
| Install AC in the park building  | This falls outside the parameters of our funding, which is aimed at outdoor improvements.  |
|  |  |
| Ideas Not in Current Master Plan   |  |
| Explore winter uses like ice skating hockey, broomball, etc....  | This is not in the current master plan. This would require a master plan amendment. Currently, community engagement responses do not support a master plan amendment.  |
| Pond   | This is not in the current master plan nor is it funded at this time. This would require a master plan amendment and an allocation of additional funding. Currently, community engagement responses do not support a master plan amendment.  |
| Dome for field   | This is not in the current master plan nor is it funded at this time. This would require a master plan amendment and an allocation of additional funding. Currently, community engagement responses do not support a master plan amendment.  |
| Another large soccer field   | This is not in the current master plan nor is it funded at this time. This would require a master plan amendment and an allocation of additional funding. Currently, community engagement responses do not support a master plan amendment. If interest continues to be expressed, MPRB Planning is open to meet with the community. |
| Wider/larger/varying depth or extra wading pool  | This is not in the current master plan nor is it funded at this time. This would require a master plan amendment and an allocation of additional funding. Currently, community engagement responses do not support a master plan amendment.  |
| Bike trails inside park  | This is not in the current master plan nor is it funded at this time. This would require a master plan amendment and an allocation of additional funding. Currently, community engagement responses do not support a master plan amendment.  |
| Permanent bathrooms  | This is not in the current master plan nor is it funded at this time. This would require a master plan amendment and an allocation of additional funding. Currently, community engagement responses do not support a master plan amendment.  |
|  |  |
| Add more sports fields like Farview Park   | The Master Plan tried to balance all sport needs throughout the community. This would require a master plan amendment. Currently, community engagement responses do not support a master plan amendment.   |
| Add a picnic pavilion  | This is not in the current master plan nor is it funded at this time. This would require a master plan amendment and an allocation of additional funding. Currently, community engagement responses do not support a master plan amendment.  |
| Artificial turf for multi-use field  | This is not in the current master plan nor is it funded at this time. This would require a master plan amendment and an allocation of additional funding. Currently, community engagement responses do not support a master plan amendment.  |
| Place for food truck / concessions (Minnehaha Park) perhaps by the pool building   | This is not in the current master plan nor is it funded at this time. This would require a master plan amendment and an allocation of additional funding. Currently, community engagement responses do not support a master plan amendment.  |
|  |  |
| Maintenance Concerns   |  |
| Fix the soccer nets  | Currently, this is not being explored by Planning staff due to budgetary constraints. This comment will be passed along to recreation and asset management.  |
| Keep the park cleaner  | This comment does not fall under the scope of work in this project. This comment will be passed along to asset management.   |
| Plow/Remove snow on the trails and the blacktop in winter  | This comment does not fall under the scope of work in this project. This comment will be passed along to asset management.   |
| Do something to improve port-a-potty odor  | This comment does not fall under the scope of work in this project. This comment will be passed along to asset management.   |
|  |  |
| Recreation   |  |
| Improve and program baseball fields. Expand their use to other sports or activities.   | This comment does not fall under the scope of work in this project. This comment will be passed along to asset recreation.   |
| No rental on new multi-field prioritize the community  | This comment does not fall under the scope of work in this project. This comment will be passed along to asset recreation.   |
| Have parks open on the holidays  | This comment does not fall under the scope of work in this project. This comment will be passed along to asset recreation.   |
| It's too wet by the baseball field   | We will look at this issue to see if it can be addressed in our project, along with other requests. It is dependent upon our budget. This comment has been passed along to asset management.   |
|  |  |
| Other  |  |
| Add fencing on the park interior side  | We are not currently considering this in Phase 1.  |
| Playground needs to be updated; new swings and all rubber surfacing  | Playground improvements are funded in 2023.  |
| Solar lights   | We are not currently considering this in Phase 1.  |