

# Minneapolis Sculpture Garden Reconstruction and Cowles Conservatory Renovation

**Update**

**February 3, 2016**

Schedule, Budget, and Design



## **PROJECT SCHEDULE**

### **Construction bidding**

- February 11 – March 3, 2016

### **Bid award**

- April 6, 2016

### **Groundbreaking**

- April 2016

### **Construction – Sculpture Garden closed**

- May 2016 – May 2017
- Turf establishment & final sculpture installation in spring 2017

### **Grand Opening**

- June 2017

## PROJECT BUDGET

<b>Sources</b>		<b>\$10,209,500</b>
State of MN G.O. Bond	\$8,500,000	
MWMO Grant	\$1,500,000	
Hennepin County ERF Grant	\$209,500	
Toro Irrigation Equipment Donation		
<b>Uses</b>		<b>\$2,853,036</b>
Fees (Design, CM, other consultants)	\$1,960,464	
Surveys, Geotechnical, Environmental	\$129,500	
Site Preparation	\$271,790	
Allowances & Miscellaneous	\$91,282	
Project Contingency (4%)	\$400,000	
<b>Balance for construction</b>		<b>\$7,356,464</b>
<b>Construction cost estimate (50% CDs)</b>		<b>\$7,341,998</b>

# CONCEPT DESIGN approved 4/15/2015

## Fresh Meadow

- Perennials and grasses
- Turf 'lily pads', rip-rap edges
- Decomposed granite/boardwalks
- Existing arbor

## Orientation/Activity

- Existing greenhouse (removed)
- New restroom building
- Seasonal pad (Mini-Golf), low hedge
- Resurface parking lot, bus drop-off

## Spoonbridge and Cherry

- Upgraded pond, perennial edge

## Quad Rooms & Conservatory

- Decomposed granite/concrete walks, enhanced turf, perennial plantings, lower hedge, replaced trees
- Conservatory, open lawn, concrete terrace, perimeter hedge

## Edge

- Fescue, tree groves, evergreen windrow

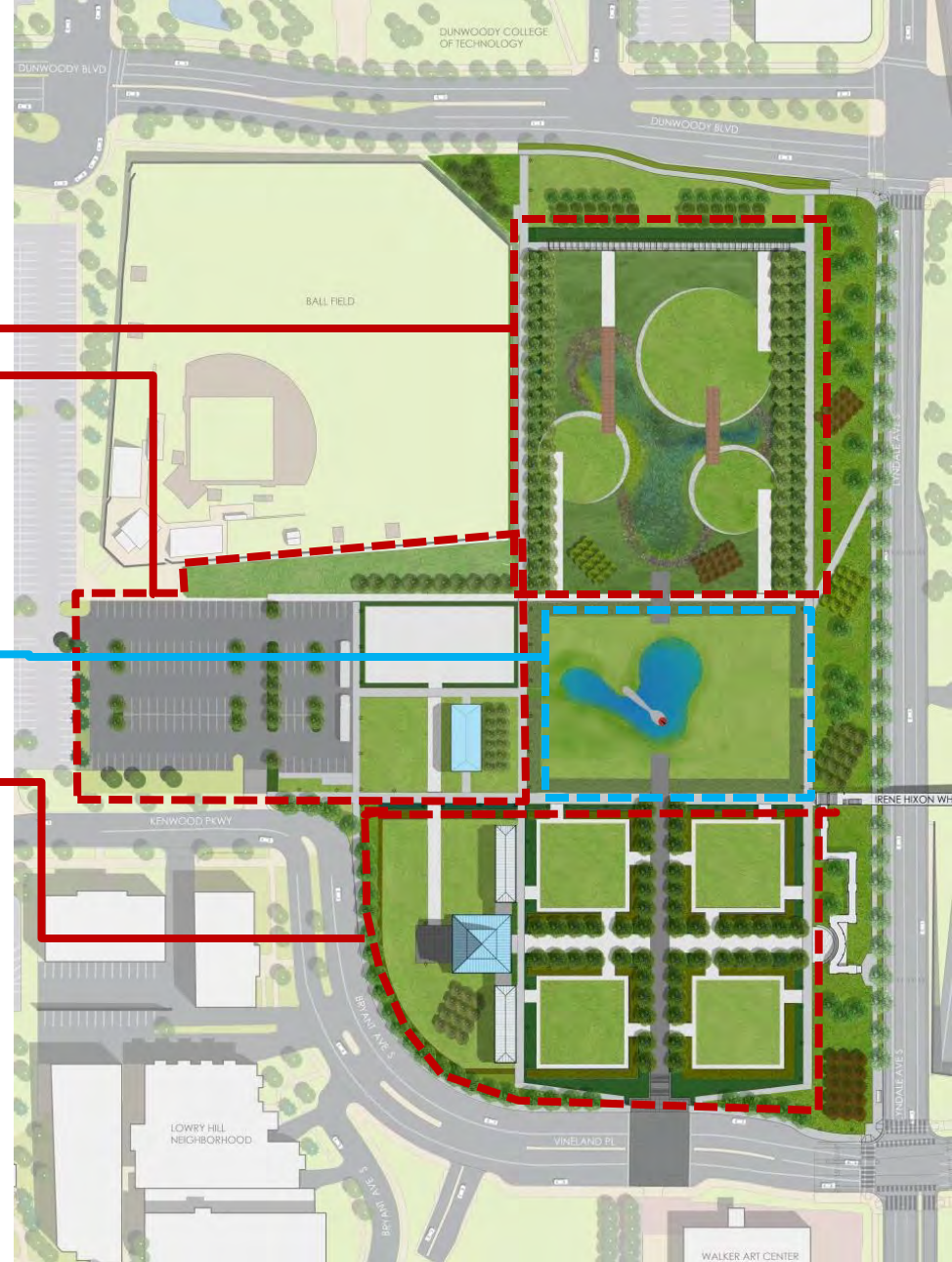

# FINAL DESIGN presented 2/3/2016

## Fresh Meadow

- New native perennial flower and sedge meadow with manicured turf 'lily pads' framed by new trees.
- New sidewalks.
- Existing arbor remains.

## Orientation/Activity

- Demolish existing back-up greenhouse and build new restroom building.
- Added area for events and programming.
- Resurface parking lot, bus drop-off.
- Pending underground storage cistern for stormwater and on-site water for reuse as site irrigation.

## Spoonbridge and Cherry

- Replace pond liner and add perennial edge.
- Enhance turf area around pond for durability.

## Quad Rooms & Conservatory

- New, accessible, concrete and crushed rock walks, enhanced turf for drainage, new perennial plantings, lower hedge in granite planters, existing linden trees remain.
- Conservatory reimagined as open-air pavilion with walls removed but glass roof remaining in place, and floors are crushed walk landscape material.

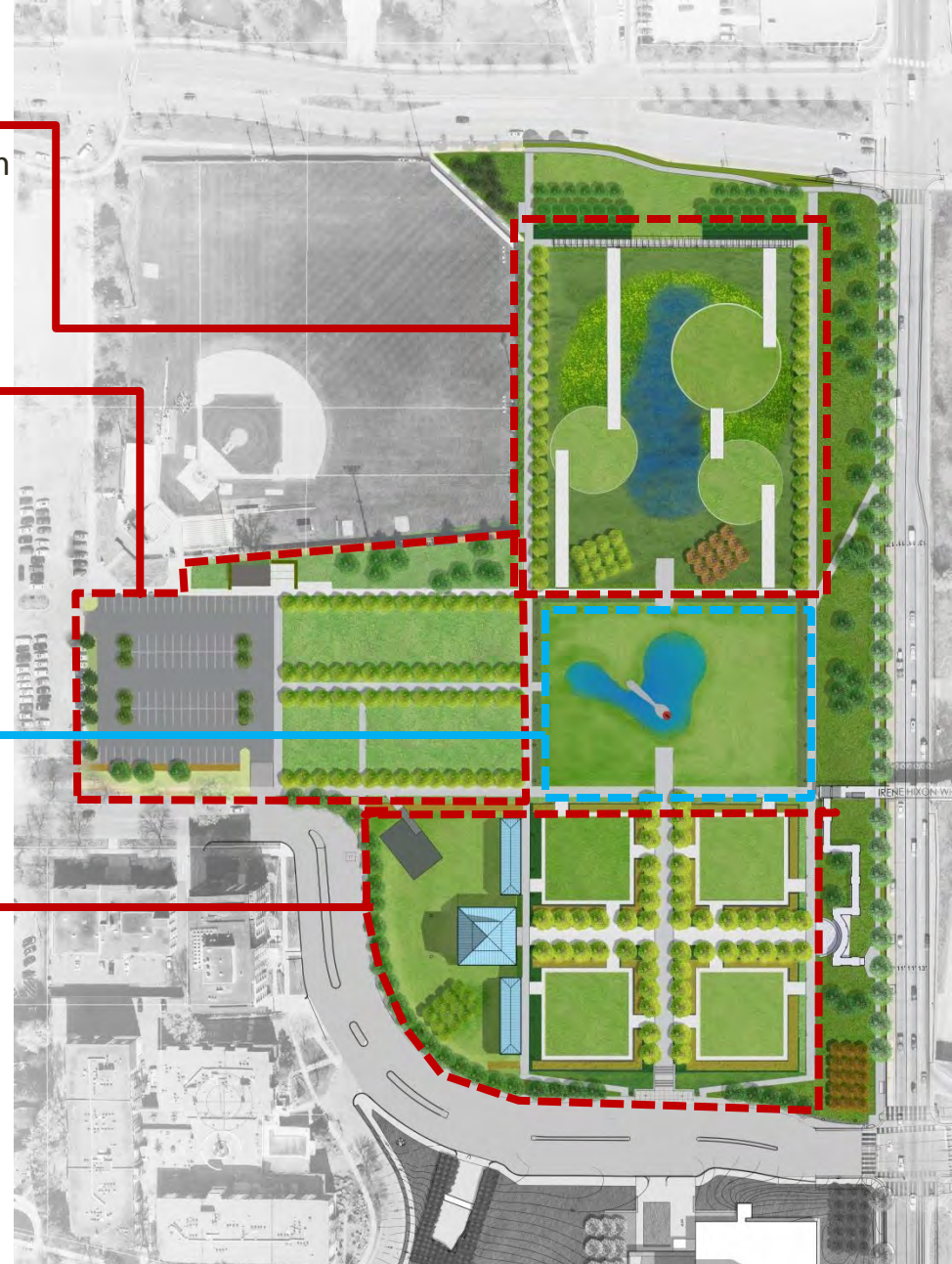







*Note: Art is a placeholder for scale. It does not represent the new art for the garden.*