



No parking lot by Bball

Do we really want to give up land for parking? Plenty of street parking

Please good. But more basketball away from Pkgs or  
You could get drive- by shootings

Have one full court + 2 half courts or little kids want get play time.

We never put pkg lots next to basketball hoops. It encourages the kids.

if there's no Pkgs Ctr.

# CAC #6

## 3.29.2018

### North Service Area Master Plan

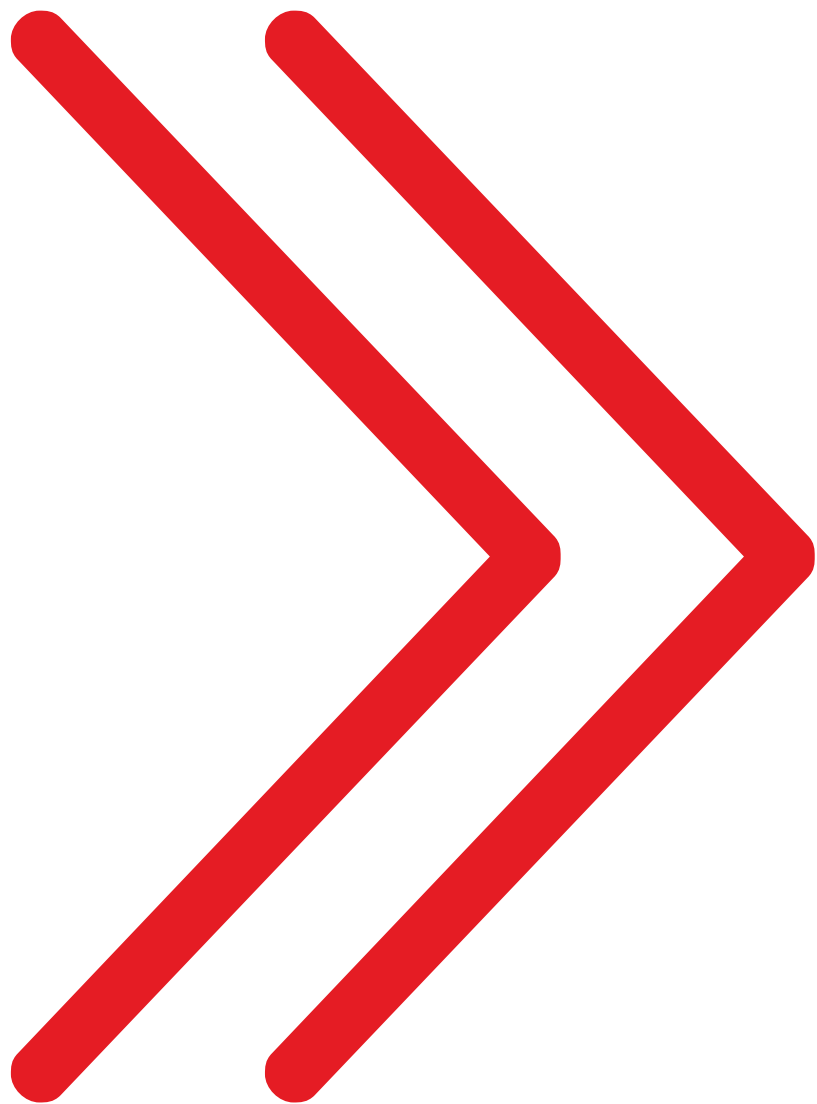

# Agenda

1. Welcome
2. Project Schedule and Next Steps
3. Guiding Principles [DRAFT]
4. Big Questions
5. Adjourn

**1**

Welcome

2

## Project Schedule



## Initial Concepts

### Public Workshops + Surveys

*Since CAC#5/Design Week there has been review of initial concepts including:*

- 4 Community Workshops
- Agency Coordination Meetings
- MPRB Internal Meetings
- Work Group Meetings
- Online Survey

# Design Phase Timeline

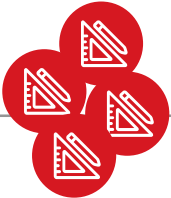

## **COMMUNITY WORKSHOPS**

Review initial concepts.  
Gather input from neighbors and community members to work towards a preferred concept

## **PREFERRED CONCEPT DEVELOPMENT**

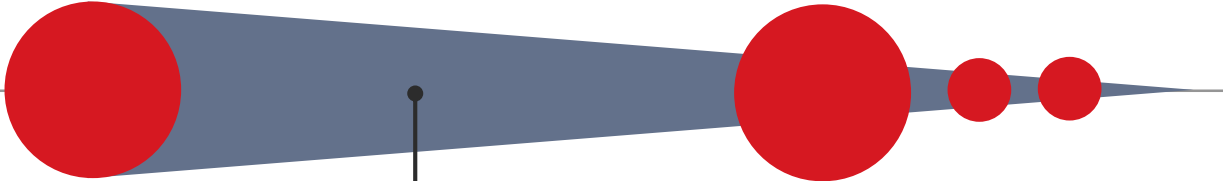

**CAC #6**  
Big Ideas.  
Guiding Principles.

**CAC #7+**  
CAC approval.  
(may take several meetings)

**WORK GROUP MEETINGS**  
**AGENCY COORDINATION**  
**MPRB STAFF COORDINATION**

## **BOARD APPROVAL**

Board approves CAC recommended plans

## **ONLINE PUBLIC COMMENT PERIOD**

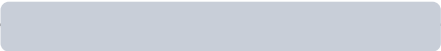

# 3

## Guiding Principles

### Discussion of DRAFT Principles

- Further the **sense of pride** in the north side through **high quality parks**. Ensure excellence and innovation in design, implementation, and maintenance.
- Work always toward **safe parks** for all, through lighting, sight lines, and increased activity.
- Work always toward parks that are **welcoming for all**. Ensure that park designs, included facilities, and overall character invite people in.
- Explore **partnerships** for funding, programming, stewardship. MPRB can't and shouldn't do everything on its own.
- Work with partner agencies to minimize the possibility of **displacement** as parks improve.

# 3

## Guiding Principles

### Discussion of DRAFT Principles

- Recognize the importance of **connections** to and between parks: safe street crossings, trail connections, roads as park connectors, greenways/bikeways, system maps at parks.
- Recognize the importance of **the basics**: water, restrooms, benches, trails, art, etc.
- Consider **all age ranges** in the design and development of parks, with particular focus on:
  - Youth voice in the process; youth focus in facility development
  - More activities and spaces for teens/young adults
  - Design for seniors: accessibility, active low-impact activities, passive activities
- Create more opportunities for **arts, music, and performance**—both programmed and spontaneous.

# 3

## Guiding Principles

### Discussion of DRAFT Principles

- Create more opportunities for **gathering**—in small groups of friends and family, as extended families, and in large community groups.
- Increase **year-round activity**. Few winter options exist in the north service area.
- Improve the parks' **environments** through natural areas, gardens, urban agriculture, and habitat enhancement

*OTHERS?*



## Design Questions

# 4

## Aquatics

### Current Level of Service

*The North Service Area currently has...*

- 13 Wading Pools
- Webber Natural Pool
- North Commons Waterpark (entry fee)
- Theodore Wirth Lake Beach

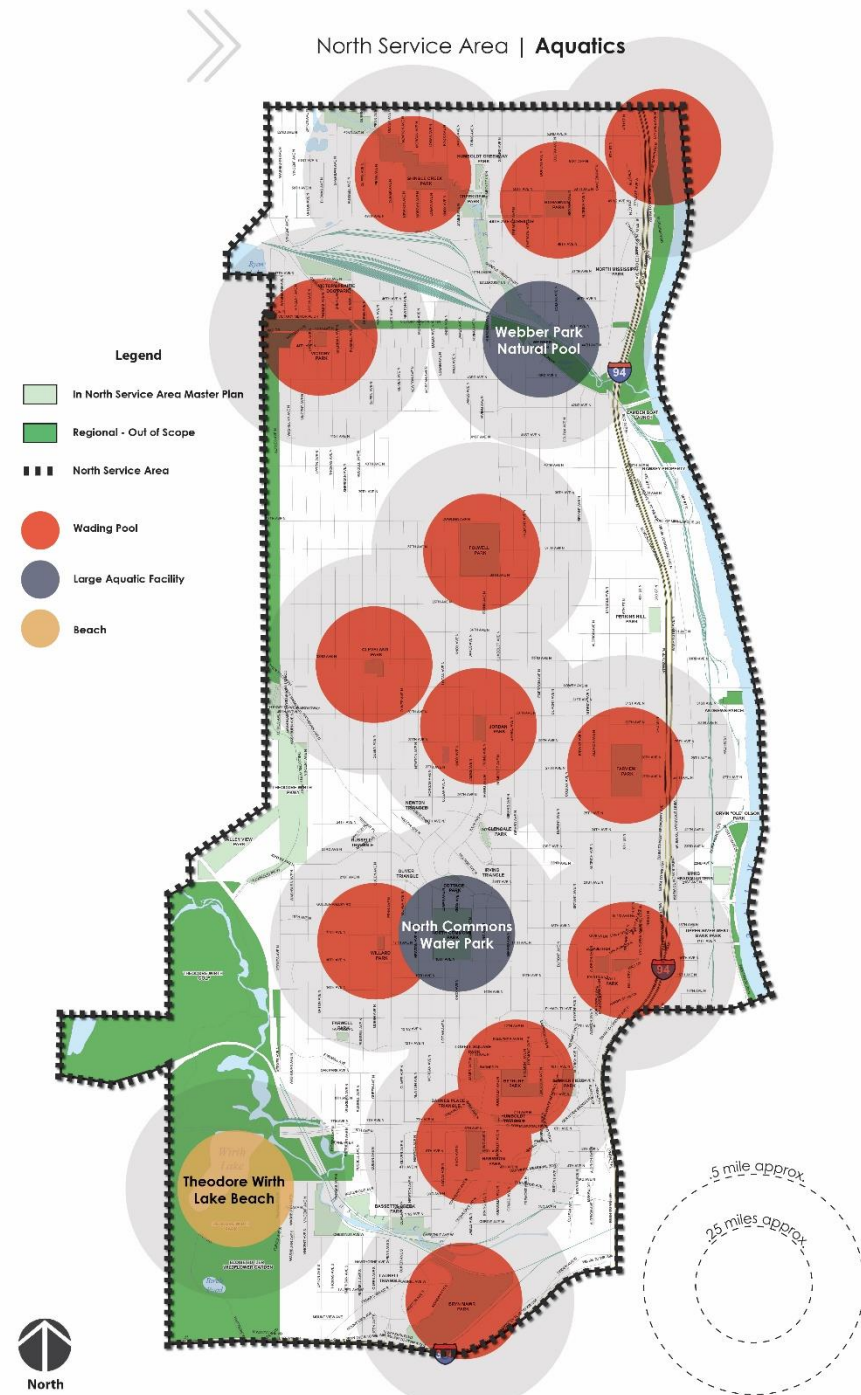

# 4

## Aquatics

### Wading Pool vs. Splash Pad

- Wading Pools are typical for MPRB
- 0'-2' max depth (accessible entry)
- 30x50' typ. Size
- Users tend to be younger



### Splash Pad



# 4

## Aquatics

### Wading Pool vs. Splash Pad

- There are currently no splash pads in the NSA
- No standing water
- Size can vary
- Users tend to be from multiple age groups

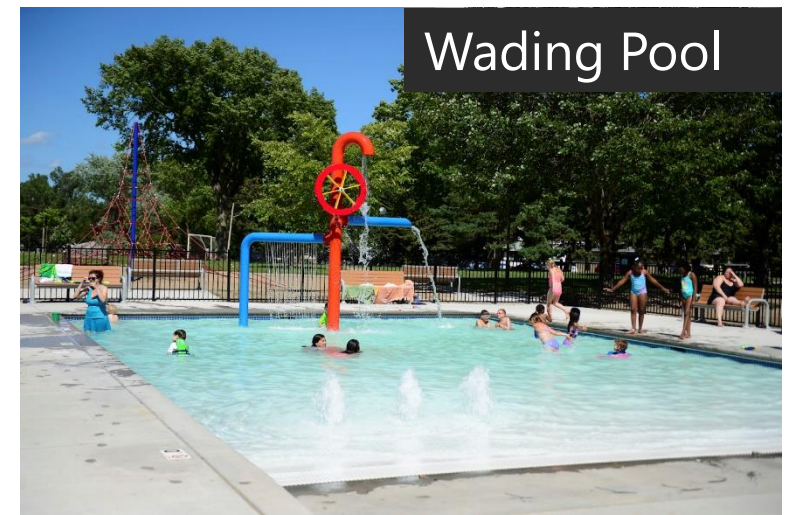



# 4

## Aquatics

Questions:

*Are the current aquatics facilities in the North Service Area serving the community?*

*Is there equitable access?*

*What would you change?*

# 4

## Universal Playground

### Definition



- A universal playground is a playground that incorporates special features to make it accessible to people with disabilities, while also supporting the activities of people without disabilities
- Only 1 currently exists in the MPRB @ Wabun Picnic Area

Question:

*Where would this type of facility best serve Northside residents?*

4

# "Big Moves"

Examples + Discussions

- North Commons
- Bryn Mawr
- Cleveland
- Creekview

## North Service Area Master Plan

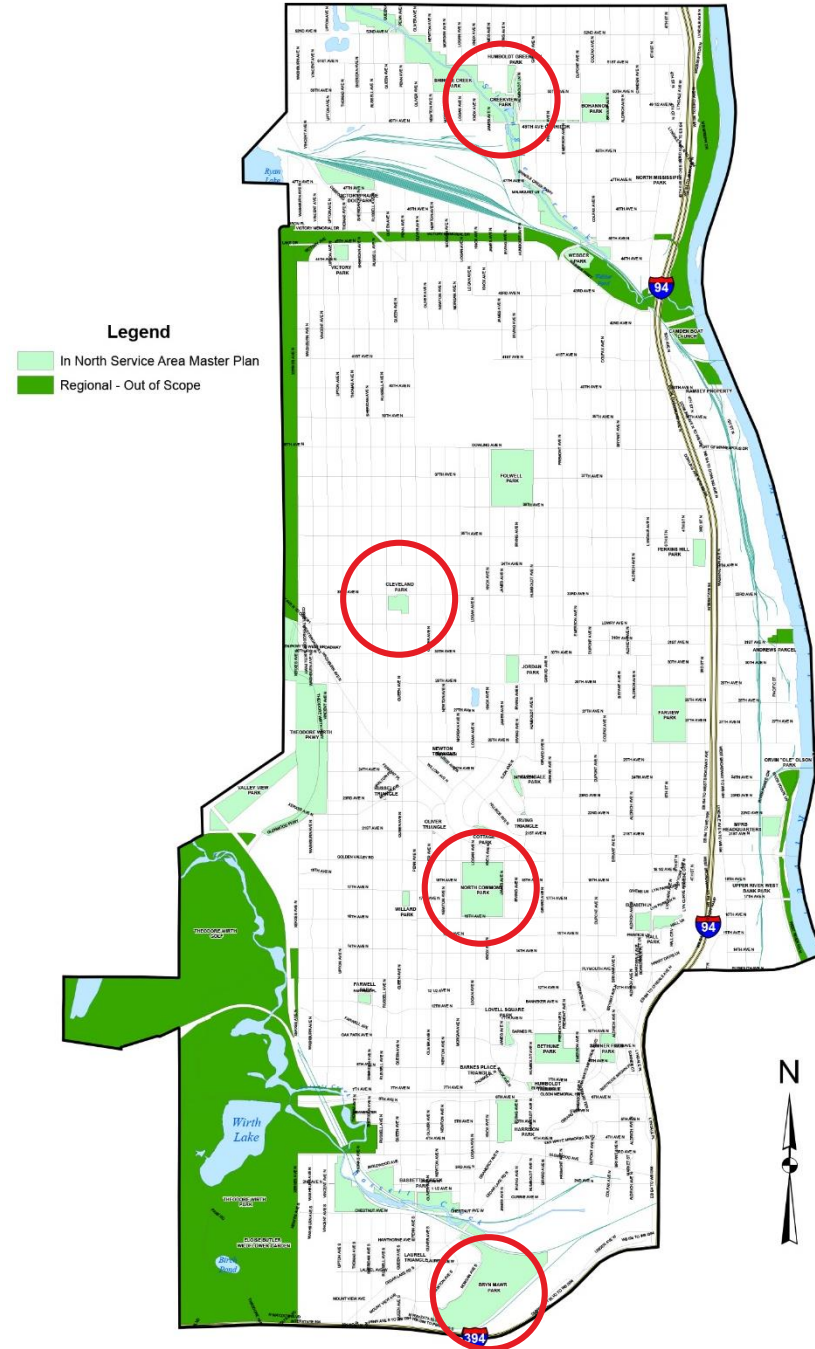

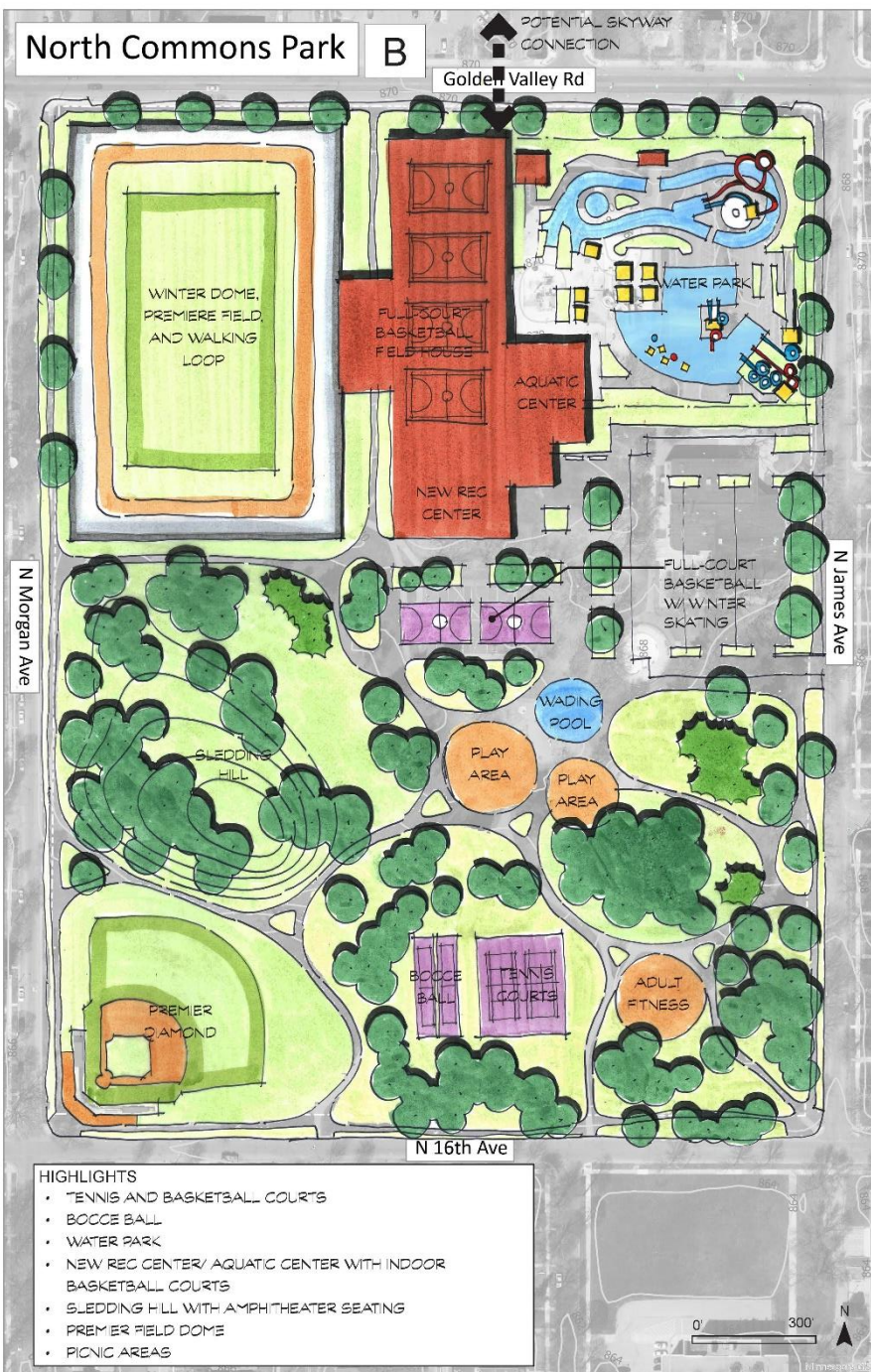

4

"Big Moves"

Examples + Discussions

## North Commons Park:

- Multi-Generational Community Center
- Seasonal Sports Dome
- Reconstructed Waterpark (Indoor?)
- Leading redevelopment of Broadway



4

“Big Moves”

Examples + Discussions

## Multi-Generational Community Center / Fieldhouse | North Commons

Examples (mentioned in Workgroup):

- Bloomington Activity Center
- Albertville Activity Center
- Woodbury HealthEast Sports Center
- Hopkins Lindberg Center





4

“Big Moves”

Examples + Discussions

## Seasonal Sports Dome | North Commons

- Examples:
- Augsburg College
  - UofM
  - Plymouth
  - Maple Grove
  - Seafoam Stadium, Concordia

Current Facility



4

“Big Moves”

Examples + Discussions

## Reconstructed Waterpark | North Commons

Example: Big Splash Indoor Water Park, Indiana





4

“Big Moves”

Examples + Discussions

## Redevelopment on Broadway/Golden Valley Road | North Commons

# 4

## "Big Moves"

### Examples + Discussions

### Indoor/Outdoor Conservatory Building | Bryn Mawr



# 4

## "Big Moves"

Examples + Discussions

### Indoor/Outdoor Conservatory Building | Bryn Mawr

Examples:

- Como Conservatory
- **Cowles at the Walker (removed)**
- Milwaukee's Mitchell Park Domes



Creekview Park + Humboldt Greenway

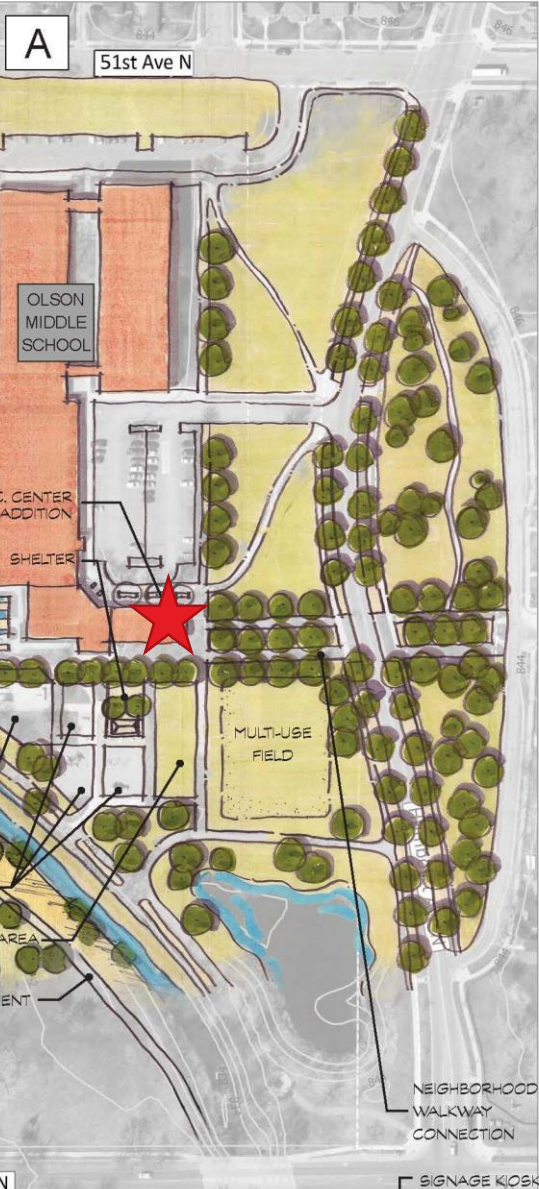

- HIGHLIGHTS**
- REC. CENTER ADDITION/ COFFEE PARTNERSHIP OPPORTUNITY
  - CONVERT 1 DIAMOND TO MULTI-USE FIELD
  - LAWN GAMES AREA
  - NEIGHBORHOOD WALKWAY CONNECTIONS
  - ART BRIDGE AND STREAM ENHANCEMENTS
  - INCREASED VISIBILITY SIGHTLINES
  - LARGER CRICKET/ MULTI-USE FIELD
  - EXISTING PLAYGROUNDS PRESERVED
  - HIGHLY VISIBLE BASKETBALL COURT

4

“Big Moves”

Examples + Discussions

★ Café/Coffee @ Rec Center | Creekview



4

"Big Moves"

Examples + Discussions

## Café/Coffee @ Rec Center | Creekview

Examples:

- Harriet - Bread and Pickles
- Silverwood Park - Coffee Shop



# 4

## "Big Moves"

Examples + Discussions

### Cleveland Surrounding Redevelopment

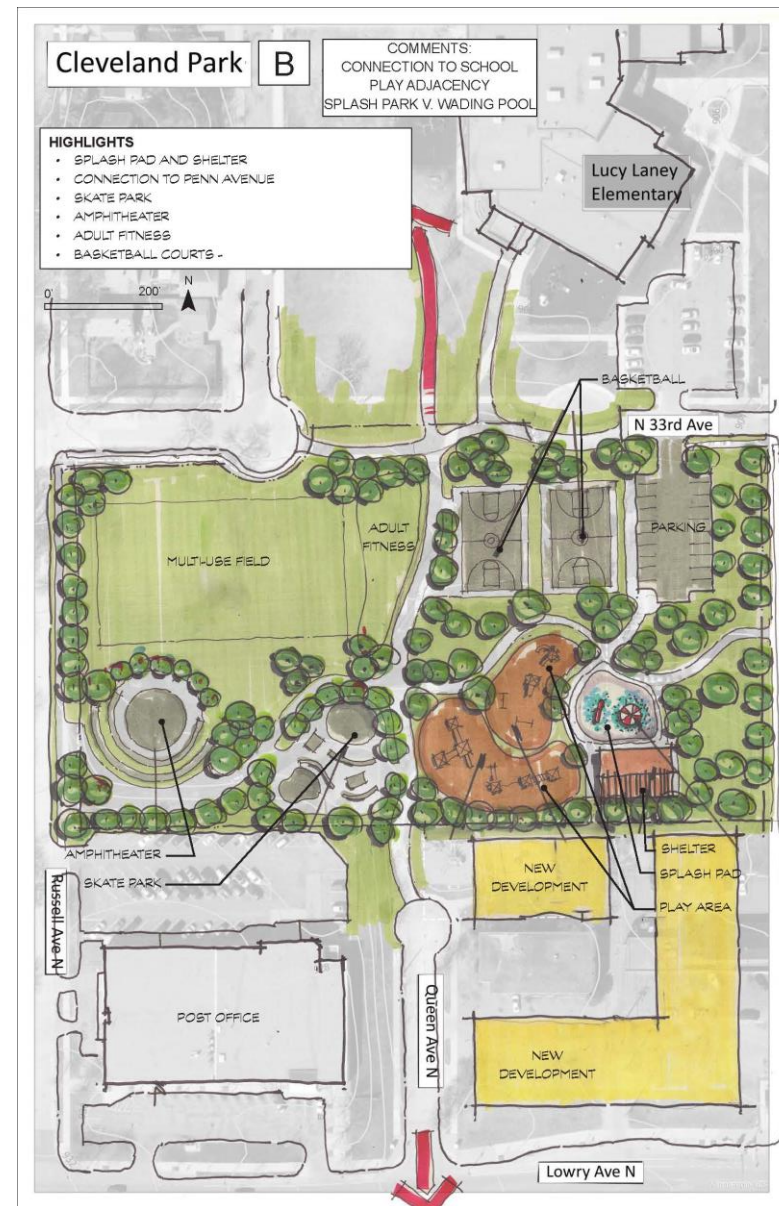
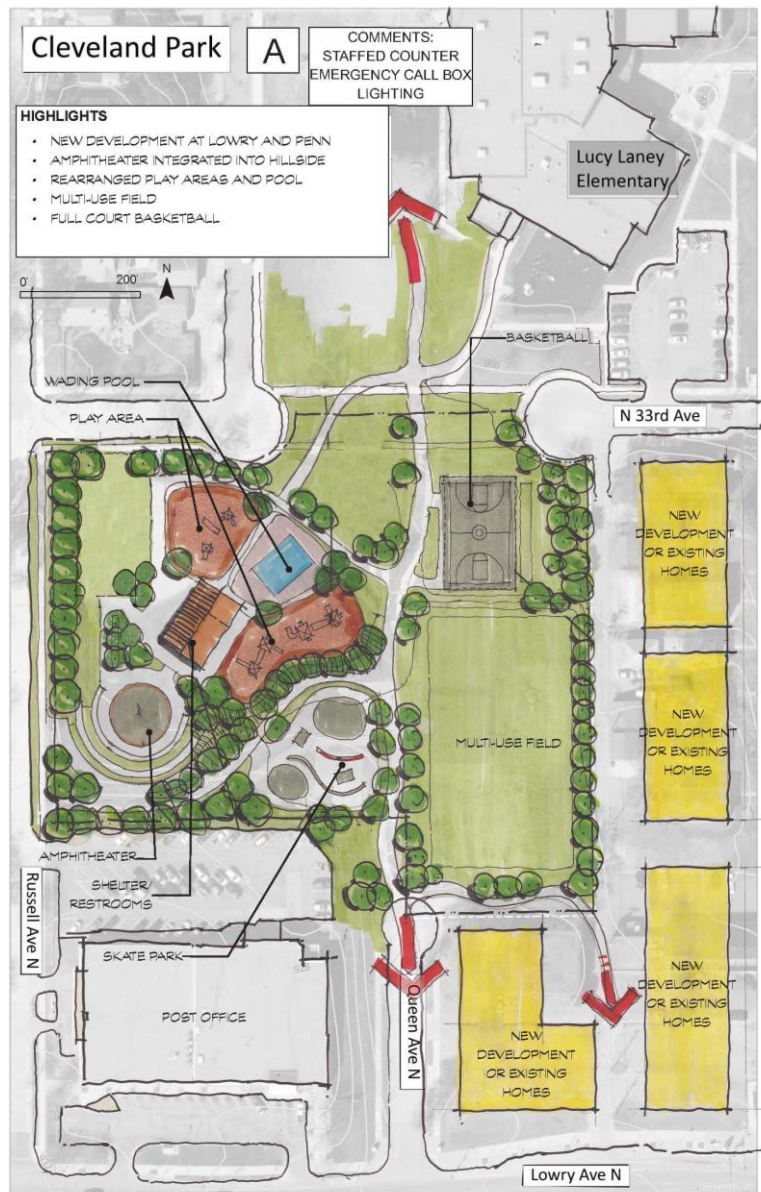

# 4

## "Big Moves"

### Examples + Discussions

North Commons, Bryn Mawr, Cleveland, Creekview

#### Questions:

*Are facilities of this magnitude worth having and paying for in North?*

*Are all four big moves warranted, or should we be more targeted?*

*Are there pieces of these that are the role of other agencies, like city redevelopment?*

*Others???*

### North Service Area Master Plan

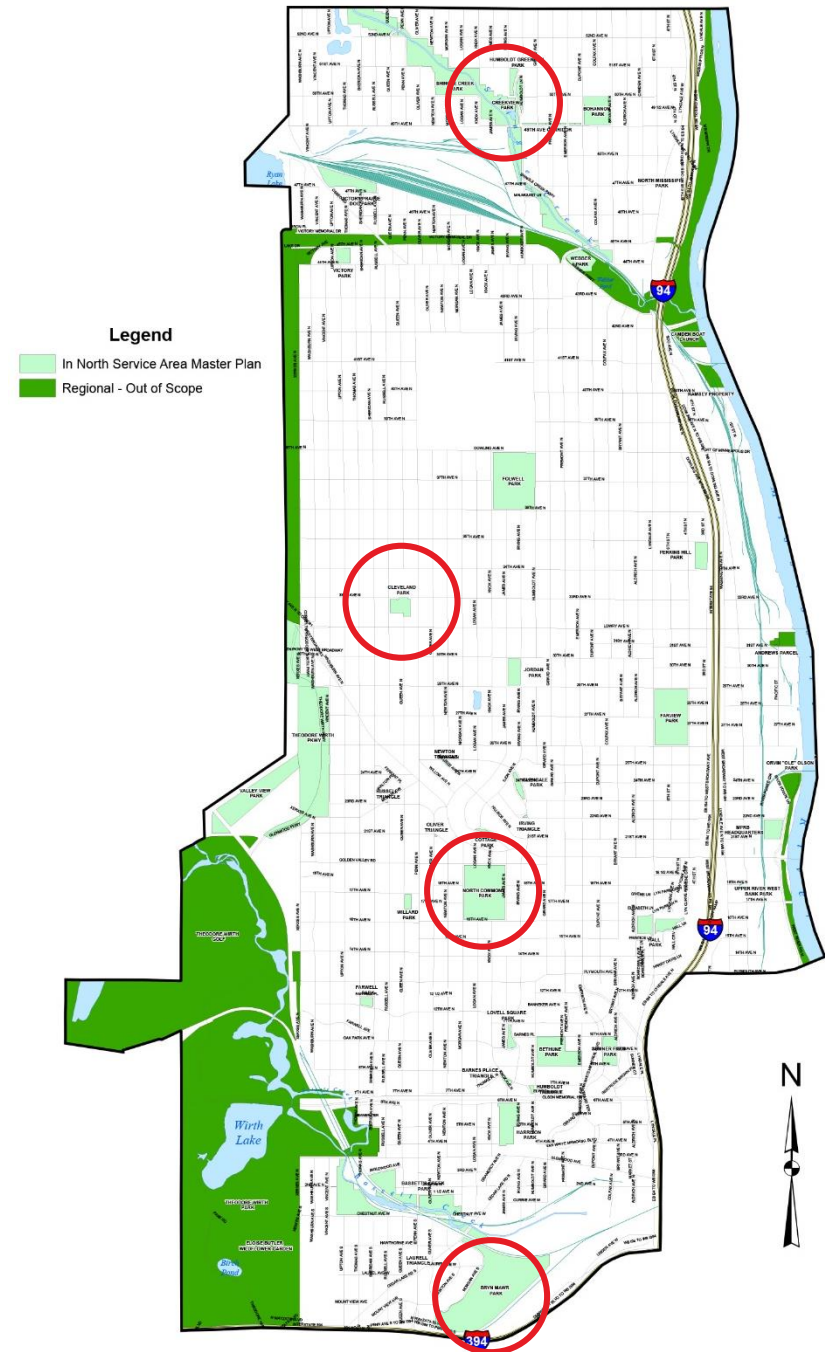

Legend

- In North Service Area Master Plan
- Regional - Out of Scope
- North Service Area
- Play Area

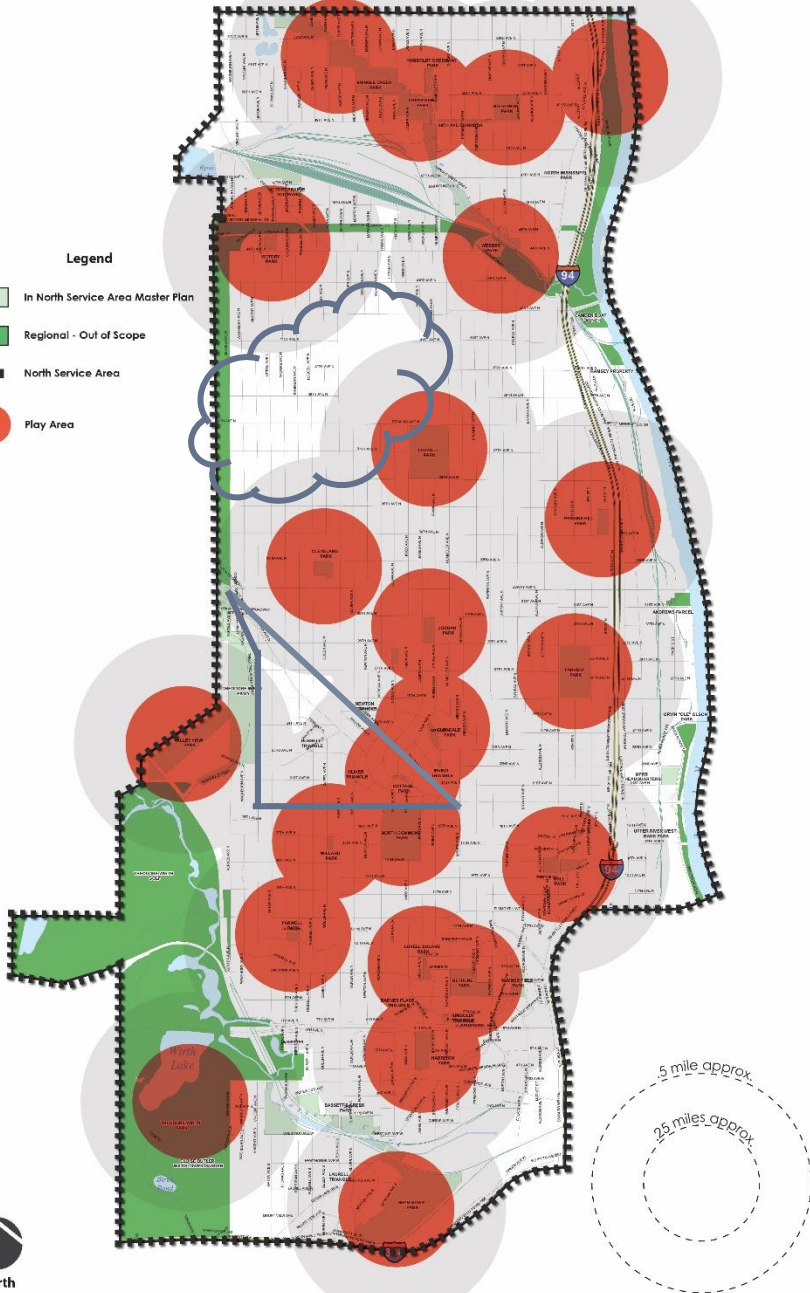

5

# Service Gaps

Examples + Discussions



**Playground Service Gap | Russell Triangle**



**Park Service Gap | Northwestern area**

# Design Phase Timeline

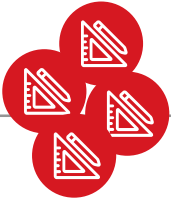

## COMMUNITY WORKSHOPS

Review initial concepts.  
Gather input from neighbors and community members to work towards a preferred concept

## PREFERRED CONCEPT DEVELOPMENT

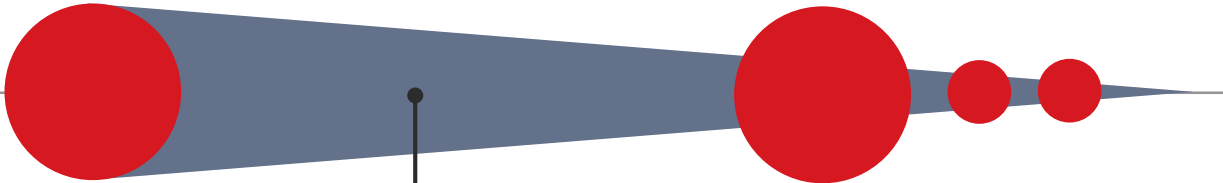

**CAC #6**  
Big Ideas.  
Guiding Principles.

**CAC #7+**  
CAC approval.  
(may take several meetings)

**WORK GROUP MEETINGS**  
**AGENCY COORDINATION**  
**MPRB STAFF COORDINATION**

## ONLINE PUBLIC COMMENT PERIOD

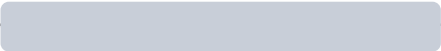

**BOARD APPROVAL**  
Board approves CAC recommended plans

# Next Steps

**T.B.D. | CAC #7**

*likely mid-May*

[www.minneapolisparcs.org](http://www.minneapolisparcs.org)  
search for North Service Area  
Master Plan`

## MPRB Contacts:

Colleen O'Dell, Project Planner

612-230-6469

[codell@minneapolisparcs.org](mailto:codell@minneapolisparcs.org)

Adam Arvidson, Director of Strategic Planning

612-230-6470

[aarvidson@minneapolisparcs.org](mailto:aarvidson@minneapolisparcs.org)

Thank **YOU**