

# Final Design Concept | 3D Site Overall Perspective



**CENTRAL GYM SKATE PARK**  
MINNEAPOLIS, MN  
OCTOBER 2024



# Final Design Concept | 3D Perspectives



Birds Eye View - Northeast



Birds Eye View - Southwest



Birds Eye View - Southwest







Birds Eye View - West

# Final Design Concept | Design Narrative & Site Plan

The revised concept design is a product of the feedback input that was received from previous in-person meetings and online surveys. This design includes street style lanes, featuring ledges, rails, and hips. This area is beginner friendly with comfortable sized features that allow opportunity for learning and progression. Another highlight of this design is the designated bowl area. This transitional terrain fulfills the requests heard from many participants at the open house.

## Legend

-  Pedestrian Circulation
-  Rider Circulation
-  New Fence Line
-  Staging Area
-  Rules Sign

- ① Skatepark Entry Point & Signage
- ② Skatepark - Ledges and Flat Bar
- ③ Skatepark - Downrail
- ④ Skatepark - Spectator Viewing Area
- ⑤ Skatepark - Bowl / Halfpipe
- ⑥ Existing Playground
- ⑦ Existing Basketball Courts
- ⑧ Existing Elementary School
- ⑨ Preserved Landscape

Skatepark features are schematic and will be modified based on community input, project budget and geotechnical findings. The current design is schematic to represent the intended terrain style within the project scope.

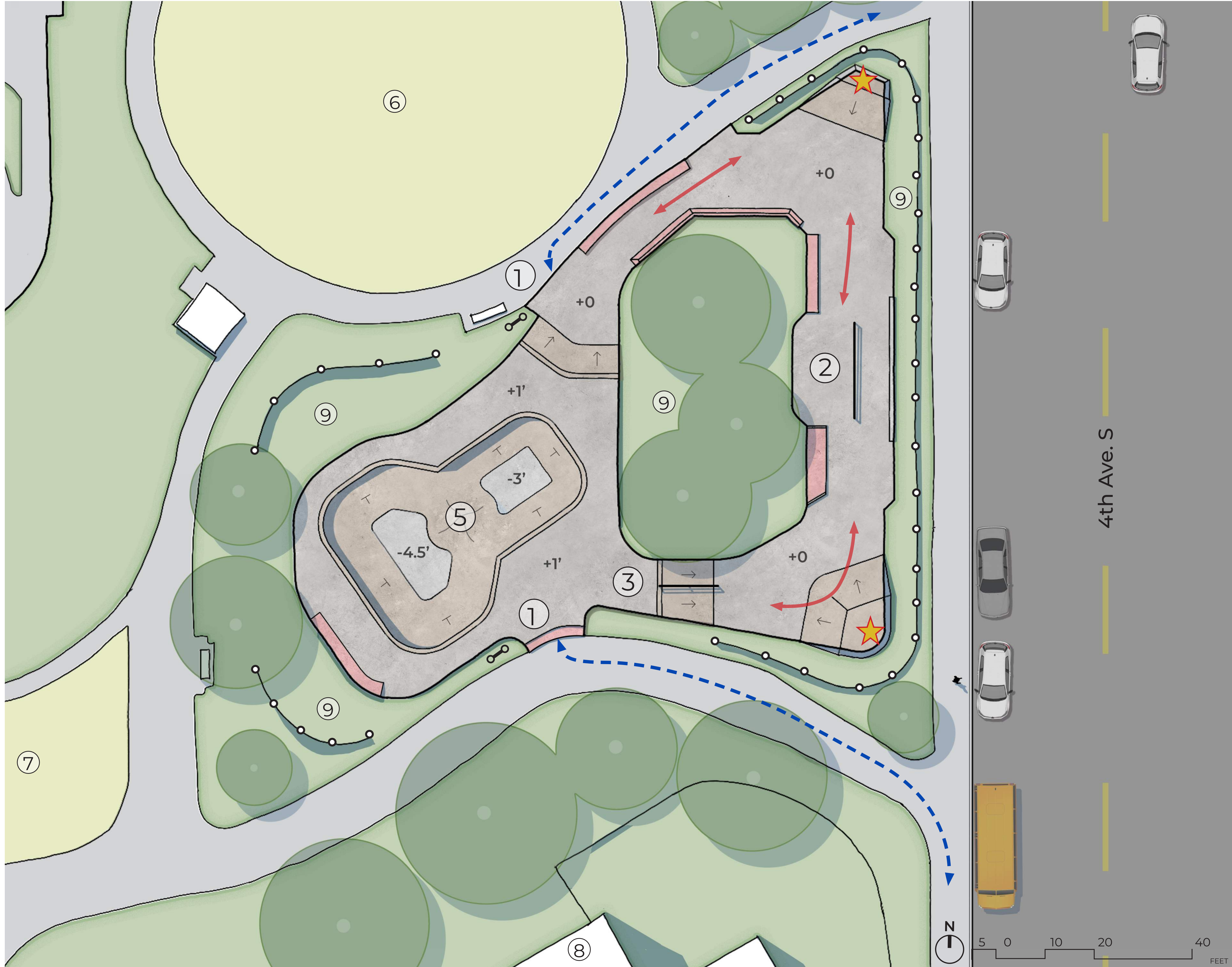

# Design Development | Artistic Element Concepts

## SITE PLAN

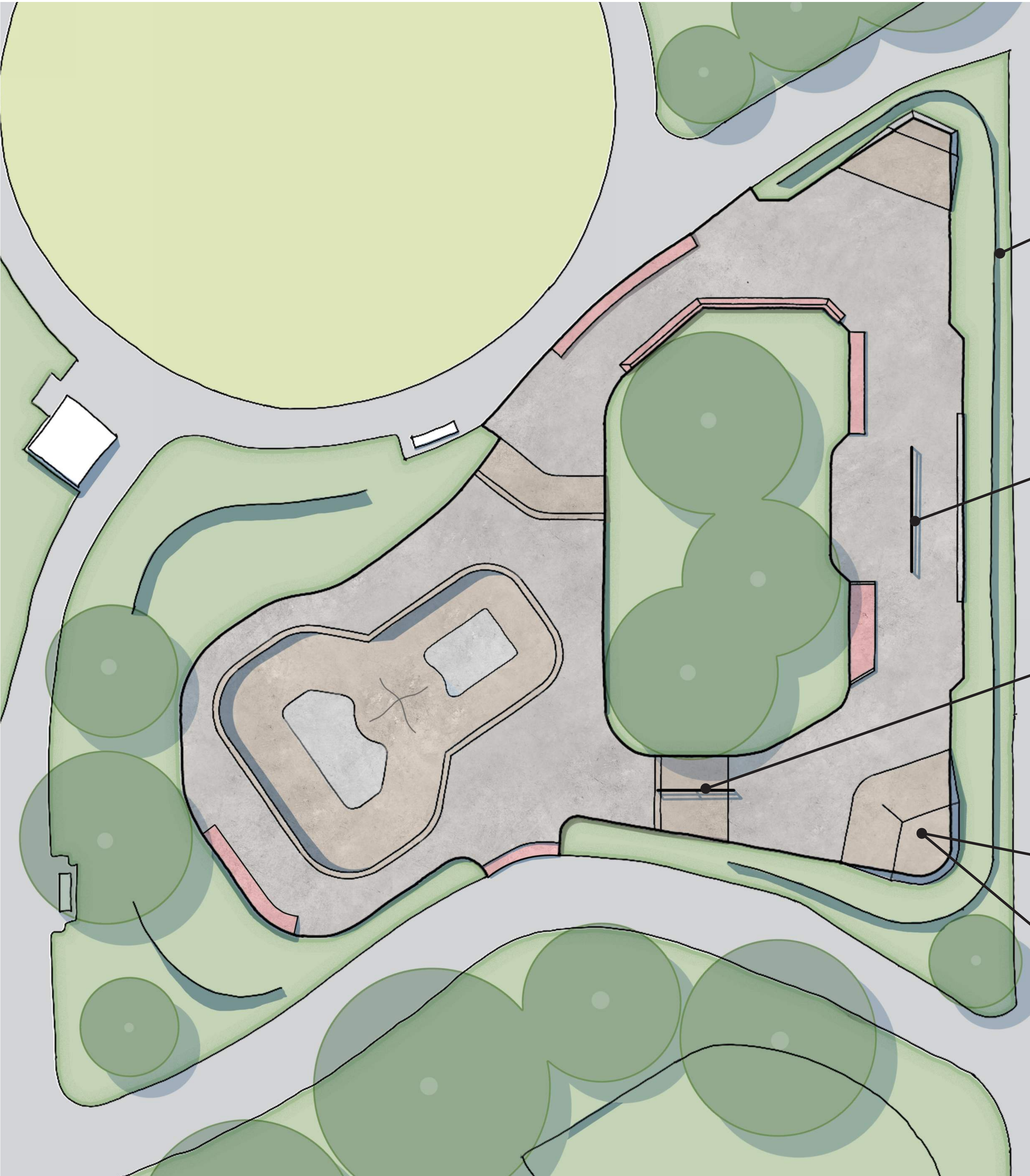

## OPPORTUNITY FOR ARTISTIC ELEMENT

\*NOTE: ALL FEATURES ARE CONCEPTUAL AND NOT INTENDED TO REPRESENT FINAL DESIGN

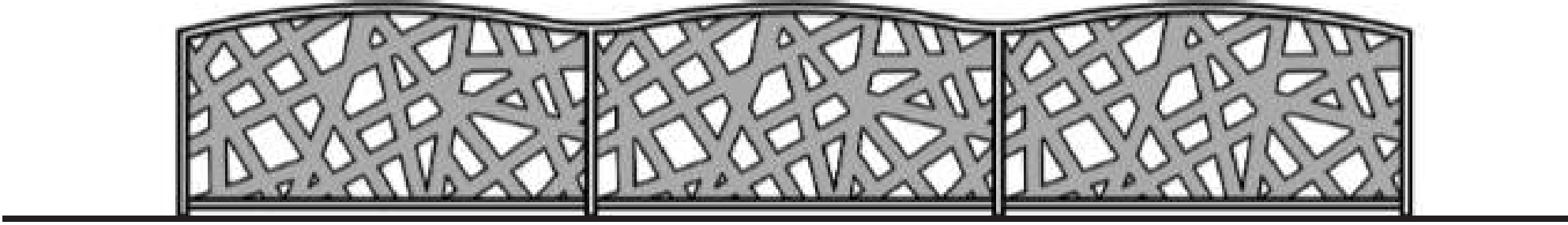

Fencing / Guardrail



Flat Rail

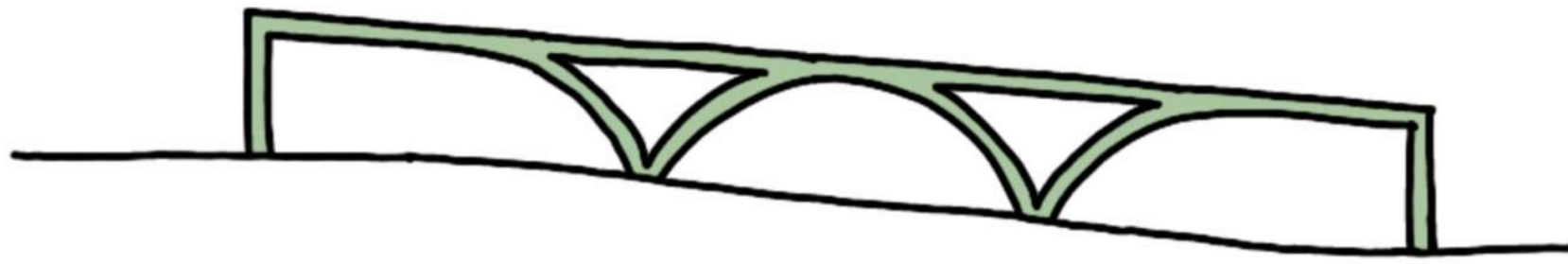

Down Rail



Bank Profile - Etched Facade

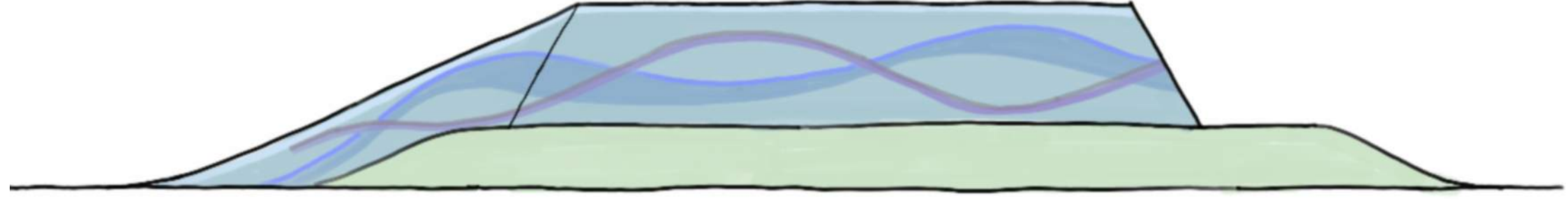

Bank Profile - Mural Facade

# Design Development | Artist Opportunity

## APPROACH

The intent of design is to integrate the skatepark into the Central Gym park environment and community. Artistic features incorporated into the skatepark allow users to understand the culture and identity of this community and see themselves represented.

Being located next to Richard R Green Elementary School, Central Gym Park holds a strong opportunity to inspire the local youth.

The Minneapolis Park and Recreation Board (MPRB) will work with a selected local public artist(s) on integrating artistic elements that are culturally relevant and meaningful to the community as part of MPRB's public art policy.

## PRECEDENT ELEMENTS



## CONCEPTUAL FEATURE INTEGRATION



# Project Development | Tree Preservation

## TREE PRESERVATION PLAN



### NARRATIVE

The intent behind the tree preservation approach is to maintain the park's existing microclimate. The trees will allow shade opportunity for both riders and spectators of the skatepark.

### LEGEND

- High Priority Tree Preservation
- Intermediate Priority Tree Preservation
- Low Priority Tree Preservation
- Trees to be Preserved
- ✗ Trees to be Removed

### TREE BENEFITS

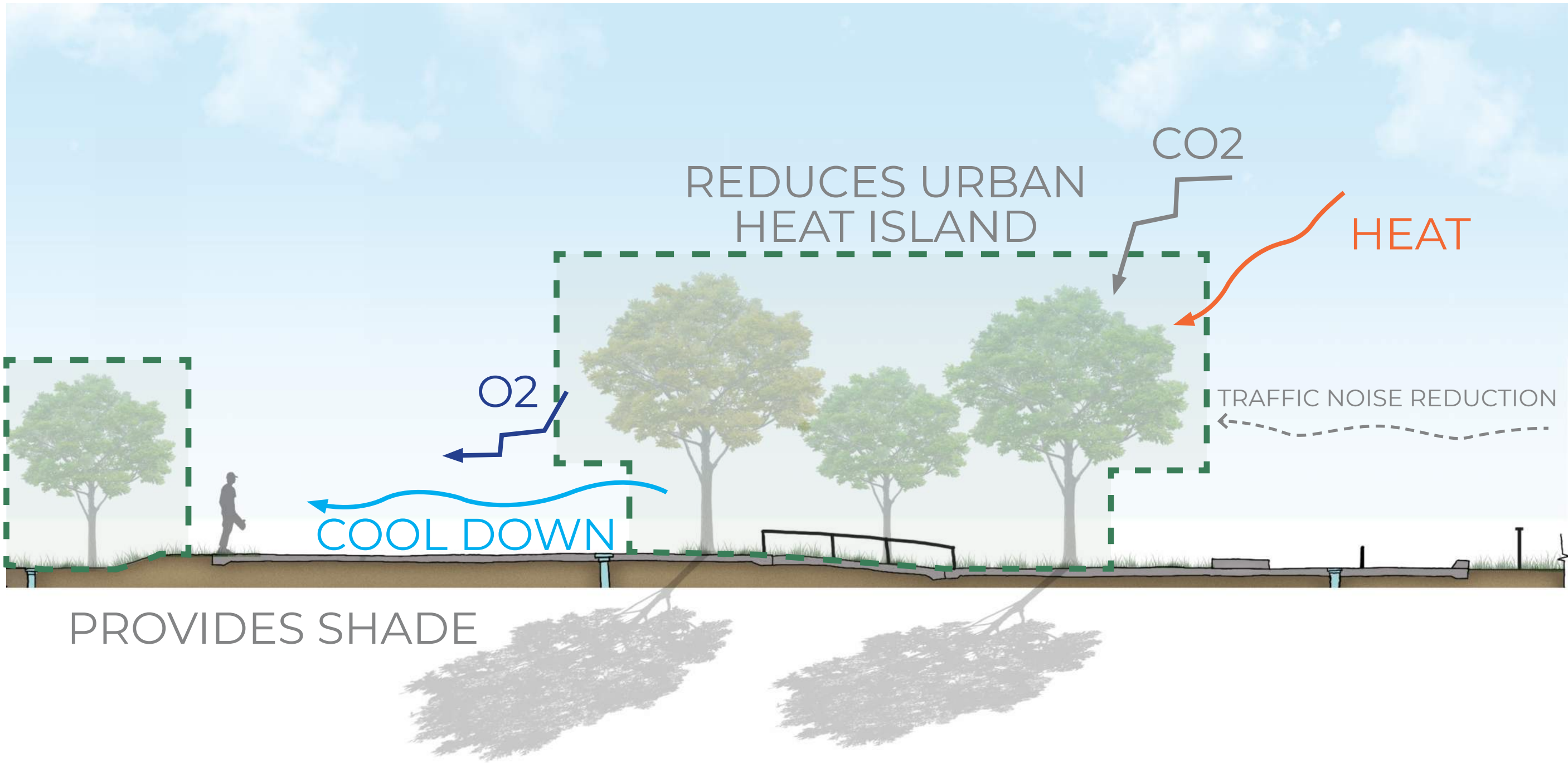

# Design Development | Site Approach

## SCHEMATIC DRAINAGE PLAN

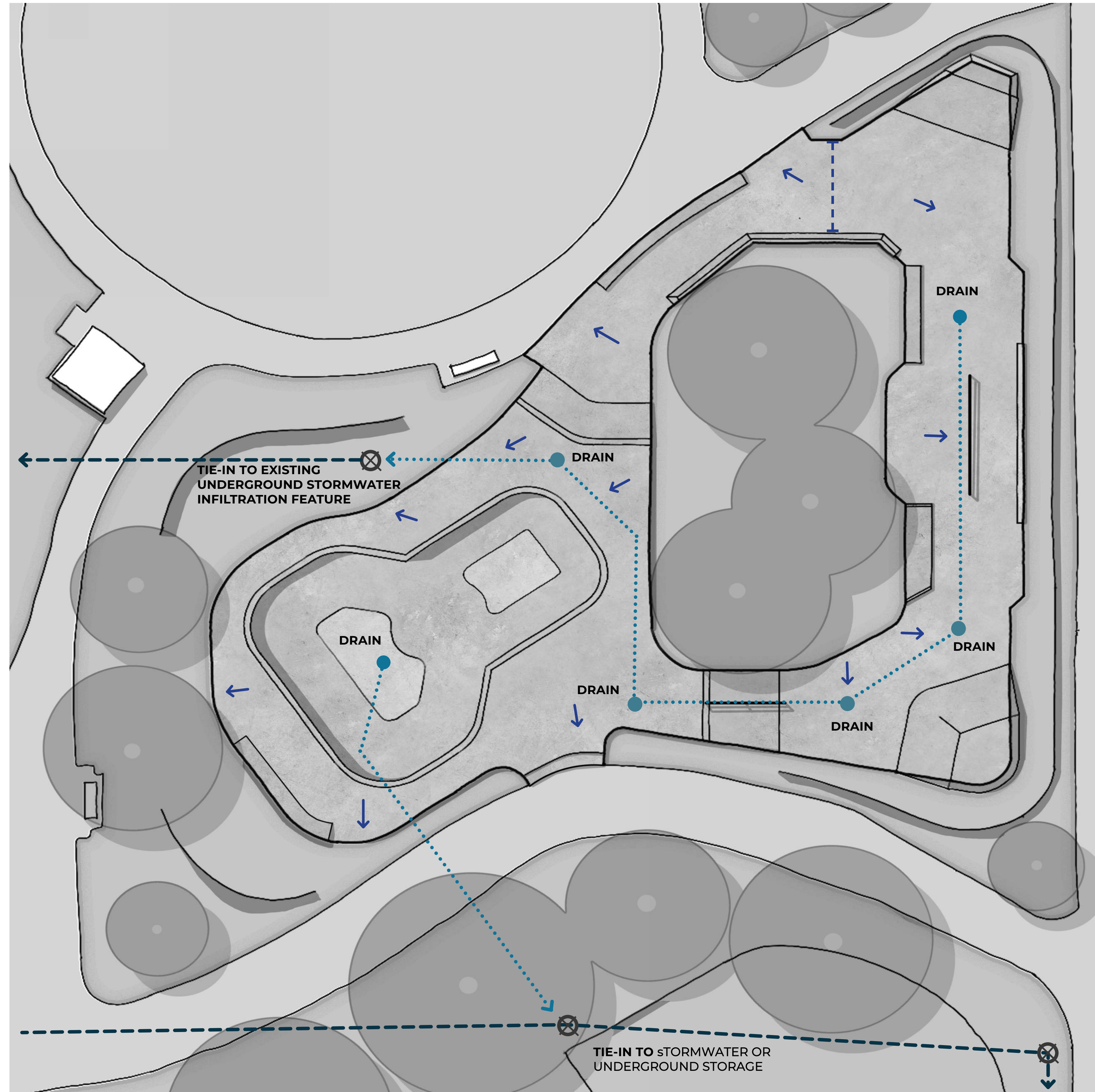

### LEGEND

- Existing Storm Drain Line
- New Drain Line
- Surface Drainage Flow
- Surface Drainage Ridgeline

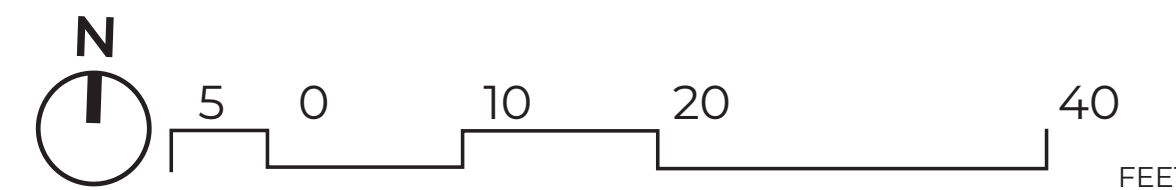

## SCHEMATIC DRAINAGE SECTION DRAWINGS

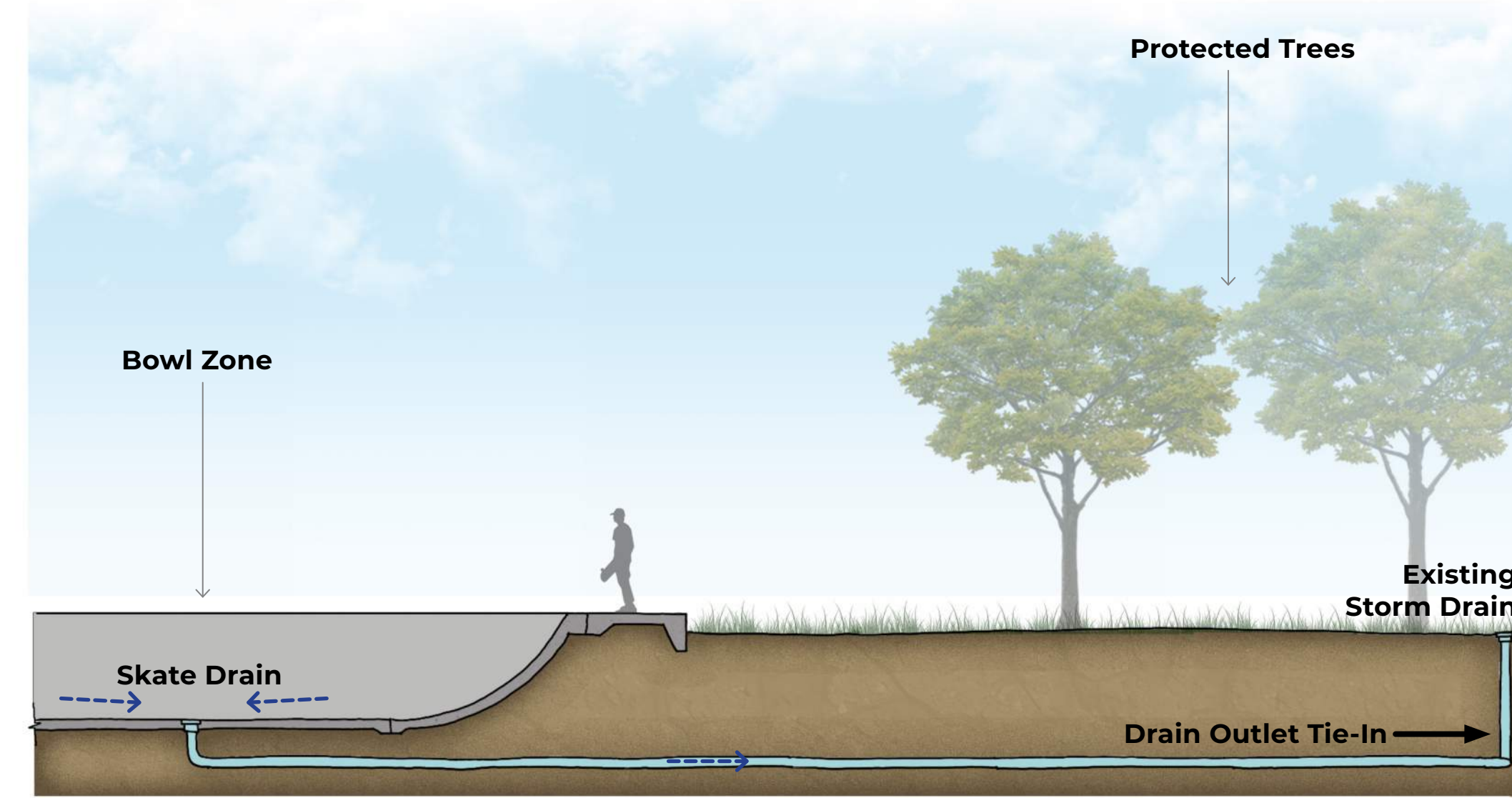

DRAINLINE 1 CONCEPT

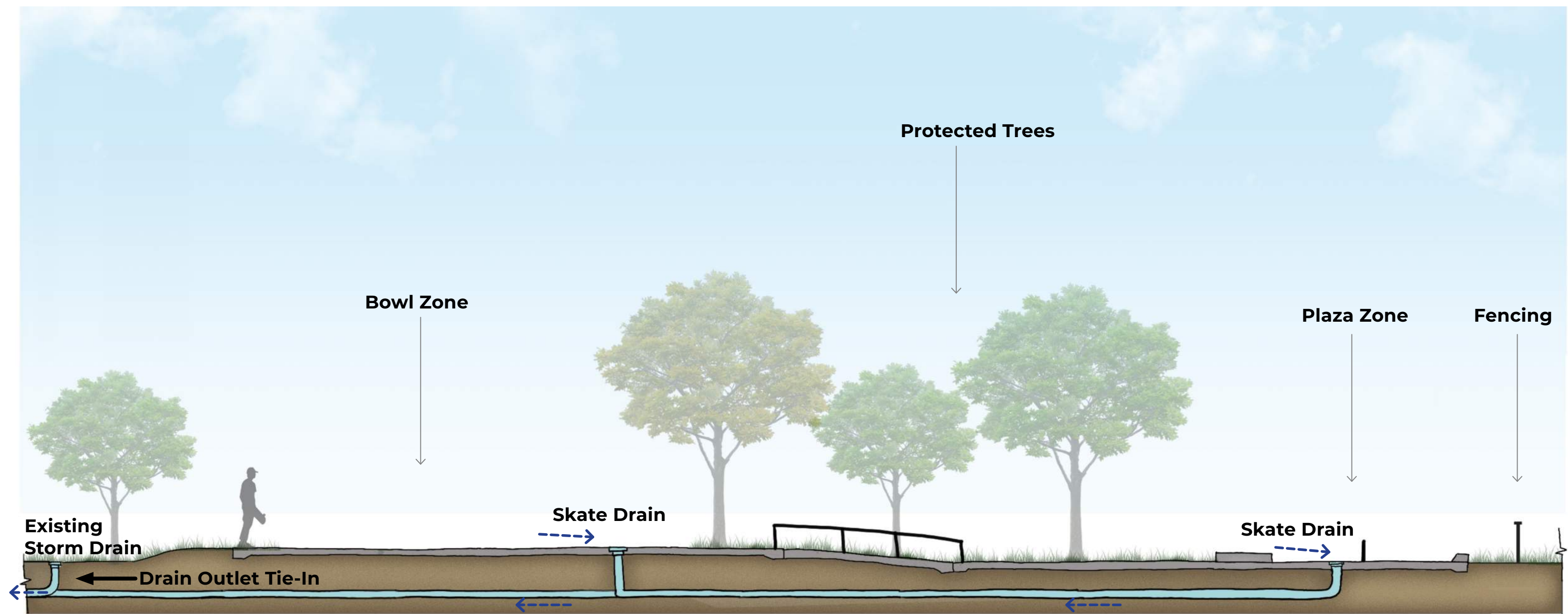

DRAINLINE 2 CONCEPT

# Project Development | Schedule

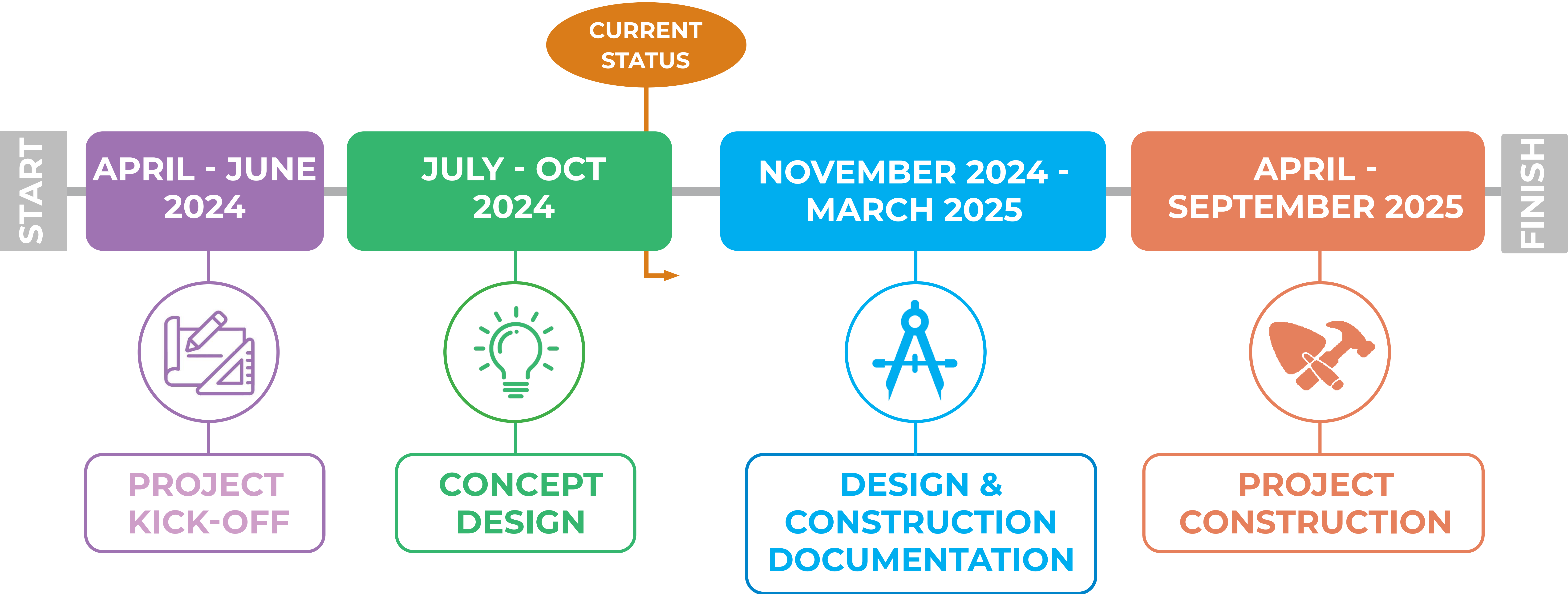

# Project Development | Information & Background

Central Gym Park Plan approved by Board in 2017 and in the South Service Area Master Plan



- Project List:**
- 1 Multi-sport Athletic Turf Play Field
  - 2 Full Court Basketball
  - 3 Updated Wading Pool and Splash Pad
  - 4 Playground with modern and natural features
  - 5 Skate Park
  - 6 Safe Path for Bikes
  - 7 Urban Agriculture
  - 8 Updated Restrooms
  - 9 Group Picnic Shelter
  - 10 Community Gathering Space
  - 11 Multi- Use Sport Court

**Background**

This project will implement a second phase of the improvements identified and envisioned by the South Service Area Master Plan adopted by MPRB in fall of 2016 which includes a master plan for Central Gym Park. The scope of this phase will focus on implementing the skate park. The skate park concept plan was approved by the Board in 2017 as part of the first phase of improvements that included a new playground, basketball and field improvements. The existing restroom building will be improved in 2024 as a separate project.

**Site Boundaries & Potential**

Project funding for this phase of work sources include NPP20, Park Dedication and from the Hennepin County Youth Activity Grant. The total available for design and construction is \$1,009,000.

**Project Team**

The Minneapolis Park and Recreation Board  
 Crystal Passi, Project Manager [cpassi@minneapolisparcs.org](mailto:cpassi@minneapolisparcs.org)  
 New Line Skate parks  
 Kanten Russell, Director of Design | [kanten@newlineskateparks.com](mailto:kanten@newlineskateparks.com)  
 Aric Sanders, Design Project Manager | [aric@newlineskateparks.com](mailto:aric@newlineskateparks.com)  
 Chris Long, Civil Designer | [chrisl@newlineskateparks.com](mailto:chrisl@newlineskateparks.com)

**Timeline**

Spring & Summer 2024 - Community Engagement & Design  
 Fall 2024 -Design  
 Winter 2024 -Bidding  
 Spring-Fall 2025 Anticipated Construction



**PROJECT PAGE**

Check out the Project Web Page to Take the Online Survey  
<https://www.minneapolisparcs.org/central-gym-park-skate-park/>

# Project Development | Analysis & Understanding

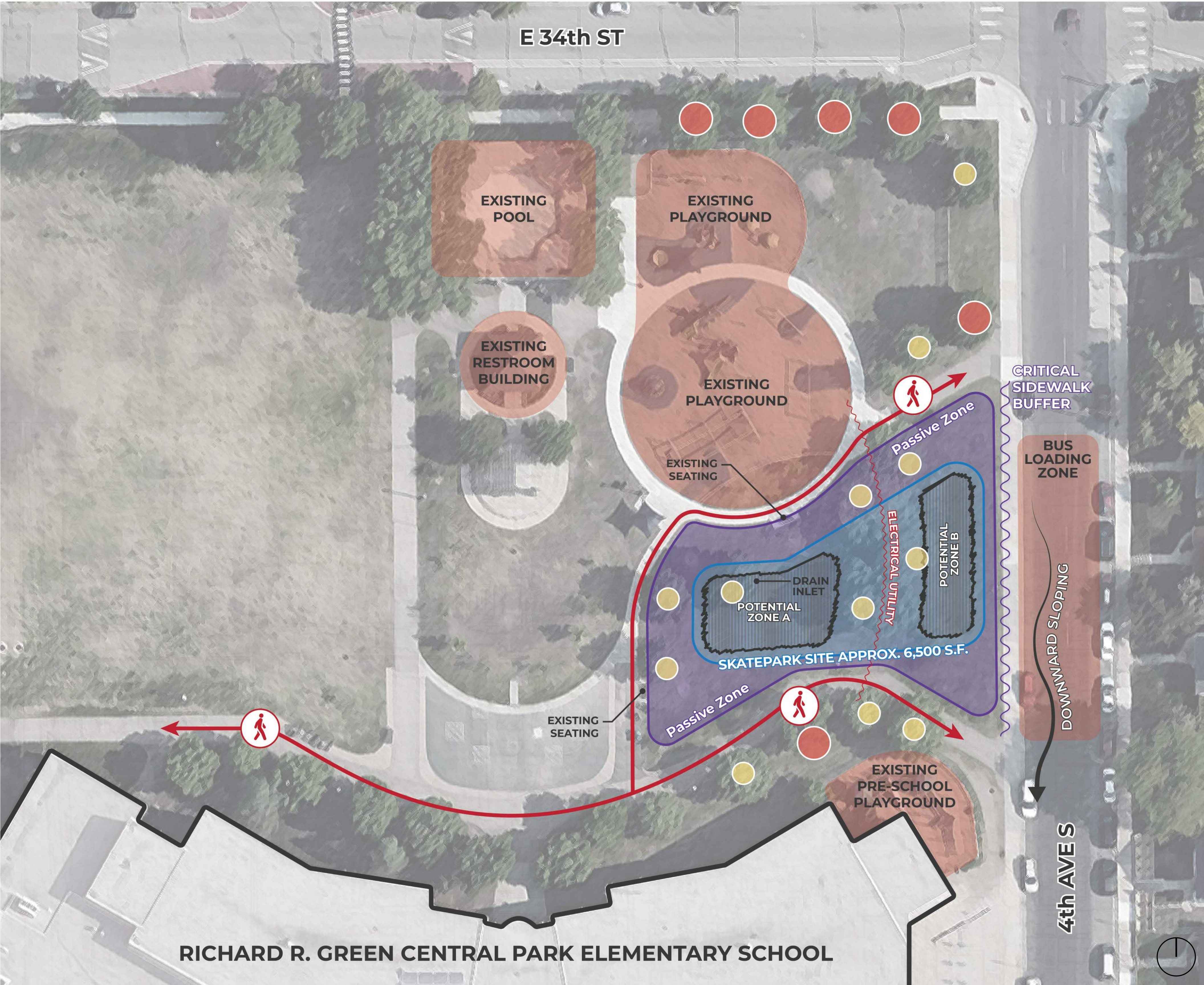

## PROJECT NOTES & ASSUMPTIONS:

The following constraints and opportunities have been identified through out initial site analysis and require additional coordination and clarification to aid design:

### A Public Input and Preservation Goals

Tree removal and replacement to be determined based on the Central Gym Tree Preservation Priority report and the concept design direction. Concept design will be driven by community input and site constraints with consideration to the highest priority trees.



### B Site Boundaries & Potential

Buffer space between Roadway sidewalk and other site amenities shall be highly considered to create a safe and comfortable environment for both users and community members in the proximity of the skate park.

### C Design Flexibility & Integration

Existing park amenities such as pedestrian pathways, drainage utilities, seating benches, trees and existing shade structures shall be maintained/modified as needed to compliment and support the skate park facility.

### D Site Terrain & Soil Suitability

Existing skate park site terrain is assumed to be relatively flat. Based on the site geotechnical report, it is assumed that the site soils are suitable and the contractor shall remove 1' of topsoil.

Proposed Skate park Location



Northern View

Proposed Skate park



Southern View

# Design Development | Input Meeting #1 Feedback

## Survey Summary

An online survey was conducted to give participants an opportunity to provide input on the design of the space entirely, including elements beyond the skatepark.

A total of **125 participants** completed the online survey. Data was collected about the following topics:

- User Demographics
- User Terrain Style & Feature Priorities
- Desired Site Amenities outside of Skatepark Terrain

Key highlights that were noted within the survey will be an asset in creating a welcoming and livable space for its active and passive users.

## Participants Demographics

Year of Birth				Zip Codes		
1980	1991	1979		55407	55412	55413
2004	2006	1992	1989	55408	55409	
2000	1989	1975	1987	55404	55419	

## Favored Skate Terrain Style

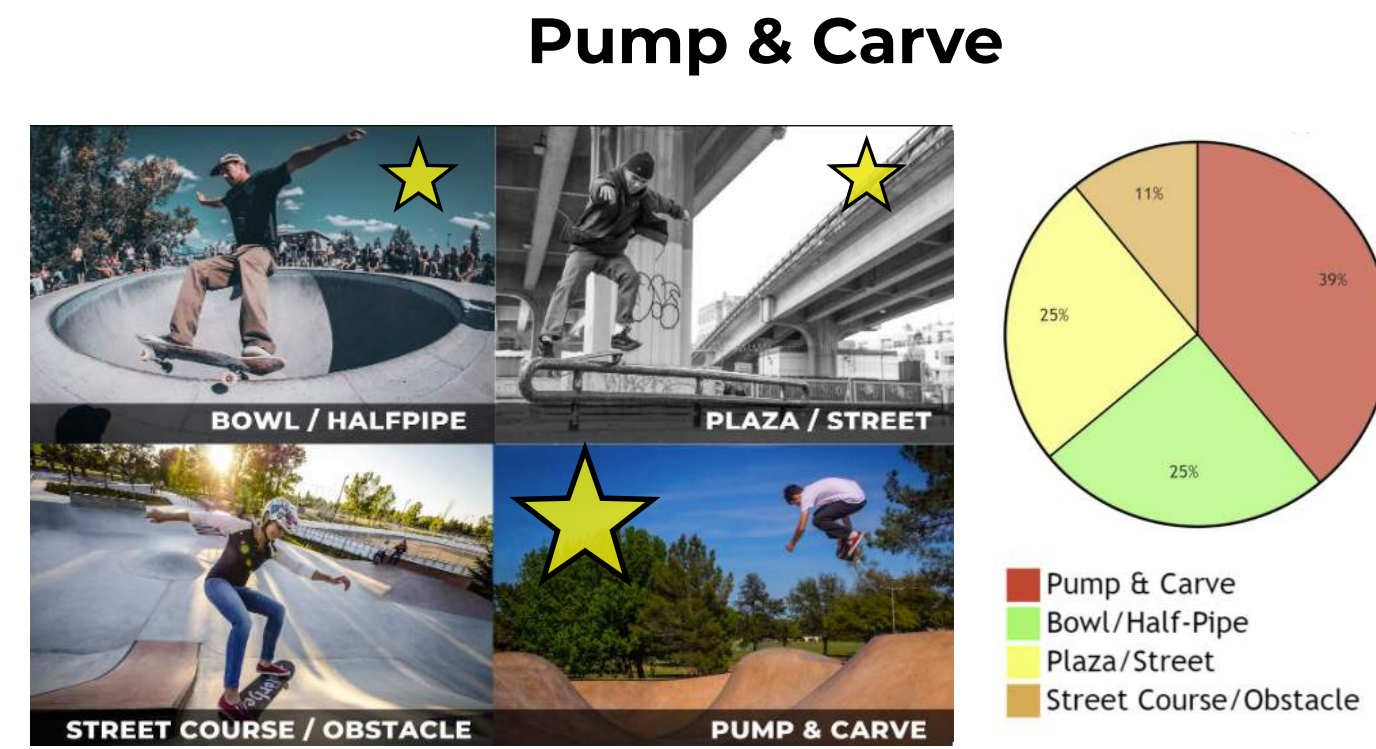

## Desired Site Amenities

- Shaded seating, benches, tables, water fountains
- Restrooms with trash bins
- English and Spanish Signage
- Lighting

## Top Priorities

- Integrate planting and landscape
  - Create safe corridors
  - Skateable art/sculpture
    - Spectator Seating
  - Community artwork murals
- Recognition of Indigenous heritage
  - English and Spanish Signage
  - Lighting for night skating

## Next Steps?

- Concept Development
- Further Community Feedback
- Finalize Design

## Dotmocracy Results

Online Participants voted on favorite feature in each skate element group

★ - Most favored feature

### QUARTERPIPES & MINI RAMPS

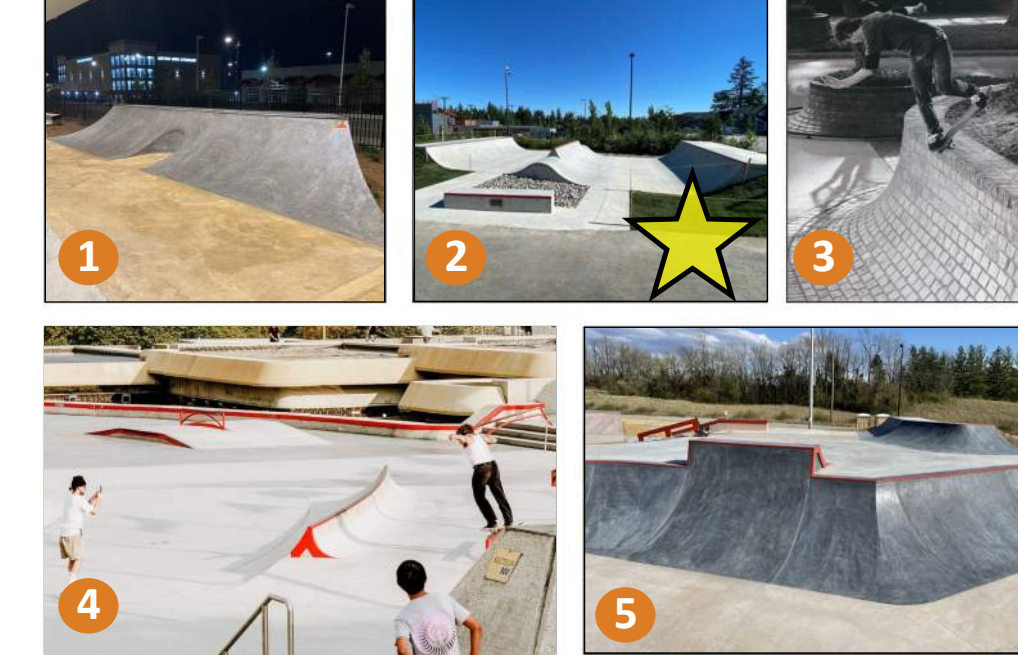

### BANKS

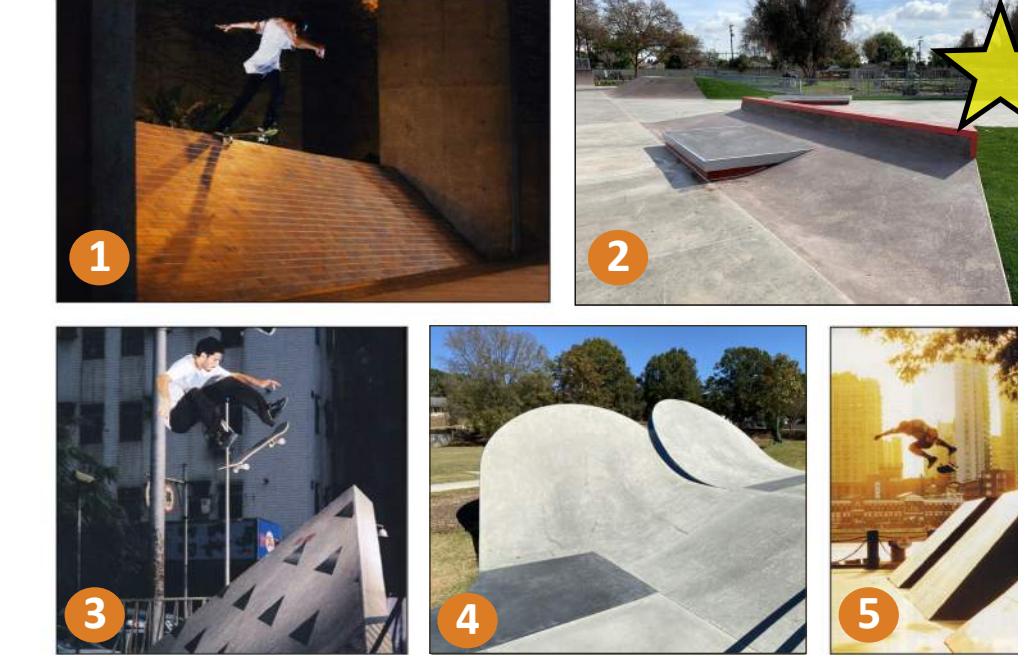

### HIP/PYRAMID



### SLAPPIES

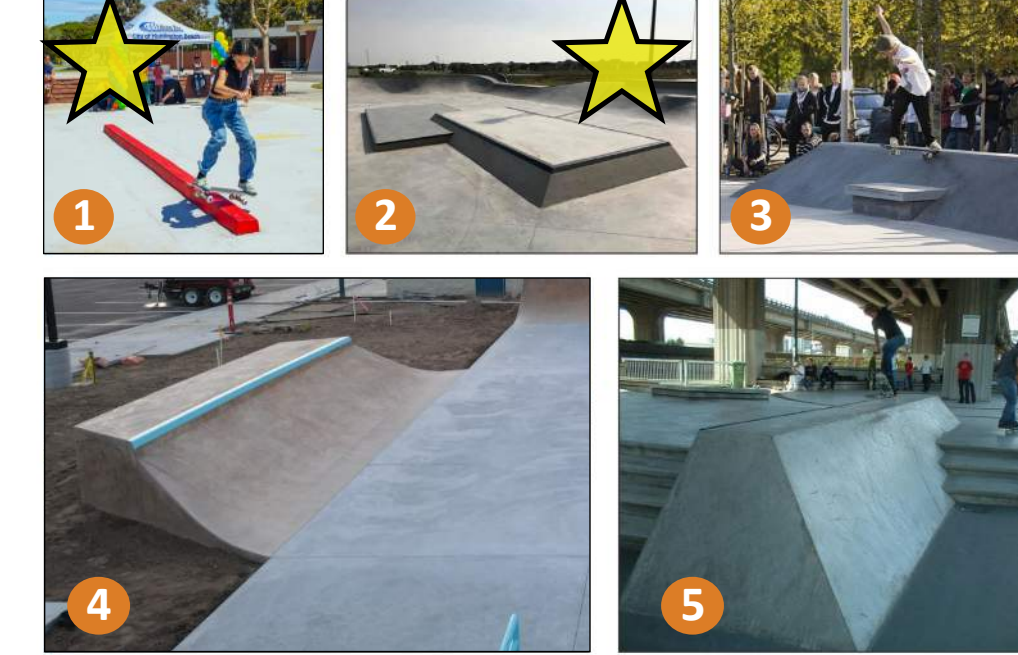

### FUNBOX FEATURES



### TRANSITION & FLOW



### STAIRS AND DROPS (WITH HUBBAS AND RAILS)



### RAILS



### LEDGES AND BENCHES



### GAPS

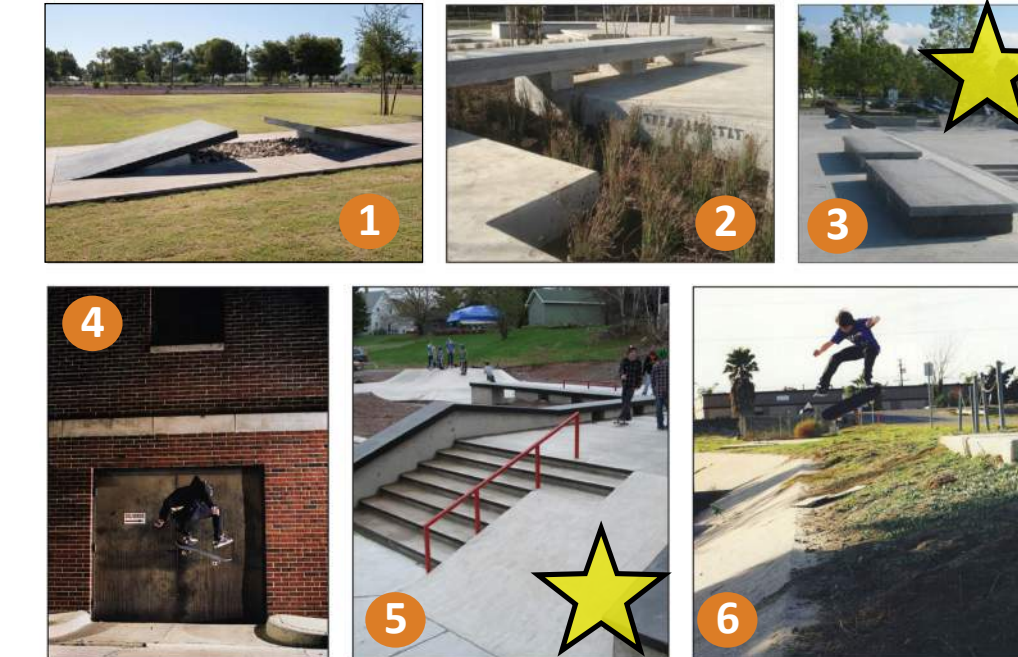

### MANUAL PADS



### CUSTOM SKATEABLE ART FEATURES

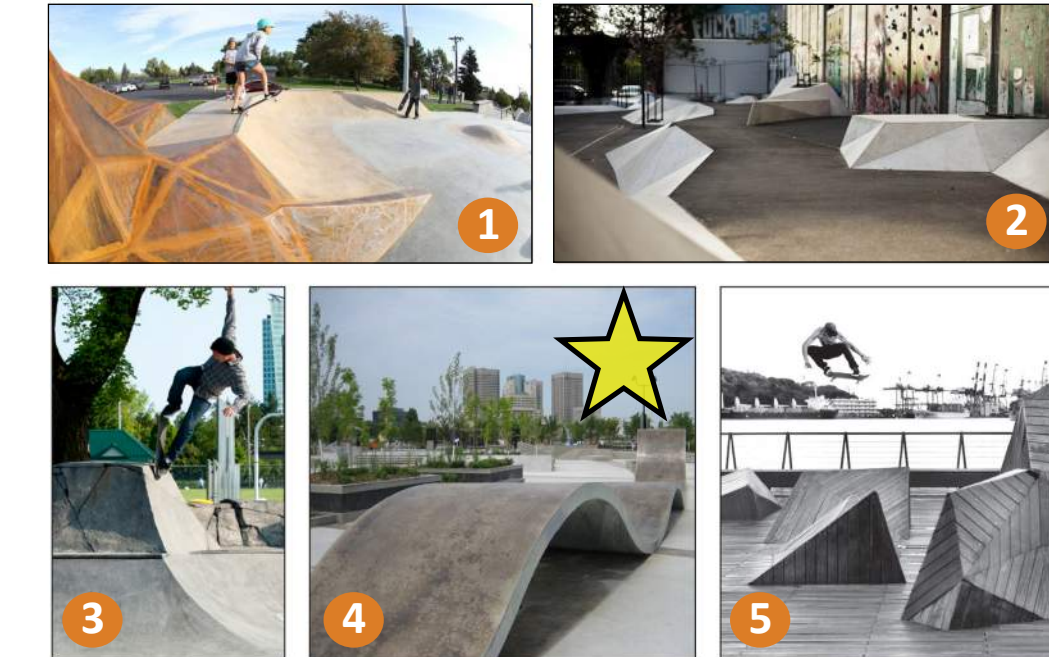

# Design Development | Input Meeting #2 Feedback

On July 25th 2024, a second open house for the Central Gym all-wheels skate park project was held by the City of Minneapolis, Park & Recreation with New Line Skate parks. The goal was to engage the community, inform them about the project, collect input on desired project features and park improvements.

The open house gathered a dozen participants who voiced their ideas on the current design directions. Participants were presented with a “Dotmocracy” exercise, given the opportunity to express their desired skate park terrain styles by placing stickers on their preferred concept images.

The preferred skate park concept direction from this group was Concept A.



Meeting Flyer

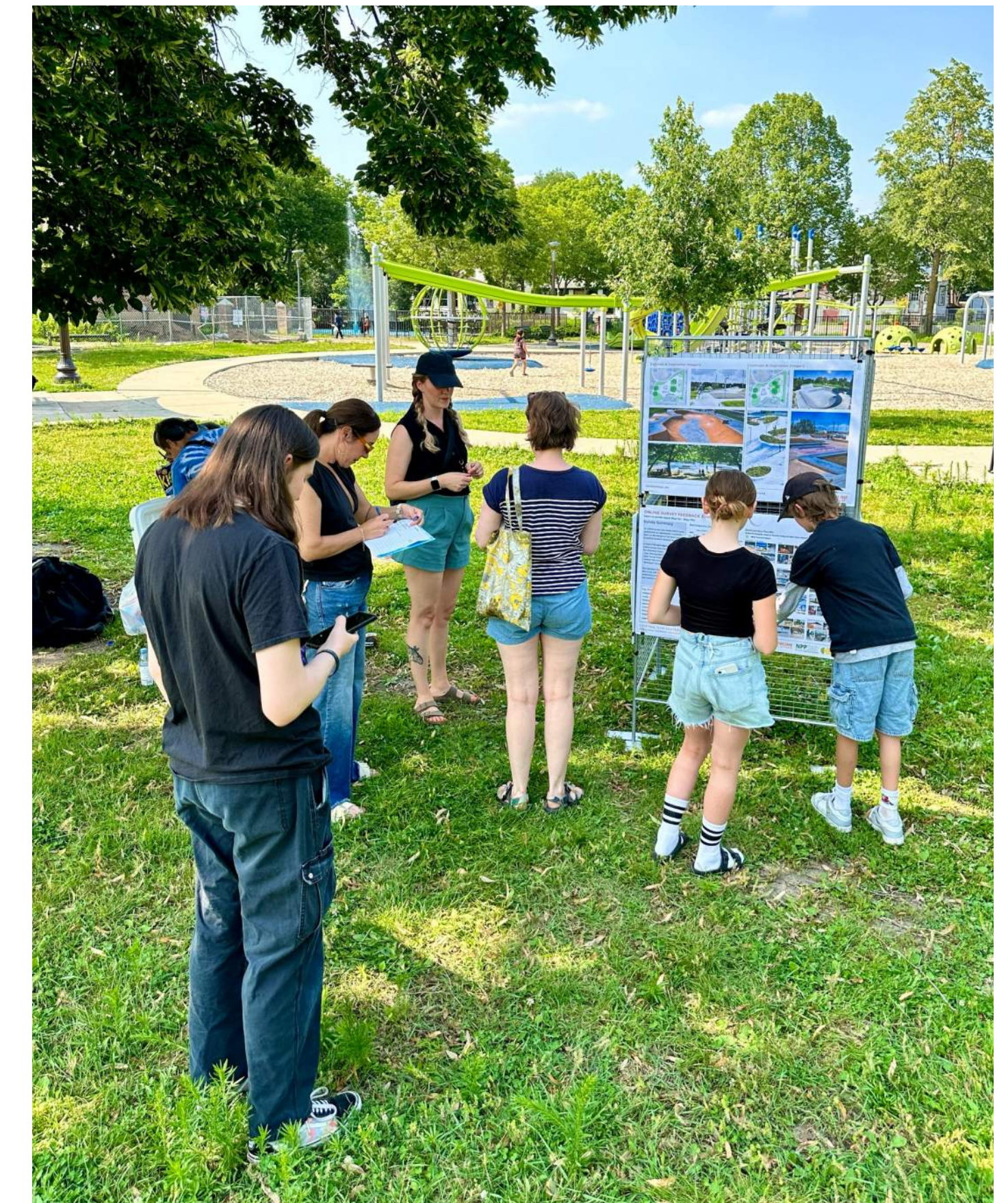

Open House Dotmocracy Engagement

## Online Feedback

Following the open house meeting, an online survey was opened to the public from July 25th until August 8th. This led to an engagement of 142 participants. The survey requested the public’s thoughts and ideas for the integration of the new skate park design within the existing landscape.

Data was collected about the following topics:

- User Demographics
- User Terrain Style & Feature Priorities
- Desired Site Amenities beyond Skate park Terrain

Key highlights that were noted within the survey will be an asset in creating a welcoming and livable space for its active and passive users.

## Survey Results

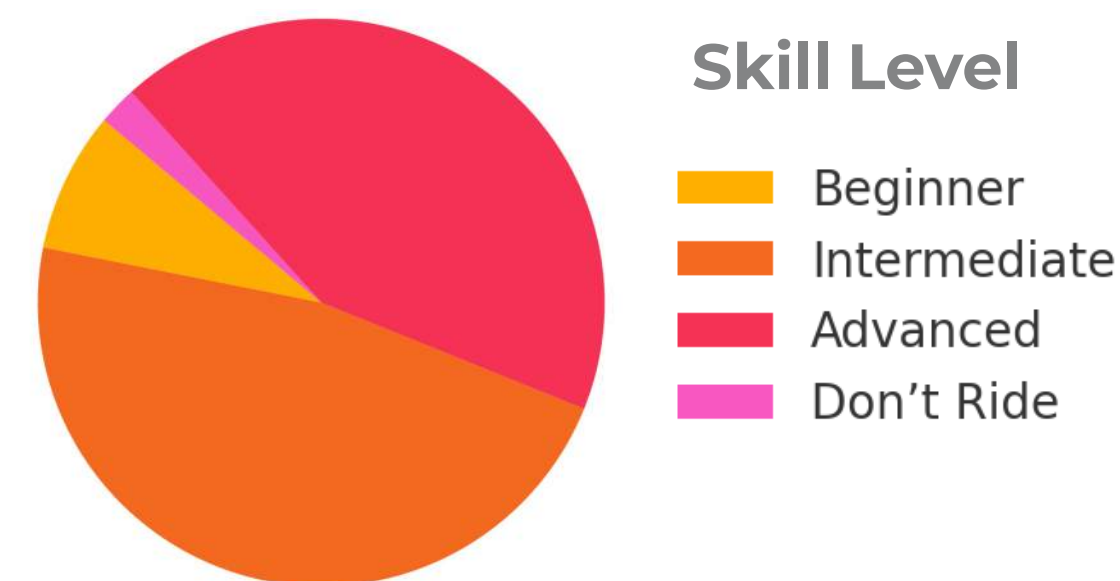

## “I am interested in the project because I am..”

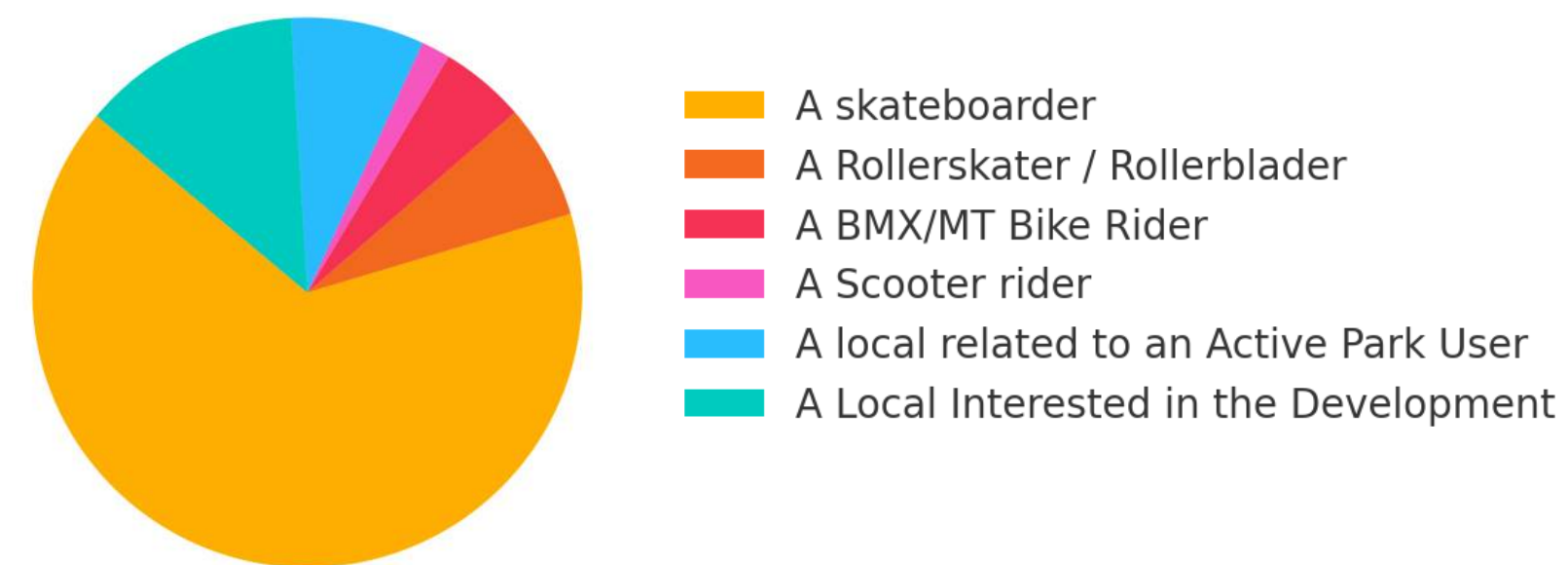

## Preferred Concept Direction

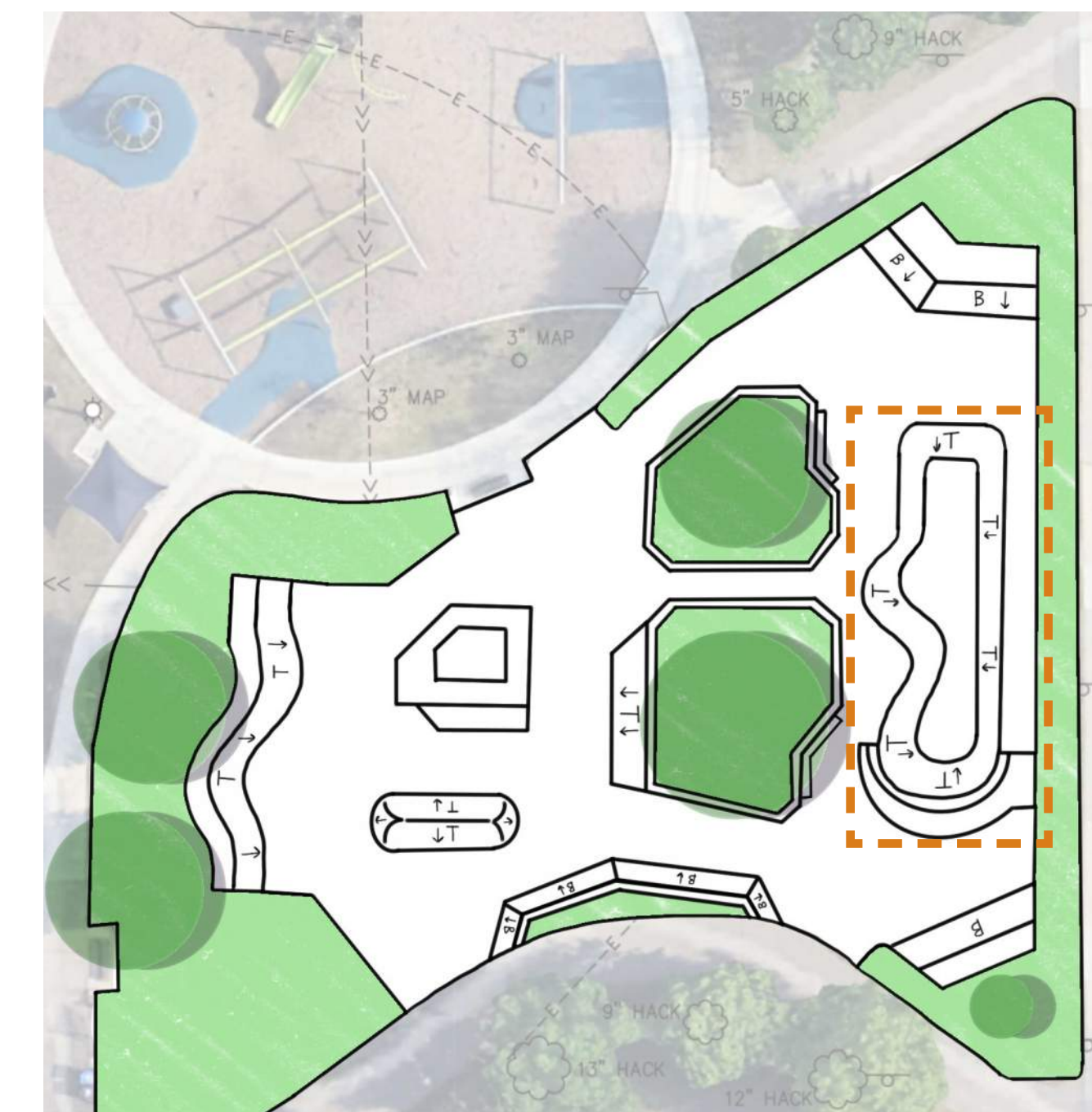

Concept A's Flow Bowl

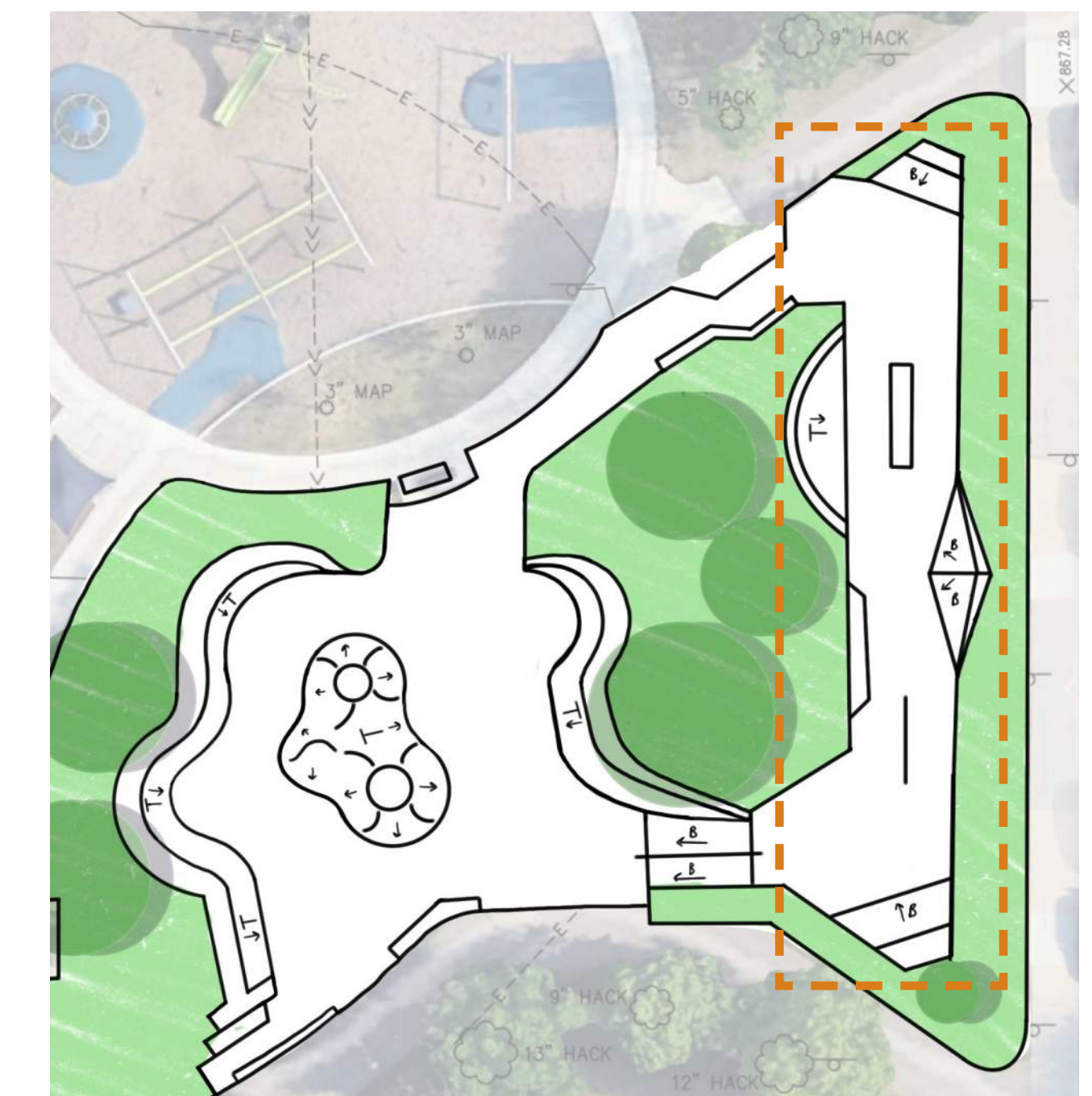

Concept B's Street Lanes