

# BOHEMIAN FLATS OAK SAVANNA RESTORATION

PROJECT # 22-172A

## CONTEXT MAP

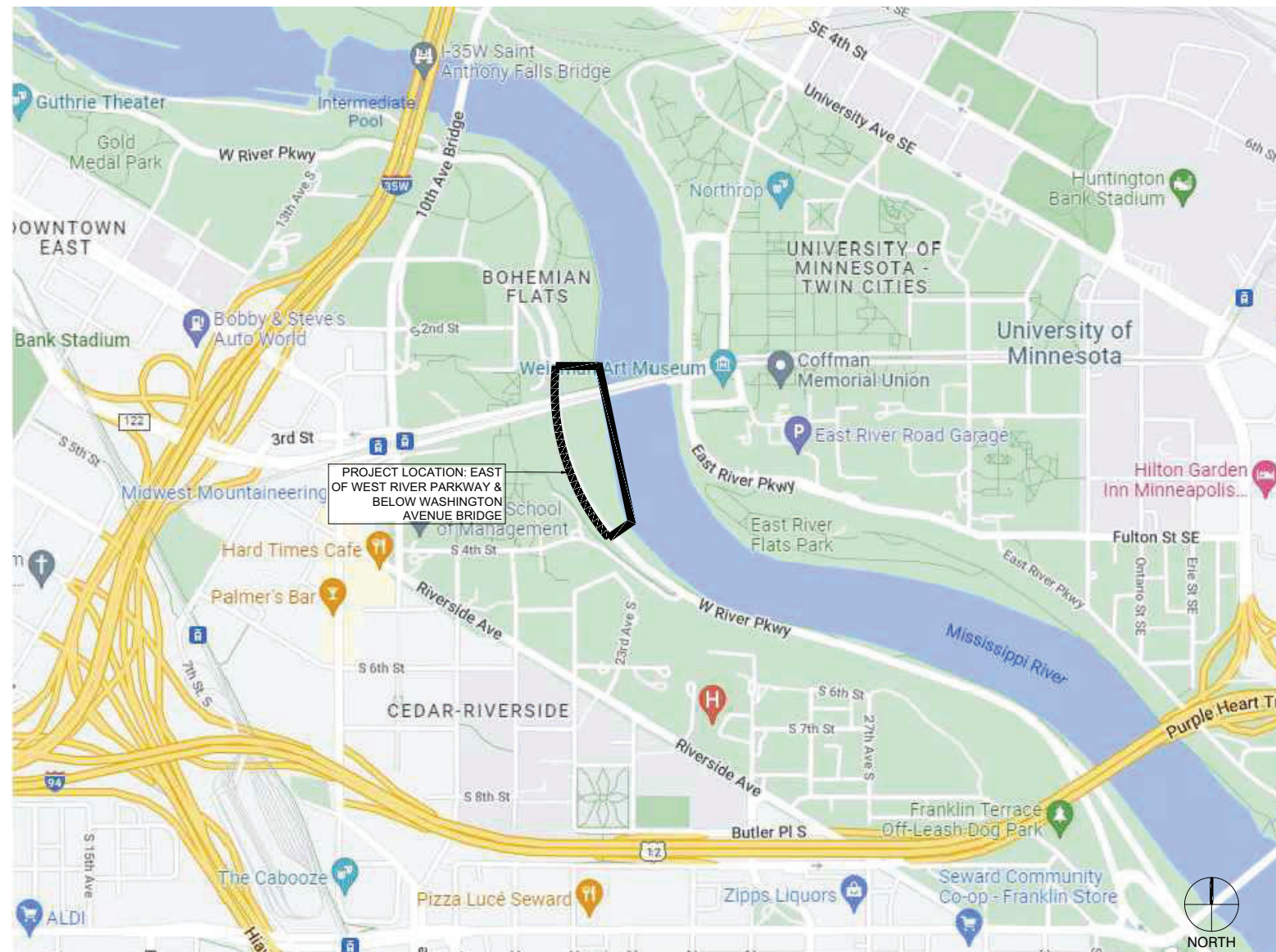

## LEGEND

| SHEET | DESCRIPTION                      |
|-------|----------------------------------|
| G001  | COVER SHEET                      |
| G002  | GENERAL NOTES & ABBREVIATIONS    |
| G003  | EXISTING CONDITIONS              |
| L001  | LANDSCAPE NOTES                  |
| L010  | SCHEDULES                        |
| L011  | SCHEDULES                        |
| L100  | SITE & MATERIALS PLAN            |
| L105  | GRADING & EROSION CONTROL- SWPPP |
| L106  | SWPPP NOTES                      |
| L120  | SOILS PLAN                       |
| L160  | TREE PLANTING PLAN               |
| L161  | SEEDING & PLANTING PLAN          |
| L500  | DETAILS                          |
| L501  | DETAILS                          |

## PROJECT DIRECTORY

### OWNER

MINNEAPOLIS PARK AND RECREATION BOARD

2117 WEST RIVER ROAD NORTH  
MINNEAPOLIS, MN 55411  
CONTACT: TYLER PEDERSON, PROJECT MANAGER  
612-499-9084

### LANDSCAPE ARCHITECT, OWNER'S REPRESENTATIVE

DAMON FARBER LANDSCAPE ARCHITECTS  
310 S 4TH AVE  
MINNEAPOLIS, MN 55415  
CONTACT: JODI REFSLAND, PLA  
JREFSLAND@DAMONFARBER.COM  
612-281-1355



310 South 4th Avenue, Suite 7050  
Minneapolis, MN 55415  
p: 612.332.7522



SUBMITTAL  
BID DOCUMENTS

## BOHEMIAN FLATS OAK SAVANNA RESTORATION

MINNEAPOLIS, MN

I hereby certify that this document was prepared by me or under my direct supervision and that I am a duly licensed Landscape Architect under the laws of the State of Minnesota.

Name Thomas Whitlock  
Registration# 26292  
Tom Whitlock 04/21/2023  
Signature Date

DFJ Project # 22-172a  
Scale VARIABLES  
Drawn/Checked JMR/MR

| REVISION |  |
|----------|--|
|          |  |
|          |  |
|          |  |
|          |  |

COVER  
SHEET

G001

# GENERAL PROJECT NOTES

## CONTRACT DOCUMENTS

1. THE WORK SHALL CONFORM TO THE CONTRACT DOCUMENTS.
2. THE CONTRACT DOCUMENTS ARE COMPLEMENTARY. READ THE DRAWINGS IN CONJUNCTION WITH THE SPECIFICATIONS AND EXECUTE THE WORK.
3. THE WORK IS DEPENDENT ON SEVERAL DISCIPLINES. READ THE DRAWINGS BY CROSS-REFERENCING BETWEEN DISCIPLINES.
4. REPORT DISCREPANCIES IMMEDIATELY TO THE OWNER'S REPRESENTATIVE FOR DIRECTION BEFORE PROCEEDING WITH THE WORK.

## SITE ACCESS & PROTECTION

1. STAGING AREA IS WITHIN THE CONTRACT LIMIT (OR "PROJECT LIMITS") LINE. STAGING AREA DOES NOT INCLUDE ACCESS ROUTES TO THE SITE. THE CONSTRUCTION (AND REMOVAL AND RESTORATION) OF TEMPORARY STAGING AREAS AND/OR ACCESS ROUTES SHALL BE THE CONTRACTOR'S SOLE RESPONSIBILITY AND EXPENSE.
2. CONSTRUCTION RELATED VEHICLES REQUIRED FOR THE WORK EXITING AND/OR ENTERING THE SITE SHALL NOT DEPOSIT DIRT, MUD, OR OTHER DELETERIOUS MATERIALS THAT WOULD PRESENT A NUISANCE OR HAZARD TO THE PUBLIC TRAVELING THROUGH THE PARK. PREVENTION AND CLEANING SHALL BE THE CONTRACTOR'S SOLE RESPONSIBILITY AND EXPENSE.
3. NO WORK, EQUIPMENT OR STAGING IS PERMITTED OUTSIDE THE LIMIT LINES UNLESS THE CONTRACTOR HAS APPROVAL FROM THE OWNER. COORDINATION PERMITS AND TRAFFIC CONTROL REQUIRED SHALL BE THE CONTRACTOR'S SOLE RESPONSIBILITY AND EXPENSE.
4. THE DOCUMENTS DO NOT SPECIFY SAFETY MATERIALS, EQUIPMENT, METHODS OR SEQUENCING TO PROTECT PERSONS AND PROPERTY. IT SHALL BE THE CONTRACTOR'S SOLE RESPONSIBILITY AND EXPENSE TO DIRECT AND IMPLEMENT SAFETY OPERATIONS TO PROTECT PERSONS AND PROPERTY.

## QUALITY ASSURANCE

1. EXECUTE THE WORK AND SCHEDULE INSPECTIONS IN ACCORDANCE WITH APPLICABLE FEDERAL, STATE, AND LOCAL STANDARDS, LAWS AND REGULATIONS.
2. ENSURE SUBCONTRACTORS, MANUFACTURERS AND SUPPLIERS HAVE THE LATEST CONTRACT DOCUMENTS PRIOR TO THE SUBMITTAL OF THEIR SHOP DRAWINGS AND/OR DELEGATED DESIGN DRAWINGS.
3. REFER TO THE SPECIFICATIONS FOR REQUIRED SUBMITTALS, INSPECTIONS AND NOTICE TO PROCEED.

## EXISTING CONDITIONS SURVEY

1. THE DOCUMENTS ARE BASED ON THE FOLLOWING TOPOGRAPHIC AND UTILITY SURVEY:
2. TOPOGRAPHIC SURVEY BY CIVIL SITE GROUP, DATED AUGUST 16, 2018
3. SURVEYED UNDERGROUND UTILITIES ARE PROVIDED FOR INFORMATION ONLY AS THEY ARE INFERRED BY SURFACE MARKINGS AND FEATURES AND AS SUCH MAY NOT BE ACCURATE OR COMPLETE.

## UTILITIES

1. THE LOCATIONS AND SIZES OF EXISTING UTILITIES (IF SHOWN) ARE APPROXIMATE ONLY. IDENTIFY, LOCATE AND PROTECT UNDERGROUND AND OVERHEAD UTILITIES TO REMAIN.
2. COORDINATE WITH THE LOCAL UTILITY COMPANIES AND/OR AGENCIES. CALL LOCAL '811' OR REQUEST LOCATES ONLINE NO LESS THAN 48 HOURS PRIOR TO DIGGING TO LOCATE UNDERGROUND UTILITIES OR AS REQUIRED BY LOCAL REGULATIONS.
3. CONTRACTOR SHALL ARRANGE FOR A PRIVATE UTILITY LOCATION SERVICE TO LOCATE UTILITIES WITHIN THE PARK.
4. CONTRACTOR SHALL BE FULLY RESPONSIBLE FOR THE COST OF DAMAGES WHICH OCCUR AS A RESULT OF A FAILURE TO ACCURATELY LOCATE AND/OR RETAIN UTILITIES TO REMAIN.

## LAYOUT

1. THE VERTICAL CONTROL FOR THE PROJECT IS: NORTH AMERICAN VERTICAL DATUM (NAV88) OR NATIONAL GEODETIC DATUM (NGDV29) UNLESS OTHERWISE NOTED.
2. VERIFY THE LOCATION OF EXISTING FEATURES TO REMAIN THAT CONNECT TO NEW WORK, DIMENSIONAL CLEARANCES, SETBACKS AND OFFSETS AND VERTICAL DATUM. REPORT DISCREPANCIES IMMEDIATELY TO THE OWNER'S REPRESENTATIVE FOR DIRECTION BEFORE PROCEEDING WITH THAT PORTION OF THE WORK.
3. IT IS THE CONTRACTOR'S RESPONSIBILITY TO FIELD VERIFY EXISTING SITE CONDITIONS AND EVOLVING SITE CONDITIONS PRIOR TO THE START OF SITE WORK. DISCREPANCY AND/OR UNFORESEEN CONDITIONS FOUND SHALL BE BROUGHT TO THE IMMEDIATE ATTENTION OF THE OWNER'S REPRESENTATIVE PRIOR TO STARTING THE SITE WORK. DO NOT BEGIN WORK IN SUCH AFFECTED AREA UNTIL THE DISCREPANCY HAS BEEN RESOLVED.
4. ERECT AND INSTALL ALL WORK LEVEL, PLUMB, SQUARE, TRUE, STRAIGHT AND IN PROPER ALIGNMENT.
5. DO NOT SCALE FROM DRAWINGS. USE DIMENSIONS SHOWN AND/OR SUPPLIED CAD DRAWING FILE AND SURVEY INTERPOLATION.

6. DIMENSIONS NOTED "CLR" OR "CLEAR" MUST BE STRICTLY MAINTAINED ALLOWING FOR THICKNESS OF FINISHES. FIELD VERIFY PRIOR TO CONSTRUCTION.
7. CURVES FOR PAVING, BANDS, PATHS, EDGING AND HEADER BOARDS SHALL BE SMOOTH AND CONTINUOUS WITHOUT ABRUPT CHANGES, OBVIOUS TANGENTS OR BENDS.
8. PITCH EVENLY BETWEEN SPOT GRADES AND CONTOUR LINES UNLESS GRADE BREAKS, RIDGELINES, SWALES ARE INDICATED OR OTHERWISE NOTED. PAVED AREAS SHALL PITCH AT A MINIMUM OF 1% UNLESS OTHERWISE NOTED ON DRAWINGS. DISCREPANCIES OR CONDITIONS NOT ALLOWING THIS TO OCCUR SHALL BE REPORTED TO THE OWNER'S REPRESENTATIVE FOR RESOLUTIONS PRIOR TO CONTINUING WORK.

## CODE COMPLIANCE

1. WORK SHALL BE IN ACCORDANCE WITH APPLICABLE LAWS, CODES AND REQUIREMENTS OF REGULATORY AGENCIES HAVING JURISDICTION.
2. NOTIFY THE OWNER'S REPRESENTATIVE OF DISCREPANCIES BETWEEN THE WORK AND APPLICABLE CODES. DO NOT WORK IN AN AFFECTED AREA UNTIL THE DISCREPANCY HAS BEEN RESOLVED.
3. VERIFY CODES IN EFFECT AT THE TIME OF THE NOTICE TO PROCEED AND STAY CURRENT WITH CODE CHANGES WHICH AFFECT THE WORK UNTIL SUBSTANTIAL COMPLETION.
4. IT IS THE SOLE RESPONSIBILITY OF THE CONTRACTOR TO OBTAIN AND PAY FOR CONSTRUCTION RELATED PERMITS.

## CODES IN EFFECT

1. THE FOLLOWING CODES ARE APPLICABLE AND IN EFFECT:
  - 2020 MN BUILDING CODE
2. REVISIONS TO THE APPROVED AND PERMITTED DRAWINGS OR DOCUMENTS SHALL BE SUBMITTED TO THE CODE AUTHORITIES FOR REVIEW. NOTIFY THE OWNER'S REPRESENTATIVE OF THE PROCESSING TIME FOR EACH REVISION SUBMITTED FOR PLAN CHECK.

## COPYRIGHT AND REPRODUCTION

1. THE USE OF REPRODUCTIONS OF THE CONTRACT DOCUMENTS OR ELECTRONIC FILES AS SHOP DRAWING DOCUMENTS BY THE CONTRACTOR IS AT THEIR OWN RISK. THE DESIGN CONSULTANTS ASSUME NO LIABILITY AS A RESULT OF THE USE OF REPRODUCTIONS OF THE CONTRACT DOCUMENTS FOR SHOP DRAWINGS AND/OR DELEGATED DESIGN DRAWINGS.
2. THE ENTIRE CONTRACT DOCUMENT PACKAGE HEREIN IS THE ORIGINAL AND UNPUBLISHED PROPERTY OF THE OWNER AND MAY NOT BE DUPLICATED, USED OR DISCLOSED WITHOUT THE PRIOR EXPLICIT WRITTEN CONSENT.
3. THE USE OF DIGITAL DESIGN FILES SHALL REQUIRE THE CONTRACTOR TO AGREE TO PRIME CONSULTANT'S LICENSE CONDITIONS BEFORE USE.

## CONSTRUCTION LOADS, DAMAGES & REPAIRS

1. THE CONTRACTOR IS SOLELY RESPONSIBLE FOR SLOPE STABILITY AND DE-WATERING DURING THE WORKS UNLESS UNKNOWN CONDITIONS ARE ENCOUNTERED.
2. THE CONTRACTOR IS SOLELY RESPONSIBLE FOR PROTECTING THE WORKS FROM CONSTRUCTION LOADS AND DAMAGES TO EXISTING STRUCTURES TO REMAIN, NEW STRUCTURES AND NEW PAVEMENTS DURING THE WORKS.
3. THE CONTRACTOR SHALL BE FULLY RESPONSIBLE FOR THE COST OF DAMAGES WHICH OCCUR AS A RESULT OF A FAILURE TO MITIGATE CONSTRUCTION LOADS AND/OR PROTECT THE WORKS FROM CONSTRUCTION RELATED IMPACTS. REPAIRS SHALL BE TO A NEW OR BETTER CONDITION COMPARED TO THE EXISTING CONDITION BEFORE DAMAGE, AND AS APPROVED BY THE OWNER'S REPRESENTATIVE.

## CONSTRUCTION WASTE MANAGEMENT

1. REMOVE FROM THE SITE EXCESS MATERIAL AND/OR DEBRIS. DISPOSAL OF MATERIALS IS THE RESPONSIBILITY OF THE CONTRACTOR. EXCESS MATERIAL AND/OR DEBRIS NOT TO BE COMPOSTED, RECYCLED, OR REUSED SHALL BE DISPOSED OF OFF THE PROJECT SITE IN A PERMITTED LANDFILL.

# SYMBOLS

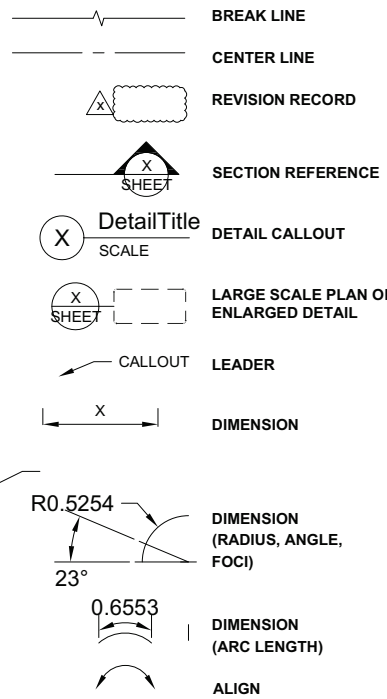

# ABBREVIATIONS

|            |                                |       |                     |
|------------|--------------------------------|-------|---------------------|
| APPROX AVG | APPROXIMATE AVERAGE            | OC    | ON CENTER           |
| BLDG       | BUILDING                       | OD    | OUTSIDE DIAMETER    |
| BM         | BENCHMARK                      | QTY   | QUANTITY            |
| BS         | BOTTOM OF STAIR                | R     | RADIUS              |
| CIP        | CAST-IN-PLACE                  | REINF | REINFORCE           |
| CJ         | CONTROL JOINT                  | REQD  | REQUIRED            |
| CL         | CENTER LINE                    | REV   | REVISION            |
| CLR        | CLEAR                          | SALV  | SALVAGE             |
| CONC       | CONCRETE                       | SIM   | SIMILAR             |
| DAT        | DATUM                          | SPEC  | SPECIFICATION       |
| DEG        | DEGREE                         | SQ    | SQUARE              |
| DIA        | DIAMETER                       | SS    | STAINLESS STEEL     |
| DIM        | DIMENSION                      | TAN   | TANGENT             |
| DIST       | DISTANCE                       | TBD   | TO BE DETERMINED    |
| DWG        | DRAWING                        | THK   | THICKNESS           |
| EA         | EACH                           | THRU  | THROUGH             |
| EJ         | EXPANSION JOINT                | TO_   | TOP OF _            |
| EQ         | EQUAL                          | TOS   | TOP OF SLOPE        |
| FV         | FIELD VERIFY                   | TOW   | TOP OF WALL         |
| GALV       | GALVANIZED                     | TS    | TOP OF STAIR        |
| GB         | GRADE BREAK                    | TYP   | TYPICAL             |
| H          | HIGH                           | UGND  | UNDERGROUND         |
| HT         | HEIGHT                         | VAR   | VARIES              |
| IJ         | ISOLATION JOINT                | VERT  | VERTICAL            |
| LF         | LINEAR FEET                    | VERFY | VERIFY              |
| LPT        | LOW POINT                      | W     | WEST                |
| MAX        | MAXIMUM                        | W/    | WITH                |
| MFR.REC    | MANUFACTURER'S RECOMMENDATIONS | W/O   | WITHOUT             |
| MIN        | MINIMUM                        | WL    | WATERLINE           |
| N          | NORTH                          | WLD   | WELDED              |
| NA         | NOT APPLICABLE                 | YR    | YEAR                |
| NIC        | NOT IN CONTRACT                | @     | AT                  |
| NO         | NUMBER                         | &     | AND                 |
| NOM        | NOMINAL                        | - / + | DIMENSION TOLERANCE |
| NTS        | NOT TO SCALE                   |       |                     |



310 South 4th Avenue, Suite 7050  
 Minneapolis, MN 55415  
 p: 612.332.7522



SUBMITTAL  
 BID DOCUMENTS

# BOHEMIAN FLATS OAK SAVANNA RESTORATION

MINNEAPOLIS, MN

I hereby certify that this document was prepared by me or under my direct supervision and that I am a duly licensed Landscape Architect under the laws of the State of Minnesota.

Name: Thomas Whitlock  
 Registration#: 26292  
 Signature: [Signature] Date: 04/21/2023

DFJ Project #: 22-172a  
 Scale: VARIES  
 Drawn/Checked: JMR/MR

REVISION: --

# GENERAL NOTES & ABBREVIATIONS

# G002

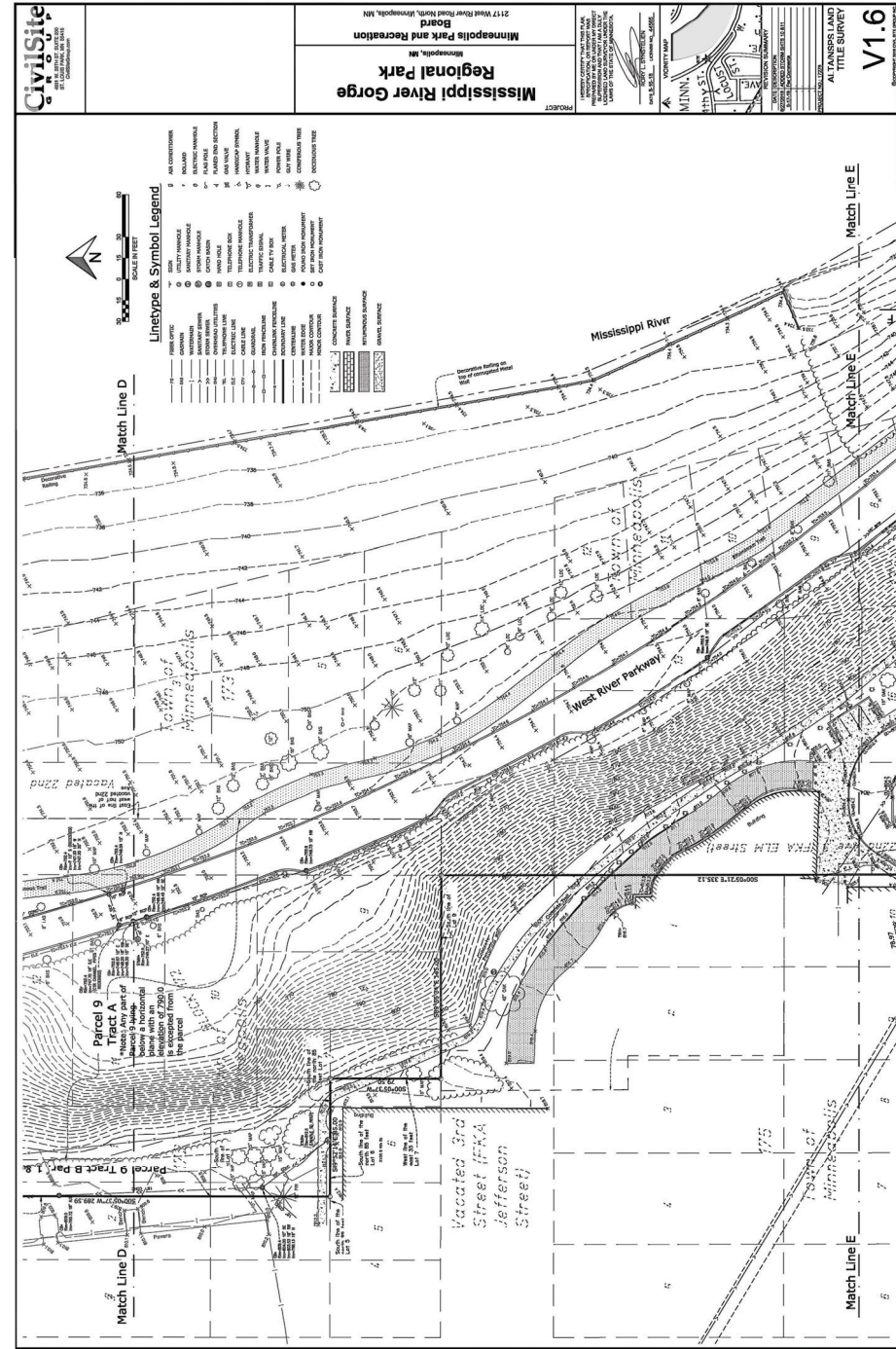
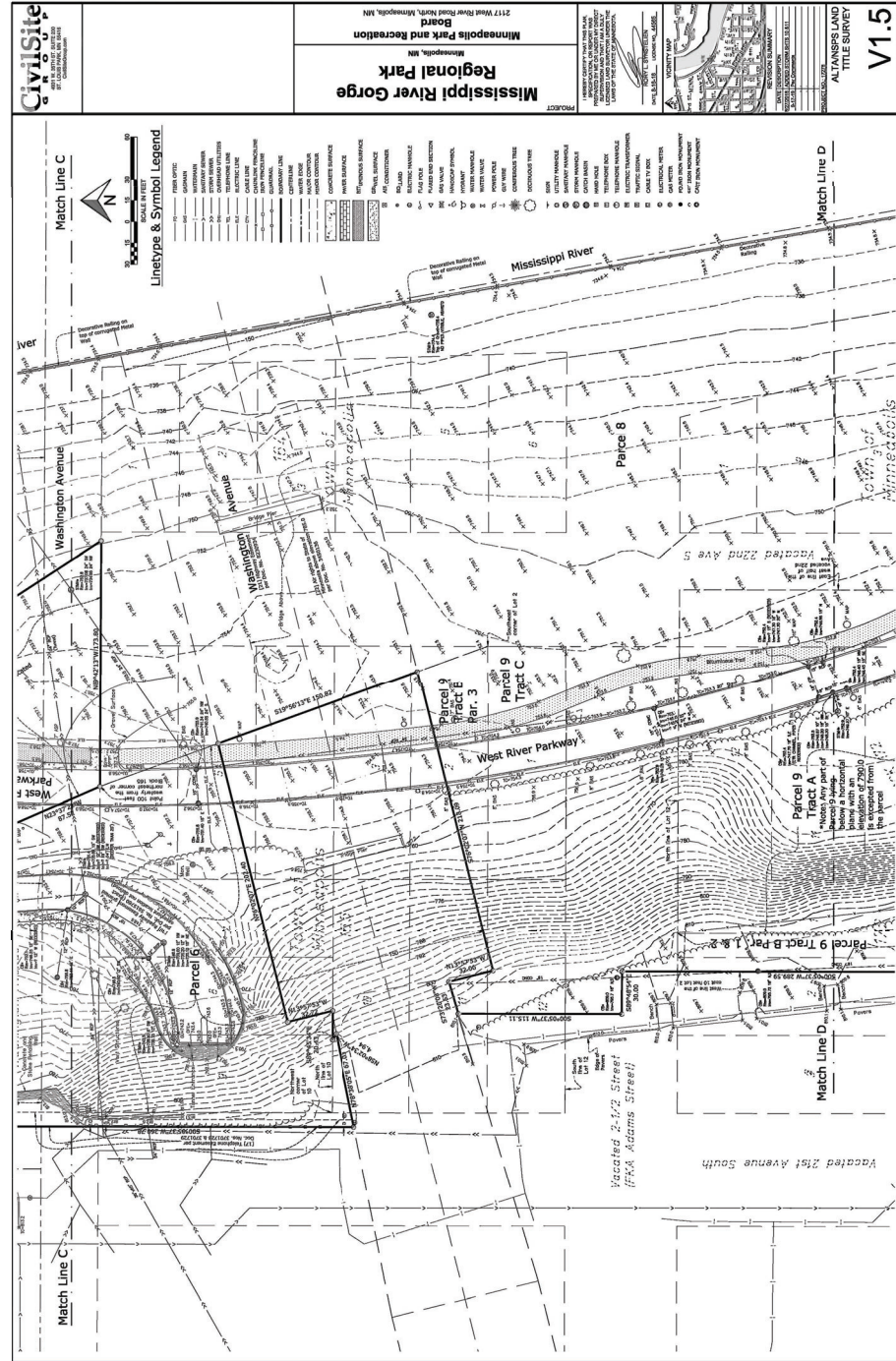
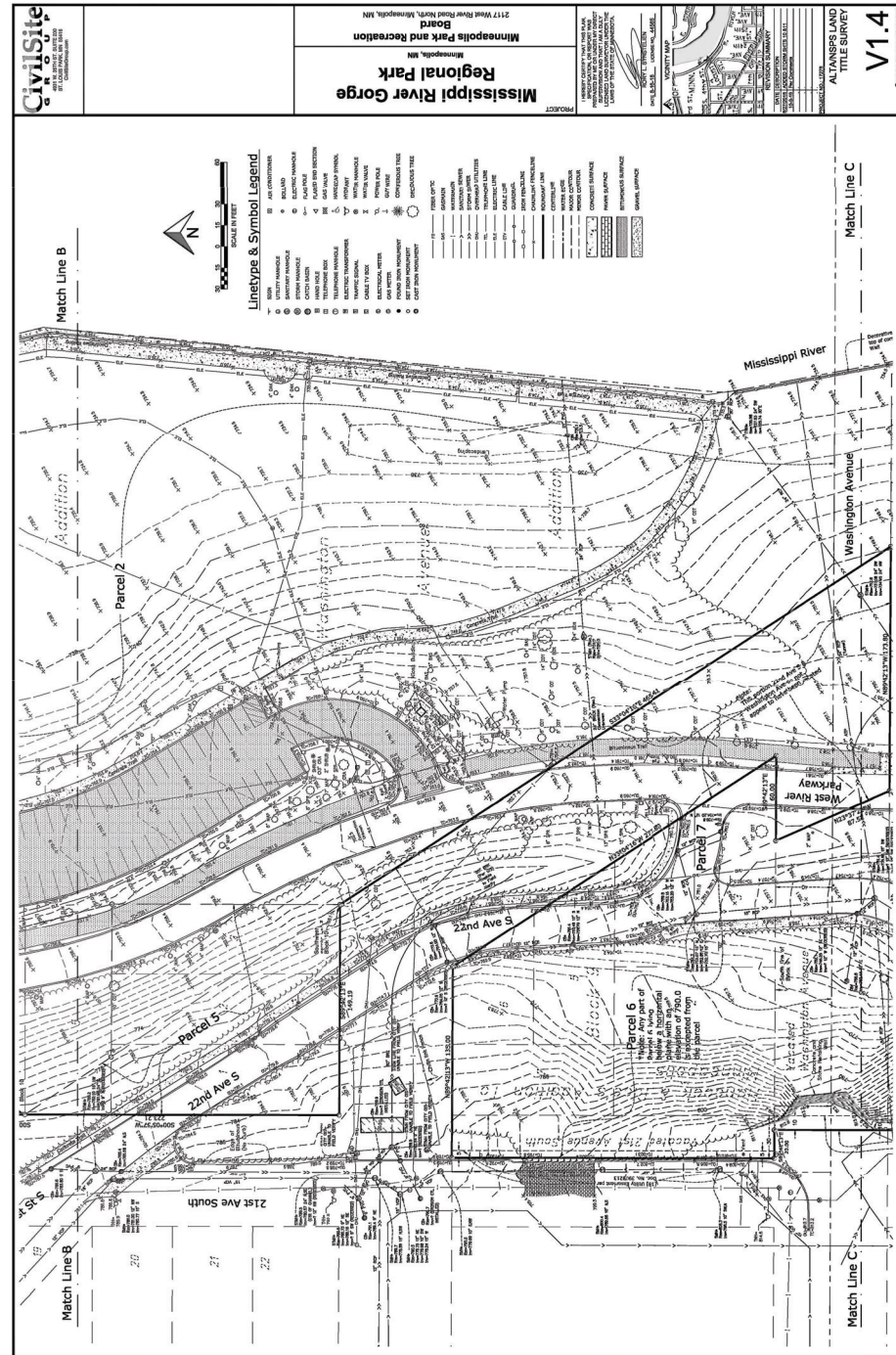

- NOTES**
1. SURVEY HAS BEEN PREPARED AND PROVIDED BY OTHERS. SURVEY IS INCLUDED FOR REFERENCE ONLY.
  2. .DWG FILE AVAILABLE UPON REQUEST.



APPLICATION: BLDG1007631  
 DATE: 07/31/23



SUBMITTAL  
 BID DOCUMENTS

**BOHEMIAN  
 FLATS  
 OAK SAVANNA  
 RESTORATION**

MINNEAPOLIS, MN

I hereby certify that this document was prepared by me or under my direct supervision and that I am a duly licensed Landscape Architect under the laws of the State of Minnesota.

Name: Thomas Whitlock  
 Registration#: 26292  
 Signature: *Tom Whitlock* Date: 04/21/2023

DFJ Project #: 22-172a  
 Scale: VARIES  
 Drawn/Checked: JMR/MR

| REVISION |  |
|----------|--|
|          |  |
|          |  |
|          |  |
|          |  |

EXISTING  
 CONDITIONS

**G003**

310 South 4th Avenue, Suite 7050  
 Minneapolis, MN 55415  
 p: 612.332.7522

## EXISTING CONDITIONS & SITE REMOVAL NOTES

### SITE REMOVAL NOTES

- EXISTING SITE INFORMATION WAS PROVIDED BY OTHERS. ACTUAL FIELD CONDITIONS MAY VARY. FIELD VERIFY UTILITY LOCATIONS AND ELEVATIONS PRIOR TO CONSTRUCTION.
- CONTRACTOR TO VERIFY THE LOCATION OF UNDERGROUND UTILITIES PRIOR TO BEGINNING ANY CONSTRUCTION BY CALLING GOPHER STATE ONE-CALL AT 651-454-0002 (METRO) OR 1-800-252-1166 (OUT-STATE).
- THE CONTRACTOR SHALL COORDINATE WITH RESPECTIVE UTILITY COMPANIES PRIOR TO THE REMOVAL AND/OR RELOCATION OF UTILITIES. THE CONTRACTOR SHALL COORDINATE WITH THE UTILITY COMPANY CONCERNING PORTIONS OF WORK WHICH MAY BE PERFORMED BY UTILITY COMPANY'S FORCES AND FEES WHICH ARE TO BE PAID TO THE UTILITY COMPANY FOR THEIR SERVICES. THE CONTRACTOR IS RESPONSIBLE FOR PAYING FEES AND CHARGES.
- ALWAYS VERIFY BENCHMARK ELEVATIONS BETWEEN TWO BENCHMARKS.
- DAMAGE TO REMAINING EXISTING CONDITIONS WILL BE REPLACED AT CONTRACTOR'S EXPENSE AND SHALL BE EQUAL TO OR EXCEED THE QUALITY OF CONSTRUCTION PRIOR TO DAMAGE.
- CONTRACTOR SHALL PRESERVE VEGETATION NOT TO BE REMOVED BY CONSTRUCTION. CONTRACTOR SHALL BE RESPONSIBLE FOR RE-SEEDING OR SODDING AREAS DISTURBED BY CONSTRUCTION.
- LOCATION AND ELEVATIONS OF IMPROVEMENTS TO BE MET (OR AVOIDED) SHALL BE CONFIRMED BY THE CONTRACTOR THROUGH FIELD EXPLORATIONS PRIOR TO CONSTRUCTION. CONTRACTOR SHALL REPORT TO THE LANDSCAPE ARCHITECT DISCREPANCIES BETWEEN THEIR MEASUREMENTS AND THESE PLANS. CONTRACTOR SHALL ALSO MAKE EXPLORATION EXCAVATIONS AND LOCATE EXISTING UNDERGROUND UTILITIES SUFFICIENTLY AHEAD OF CONSTRUCTION TO PERMIT REVISIONS TO PLANS IF REVISIONS ARE NECESSARY BECAUSE OF ACTUAL LOCATION OF EXISTING FACILITIES. CONTRACTOR IS REQUIRED TO TAKE PRECAUTIONARY MEASURES TO PROTECT THE UTILITY LINES SHOWN AND OTHER EXISTING LINES NOT OF RECORD OR NOT SHOWN ON THESE PLANS.

## SITE AND LANDSCAPE NOTES

### SITE PREPARATION NOTES

- CONTRACTOR SHALL INSPECT THE SITE AND BECOME FAMILIAR WITH EXISTING CONDITIONS RELATING TO THE NATURE AND SCOPE OF WORK.
- CONTRACTOR SHALL ASSURE COMPLIANCE WITH APPLICABLE CODES AND REGULATIONS GOVERNING THE WORK AND MATERIALS SUPPLIED.
- HORIZONTAL AND VERTICAL ALIGNMENT OF PROPOSED WALKS, TRAILS OR ROADWAYS ARE SUBJECT TO FIELD ADJUSTMENT REQUIRED TO CONFORM TO LOCALIZED TOPOGRAPHIC CONDITIONS AND TO MINIMIZE TREE REMOVAL AND GRADING. CHANGES IN ALIGNMENT AND GRADES MUST BE APPROVED BY THE LANDSCAPE ARCHITECT PRIOR TO IMPLEMENTATION.
- CONTRACTOR SHALL REVIEW THE SITE FOR DEFICIENCIES IN SITE CONDITIONS WHICH MIGHT NEGATIVELY AFFECT PLANT ESTABLISHMENT, SURVIVAL OR WARRANTY. UNDESIRABLE SITE CONDITIONS SHALL BE BROUGHT TO THE ATTENTION OF THE LANDSCAPE ARCHITECT PRIOR TO COMMENCEMENT OF WORK.
- CONTRACTOR IS RESPONSIBLE FOR ONGOING MAINTENANCE OF NEWLY INSTALLED MATERIALS UNTIL TIME OF SUBSTANTIAL COMPLETION. REPAIR OF ACTS OF VANDALISM OR DAMAGE WHICH MAY OCCUR PRIOR TO SUBSTANTIAL COMPLETION SHALL BE THE RESPONSIBILITY OF THE LANDSCAPE CONTRACTOR.
- CONTRACTOR SHALL PREPARE AND SUBMIT A WRITTEN REQUEST FOR THE SUBSTANTIAL COMPLETION INSPECTION OF LANDSCAPE AND SITE IMPROVEMENTS PRIOR TO SUBMITTING FINAL PAY REQUEST.
- CONTRACTOR SHALL PREPARE AND SUBMIT REPRODUCIBLE AS-BUILT DRAWING(S) OF LANDSCAPE INSTALLATION AND SITE IMPROVEMENTS UPON COMPLETION OF CONSTRUCTION INSTALLATION AND PRIOR TO SUBSTANTIAL COMPLETION.
- SYMBOLS ON PLAN DRAWING TAKE PRECEDENCE OVER SCHEDULES IF DISCREPANCIES IN QUANTITIES EXIST. SPECIFICATIONS AND DETAILS TAKE PRECEDENCE OVER NOTES.

### GRADING

- GRADING LIMITS ARE DEFINED AS THE JUNCTURE OF PROPOSED GRADE WITH EXISTING GRADE UNLESS NOTED OTHERWISE.
- GRADING LIMITS AND LIMITS OF WORK SHOWN ON PLAN ARE ONLY APPROXIMATE AND MAY BE ADJUSTED IN FIELD BY LANDSCAPE ARCHITECT. WORK OUTSIDE OF THESE LIMITS WILL BE DONE AT LANDSCAPE CONTRACTORS EXPENSE UNLESS DIRECTED BY LANDSCAPE ARCHITECT OR OWNER IN WRITING.
- FILL/CUT AS NECESSARY TO PROVIDE A 1% MINIMUM GRADE AWAY FROM BUILDINGS WITHIN LIMITS OF CONSTRUCTION.
- SALVAGE TOPSOIL FROM THE EARTHWORK AREAS AS APPROPRIATE OR AS INDICATED ON PLANS AND STOCKPILE FOR REUSE. LIMIT

STOCKPILE HEIGHT TO 4' TO PROMOTE HEALTHY SOILS.

- MAINTAIN A UNIFORM GRADE BETWEEN CONTOURS IN AREAS TO BE GRADED UNLESS NOTED OTHERWISE.
- ELEVATIONS, IF SHOWN ARE FINISHED ELEVATIONS. SPOT ELEVATIONS TAKE PRECEDENCE OVER CONTOURS.
- ADD EROSION CONTROL MEASURES IF GRADES GREATER THAN 3:1 OR IF CONDITIONS WARRANT. REFER TO MNDOT SPECIFICATIONS FOR EROSION CONTROL.
- CONTRACTOR SHALL PROVIDE PROPER EROSION CONTROL MEASURES AS REQUIRED TO ENSURE THAT EROSION IS KEPT TO AN ABSOLUTE MINIMUM.
- REFER TO EROSION CONTROL PLAN AND DETAILS FOR EROSION CONTROL NOTES.

### PLANTING AND SEEDING

- PLANT MATERIAL, MULCH, SOILS, AND COMPOST SHALL BE INSPECTED FOR JUMPING WORMS PRIOR TO PLACEMENT AND DISTRIBUTION OF MATERIALS ON SITE. INSPECTION SHALL BE PERFORMED BY LANDSCAPE ARCHITECT. NOTIFY LA MINIMUM OF 48 HRS PRIOR TO MATERIAL ARRIVAL. SEE SPECIFICATIONS FOR SUBMITTAL REQUIREMENTS. JUMPING WORMS ARE AN UNCLASSIFIED INVASIVE SPECIES IN MINNESOTA AND PROVIDE A THREAT TO NATURAL ECOSYSTEMS.**
- PLANT MATERIAL SHALL COMPLY WITH THE CURRENT EDITION OF THE AMERICAN STANDARD FOR NURSERY STOCK, ANSI Z60.1, UNLESS NOTED OTHERWISE, DECIDUOUS SHRUBS SHALL HAVE AT LEAST 5 CANES AT THE SPECIFIED HEIGHT. ORNAMENTAL TREES SHALL HAVE NO 1" CROTCHES AND SHALL BEGIN BRANCHING NO LOWER THAN 3' FEET ABOVE THE ROOT BALL. STREET AND BOULEVARD TREES SHALL BEGIN BRANCHING NO LOWER THAN 6' ABOVE PAVED SURFACE.
- REFER TO SPECIFICATIONS FOR NATIVE SEEDING DATES, SEEDING, AND SOIL PREPARATION.
- STAKE PROPOSED PLANTING LOCATIONS PER PLAN FOR REVIEW AND APPROVAL BY LANDSCAPE ARCHITECT PRIOR TO INSTALL.
- INSTALL NATIVE SEED AFTER FINAL GRADING AND CONSTRUCTION HAS BEEN COMPLETED IN THE IMMEDIATE AREA.
- INSTALL PLANT MATERIAL AFTER FINAL GRADING AND CONSTRUCTION HAS BEEN COMPLETED IN THE IMMEDIATE AREA.
- INSTALL PLANT MATERIALS PER PLANTING DETAILS.
- SUBSTITUTION REQUESTS FOR PLANT MATERIAL TYPE & SIZE SHALL BE SUBMITTED TO THE LANDSCAPE ARCHITECT FOR CONSIDERATION PRIOR TO BIDDING. SUBSTITUTIONS AFTER BIDDING MUST BE APPROVED BY LANDSCAPE ARCHITECT AND ARE SUBJECT TO CONTRACT ADJUSTMENTS.
- ADJUSTMENTS IN LOCATION OF PROPOSED PLANT MATERIALS MAY BE NEEDED IN FIELD. LANDSCAPE ARCHITECT MUST BE NOTIFIED PRIOR TO ADJUSTMENT OF PLANTS.

- SEED AREAS DISTURBED DUE TO GRADING UNLESS NOTED OTHERWISE.
- WHERE SEEDING ABUTS PAVED SURFACES, FINISHED GRADE OF SOD/SEED SHALL BE HELD 1" BELOW SURFACE ELEVATION OF TRAIL, SLAB, CURB, ETC.
- NO SOD NETTING OR PHOTODEGRADABLE EROSION CONTROL BLANKET (ECB) ALLOWED ON SITE. PROVIDE FULLY BIODEGRADABLE ECB ONLY.

### MULCHING

- INSTALL 4" DEEP FINELY SHREDDED HARDWOOD MULCH RINGS AT CONIFEROUS & DECIDUOUS TREES WITH NO MULCH IN DIRECT CONTACT WITH TREE TRUNK.
- INSTALL 3" DEEP FINELY SHREDDED HARDWOOD MULCH RINGS AT SHRUB PLANTING AREAS WITH NO MULCH IN DIRECT CONTACT WITH SHRUB STEMS.

### WATERING

- PLANTED MATERIALS SHALL BE WATERED BY TEMPORARY MEANS UNTIL PLANTS ARE ESTABLISHED, MINIMUM 1 YEAR.
- WATERING SOURCE: METERED HYDRANT ACCESS AVAILABLE NEAR SITE FROM PARK BOARD. HYDRANT LOCATED NORTH OF SITE ALONG WEST RIVER PARKWAY.
- TEMPORARY WATERING MEANS, METHODS, AND SCHEDULING SHALL BE THE CONTRACTOR'S RESPONSIBILITY. REMOVE TEMPORARY WATERING EQUIPMENT UPON PLANT ESTABLISHMENT- MINIMUM 1 YEAR OR AS DETERMINED BY LA/OWNER.
- CONTRACTOR SHALL US PRECAUTION TO MINIMIZE DISTURBANCE TO SEEDED AREAS DURING WATERING ACTIVITIES. REVIEW WATERING PLAN WITH LA/OWNER BEFORE ESTABLISHMENT WATERING BEGINS.
- PROVIDE SLOW-RELEASE WATERING BAGS FOR NEW TREES.

### WARRANTY & MAINTENANCE

- WARRANTY NEW PLANT MATERIAL THROUGH ONE CALENDAR YEAR FROM THE DATE OF SUBSTANTIAL COMPLETION. NO PARTIAL ACCEPTANCE WILL BE CONSIDERED.
- MAINTAIN SEEDED AREAS FOR 3 YEAR ESTABLISHMENT PERIOD. SEE SPECIFICATIONS.



310 South 4th Avenue, Suite 7050  
Minneapolis, MN 55415  
p: 612.332.7522



SUBMITTAL  
BID DOCUMENTS

## BOHEMIAN FLATS OAK SAVANNA RESTORATION

MINNEAPOLIS, MN

I hereby certify that this document was prepared by me or under my direct supervision and that I am a duly licensed Landscape Architect under the laws of the State of Minnesota.

Name Thomas Whitlock

Registration# 26292

Signature Tom Whitlock Date 04/21/2023

DFJ Project # 22-172a

Scale VARIES

Drawn/Checked JMR/MR

REVISION --

## LANDSCAPE NOTES

# L001

**MATERIALS SCHEDULE**

| FENCE & GUARDRAIL |  |        |   |                                     |                                   |   |   |
|-------------------|--|--------|---|-------------------------------------|-----------------------------------|---|---|
| SYMBOL            | DESCRIPTION  | DETAIL | MATERIAL PROFILE/ASSEMBLY   | PRODUCT/MODEL                       | COLOR/FINISH                      | COMMENTS  |   |
| FE-01             | FENCE TYPE 1   | 3/L501 | 3-RAIL WOOD FENCE   | CUSTOM                              | TREATED WOOD, UNFINISHED          | PROVIDE GATE PER SPECIFICATIONS, LOCATION TO BE DETERMINED ON SHOP DRAWINGS |   |
| FE-02             | FENCE TYPE 2- TEMP. VEGETATION PROTECTION FENCE          | 5/L500 | 36" H WELDED WIRE FENCE W/ STEEL POSTS  | CUSTOM                              | GALVANIZED                        |   |   |
| LANDSCAPE AMENITY |  |        |   |                                     |                                   |   |   |
| SYMBOL            | DESCRIPTION  | DETAIL | MATERIAL PROFILE  | MANUFACTURER                        | PRODUCT/MODEL                     | COLOR/FINISH  | COMMENTS  |
| LA-01             | LIMESTONE BOULDER  | 4/L500 | 24-36" DIA+ BOULDER   | REGIONAL SOURCE                     | LIMESTONE                         | BUFF  | NATURAL CLEFT, ALL FACES  |
| MINERAL MULCH     |  |        |   |                                     |                                   |   |   |
| SYMBOL            | DESCRIPTION  | DETAIL | MATERIAL PROFILE/ASSEMBLY   | PRODUCT/MODEL                       | COLOR/FINISH                      | COMMENTS  |   |
| MM-01             | MINERAL MULCH TYPE 1                                     | 1/L501 | 4" MIN DEPTH ROUNDED WASHED 1 1/2"-3" RIVER ROCK CHANNEL W/ 6-12" RIVER ROCK & 12-18" LIMESTONE BOULDER CHANNEL EDGES | REGIONAL SOURCE                     | NATURAL, APPROVED BY LA           | SEE DETAIL FOR PROFILE  |   |
| PAVING            |  |        |   |                                     |                                   |   |   |
| SYMBOL            | DESCRIPTION  | DETAIL | MATERIAL PROFILE/ASSEMBLY   | PRODUCT/MODEL                       | COLOR/FINISH                      | COMMENTS  |   |
| P-01              | PAVING TYPE 01 - CONCRETE SPEC: 32 13 13 CONCRETE PAVING | 4/L501 | 4" THK. CONCRETE OVER 6" COMPACTED BASE   | PLC CONCRETE                        | STANDARD GREY, LIGHT BROOM FINISH |   |   |
| SITE FURNITURE    |  |        |   |                                     |                                   |   |   |
| SYMBOL            | DESCRIPTION  | DETAIL | MATERIAL PROFILE/ASSEMBLY   | MANUFACTURER                        | PRODUCT/MODEL                     | COLOR/FINISH  | COMMENTS  |
| SF-01             | LIMESTONE BOULDER BENCH                                  | 4/L500 | LIMESTONE BOULDER SEATING ELEMENT- ~4-6' L X ~18-24"H X 18" D MIN   | REGIONAL SOURCE                     |                                   | NATURAL/ BUFF, NATURAL CLEFT/ SPLIT FLAT TOP WITH NATURAL CLEFT SIDES       | INSTALL ON COMPACTED AGGREGATE BASE, BURY BOTTOM 2". BOULDERS TO BE FIELD-SELECTED BY LA                              |
| SF-02             | PICNIC TABLE   |        | PICNIC TABLE  | COLUMBIA CASCADE, OR APPROVED EQUAL | 2164-8 AND 2165-6                 | BLACK POWDERCOAT FRAME, DOUG FIR SLATS                                      | PROVIDE STANDARD MODEL 2164 IN LAWN, PROVIDE ADA ACCESSIBLE MODEL 2165 LOCATED ON CONCRETE PAD. 1 QTY EACH, 8' LENGTH |



310 South 4th Avenue, Suite 7050  
 Minneapolis, MN 55415  
 p: 612.332.7522



SUBMITTAL  
 BID DOCUMENTS

**BOHEMIAN  
 FLATS  
 OAK SAVANNA  
 RESTORATION**

MINNEAPOLIS, MN

I hereby certify that this document was prepared by me or under my direct supervision and that I am a duly licensed Landscape Architect under the laws of the State of Minnesota.

Name Thomas Whitlock  
 Registration# 26292  
 Signature Tom Whitlock Date 04/21/2023

DFJ Project # 22-172a  
 Scale VARIABLE  
 Drawn/Checked JMR/MR

| REVISION |  |
|----------|--|
|          |  |
|          |  |
|          |  |
|          |  |

**SCHEDULES**

**L010**

**PLANT SCHEDULE**

| TREES  | CODE | QTY | BOTANICAL / COMMON NAME  | SIZE         | CONT.     | REMARKS    |
|--------|------|-----|--|--------------|-----------|------------|
|        | AL   | 3   | AMELANCHIER LAEVIS ALLEGHENY SERVICEBERRY                        | 8' HT. CLUMP | B&B       |            |
|        | PD   | 5   | POPULUS DELTOIDES 'SIOUXLAND' EASTERN COTTONWOOD SIOUXLAND       | 2.5" CAL.    | B&B       |            |
|        | PA   | 15  | PRUNUS AMERICANA AMERICAN PLUM                                   | #10          | CONT.     | 1" CAL     |
|        | PW   | 2   | PRUNUS SEROTINA BLACK CHERRY                                     | #15          | CONT/ BAG | ~1.25" CAL |
|        | PV   | 13  | PRUNUS VIRGINIANA CHOKECHERRY                                    | #15          | CONT/ BAG | 1.25" CAL  |
|        | QB   | 3   | QUERCUS BICOLOR SWAMP WHITE OAK                                  | 2.5" CAL.    | B&B       |            |
|        | QM1  | 2   | QUERCUS MACROCARPA BUR OAK                                       | 1" CAL.      | BARE ROOT |            |
|        | QM2  | 5   | QUERCUS MACROCARPA BUR OAK                                       | 2.5" CAL.    | B&B       |            |
|        | QM4  | 6   | QUERCUS MACROCARPA BUR OAK                                       | 4" CAL.      | B&B       |            |
|        | QC   | 3   | QUERCUS MUEHLENBERGII CHINKAPIN OAK                              | 2" CAL.      | B&B       |            |
|        | QR1  | 2   | QUERCUS RUBRA RED OAK  | 1" CAL.      | BARE ROOT |            |
|        | QR2  | 3   | QUERCUS RUBRA RED OAK  | 2.5" CAL.    | B&B       |            |
|        | QV1  | 2   | QUERCUS VELUTINA BLACK OAK                                       | 1" CAL.      | BARE ROOT |            |
|        | QV2  | 2   | QUERCUS VELUTINA BLACK OAK                                       | 2" CAL.      | B&B       |            |
|        | TA   | 2   | TILIA AMERICANA AMERICAN LINDEN                                  | 3" CAL.      | B&B       |            |
|        | UO   | 2   | ULMUS AMERICANA 'LEWIS & CLARK' PRAIRIE EXPEDITION® AMERICAN ELM | 2.5" CAL.    | B&B       |            |
| SHRUBS | CODE | QTY | BOTANICAL / COMMON NAME  | SIZE         | CONT.     | REMARKS    |
|        | AC   | 7   | AMORPHA CANESCENS LEADPLANT                                      | #5           |           |            |
|        | AF   | 11  | AMORPHA FRUTICOSA FALSE INDIGO                                   | #5           |           |            |
|        | BA   | 12  | BAPTISIA AUSTRALIS BLUE WILD INDIGO                              | #2           |           |            |
|        | CR   | 5   | CORNUS RACEMOSA GRAY DOGWOOD                                     | #5           |           |            |
|        | CS   | 7   | CORNUS SERICEA RED TWIG DOGWOOD                                  | #5           |           |            |
|        | CA   | 23  | CORYLUS AMERICANA AMERICAN HAZELNUT                              | #5           |           |            |
|        | RG   | 12  | RHUS GLABRA SMOOTH SUMAC   | #5           |           |            |
|        | SY   | 10  | SYMPHORICARPOS OCCIDENTALIS WESTERN SNOWBERRY                    | #5           |           |            |

| SHRUB AREAS  | CODE | QTY        | BOTANICAL / COMMON NAME                           | SIZE | CONT. | REMARKS   |
|--------------|------|------------|---|------|-------|---|
|              |      | 8,275 SF   | STORMWATER SEEDING AND PLANTING                   |      |       | SEEDED INFILTRATION / FILTER STRIP WITH PLANTED PERENNIAL AT STRATEGIC LOCATIONS FOR SCREENING & VISUAL INTEREST. PROVIDE COVER CROP -SPRING SEEDING: OATS AT 25 LBS/AC -FALL SEEDING (AUG 1 - OCT 15): WINTER WHEAT AT 25 LBS/ACRE |
|              | AI   | 43         | ASCLEPIAS INCARNATA SWAMP MILKWEED                | PLUG |       |   |
|              | EJ   | 43         | EUPATORIUM MACULATUM JOE PYE WEED                 | PLUG |       | TALL- LOCATE ON INTERIOR  |
|              | FQ   | 43         | FILIPENDULA RUBRA QUEEN-OF-THE-PRAIRIE            | PLUG |       |   |
|              | HF   | 43         | HELIOPSIS HELIANTHOIDES FALSE SUNFLOWER           | PLUG |       | TALL- LOCATE ON INTERIOR  |
|              | LG   | 43         | LIATRIS PYCNOSTACHYA GAYFEATHER                   | PLUG |       |   |
|              | SC   | 43         | SILPHIUM PERFOLIATUM CUP PLANT                    | PLUG |       |   |
|              | SN   | 43         | SYMPHYOTRICHUM NOVAE-ANGLIAE NEW ENGLAND ASTER    | PLUG |       |   |
|              | VF   | 43         | VERNONIA FASCICULATA IRONWEED                     | PLUG |       | TALL- LOCATE ON INTERIOR  |
|              |      | 10,050 SF  | SAVANNA PLUGS COMPRISED OF THE FOLLOWING SPECIES: |      |       | PLANTED IN SINGLE SPECIES MASSES  |
|              | AP   | 233        | ANEMONE PATENS PASQUE FLOWER                      | PLUG |       |   |
|              | AT   | 117        | ASCLEPIAS TUBEROSA BUTTERFLY MILKWEED             | PLUG |       |   |
|              | BB   | 117        | BAPTISIA ALBA WHITE WILD INDIGO                   | PLUG |       |   |
|              | CP   | 117        | COREOPSIS PALMATA STIFF TICKSEED                  | PLUG |       |   |
|              | EC   | 117        | ECHINACEA PALLIDA PALE PURPLE CONEFLOWER          | PLUG |       |   |
|              | GT   | 233        | GEUM TRIFLORUM PRAIRIE SMOKE                      | PLUG |       |   |
|              | LG2  | 117        | LIATRIS PYCNOSTACHYA GAYFEATHER                   | PLUG |       |   |
|              | SL   | 117        | SILPHIUM LACINIATUM COMPASS PLANT                 | PLUG |       |   |
|              | SO   | 117        | SYMPHYOTRICHUM OOIENTANGIENSE SKY BLUE ASTER      | PLUG |       |   |
|              | TO   | 117        | TRADESCANTIA OHIENSIS OHIO SPIDERWORT             | PLUG |       |   |
|              | ZA   | 117        | ZIZIA AUREA GOLDEN ALEXANDER                      | PLUG |       |   |
| SEEDED AREAS | CODE | QTY        | BOTANICAL / COMMON NAME                           | SIZE | CONT. | REMARKS   |
|              | SM1  | 182,818 SF | NATIVE SEED MIX- TYPE 1                           | SEED |       | SSNS SAVANNA & WOODLAND EDGE MIX SEEDED AT 20 LBS/AC- SEE SPECIFICATIONS FOR MIX COMPOSITION *SEED AT INCREASED SEEDING RATE TO SUPPORT SEED BANK CREATION PROVIDE COVER CROP -SPRING SEEDING: OATS AT 25 LBS/AC                    |
|              | SM2  | 6,951 SF   | NATIVE SEED MIX- TYPE 2                           | SEED |       | SSNS DETENTION BASIN/ RAIN GARDEN MIX SEEDED AT 12 LBS/ ACRE* - SEE SPECIFICATIONS FOR MIX COMPOSITION *SEED AT INCREASED SEEDING RATE TO SUPPORT SEED BANK CREATION  |

**PLANTING NOTES:**

- REFER TO L500 FOR PLANTING DETAILS
- REFER TO L001, L160, L161 FOR PLANTING NOTES.



310 South 4th Avenue, Suite 7050  
Minneapolis, MN 55415  
p: 612.332.7522



SUBMITTAL  
BID DOCUMENTS

**BOHEMIAN  
FLATS  
OAK SAVANNA  
RESTORATION**

MINNEAPOLIS, MN

I hereby certify that this document was prepared by me or under my direct supervision and that I am a duly licensed Landscape Architect under the laws of the State of Minnesota.

Name Thomas Whitlock  
Registration# 26292

Signature Tom Whitlock Date 04/21/2023

DF/ Project # 22-172a

Scale VARIES

Drawn/Checked JMR/MR

REVISION --

**SCHEDULES**

**L011**

**LEGEND**

| FENCE & GUARDRAIL |   |        |
|-------------------|---|--------|
| SYMBOL            | DESCRIPTION   | DETAIL |
| [FE-01]           | FENCE TYPE 1  | 2/L501 |
| LANDSCAPE AMENITY |   |        |
| SYMBOL            | DESCRIPTION   | DETAIL |
| [LA-01]           | LIMESTONE BOULDER   | 4/L500 |
| MINERAL MULCH     |   |        |
| SYMBOL            | DESCRIPTION   | DETAIL |
| [MM-01]           | MINERAL MULCH TYPE 1  | 1/L501 |
| PAVING            |   |        |
| SYMBOL            | DESCRIPTION   | DETAIL |
| [P-01]            | PAVING TYPE 01 - CONCRETE<br>SPEC: 32 13 13 CONCRETE PAVING | 3/L501 |
| SITE FURNITURE    |   |        |
| SYMBOL            | DESCRIPTION   | DETAIL |
| [SF-01]           | LIMESTONE BOULDER BENCH                                     | 4/L500 |
| [SF-02]           | PICNIC TABLE  | --     |

**NOTES**

- REFER TO L105 & L106 FOR EROSION CONTROL NOTES & DETAILS, AND FOR TEMPORARY VEGETATION PROTECTION FENCE (FE-02).
- CONTRACTOR SHALL USE PRECAUTION AND PROTECT EXISTING TREES ON SITE. WORK WITHIN DRIPLINE OF EXISTING TREES SHALL BE LIMITED TO SITE PREPARATION & REVEGETATION. NO STAGING, ACCESS, OR HEAVY EQUIPMENT WORK IS PERMITTED WITHIN THE DRIPLINE OF EXISTING TREES. CONTRACTOR SHALL BE RESPONSIBLE FOR ANY DAMAGE TO EXISTING TREES.
- MPRB FORESTRY LOT IS AN ACTIVE TREE NURSERY FROM APRIL THROUGH JUNE. NOTIFY OWNER MIN 72HRS IN ADVANCE OF DELIVERIES OR STAGING. STAGING AND ACCESS MAY REQUIRE COORDINATION WITH FORESTRY OPERATIONS DURING GROWING SEASON.
- LIMIT ACCESS AND STAGING TO EXISTING LOT ONLY. EXISTING SIDEWALK IS NOT AVAILABLE FOR ACCESS OR STAGING AND SHALL BE KEPT OPEN AND CLEAR OF CONSTRUCTION TRAFFIC AND DEBRIS.
- TRAILS, ADA PICNIC AREA, TREE, AND BOULDER LOCATIONS TO BE STAKED BY CONTRACTOR AND REVIEWED/APPROVED BY LANDSCAPE ARCHITECT PRIOR TO INSTALLATION.
- CAD FILE IS AVAILABLE TO SUPPORT STAKING AND LOCATING OF SITE IMPROVEMENTS.

**01 ADA PICNIC TABLE AREA ENLARGEMENT**  
1:10

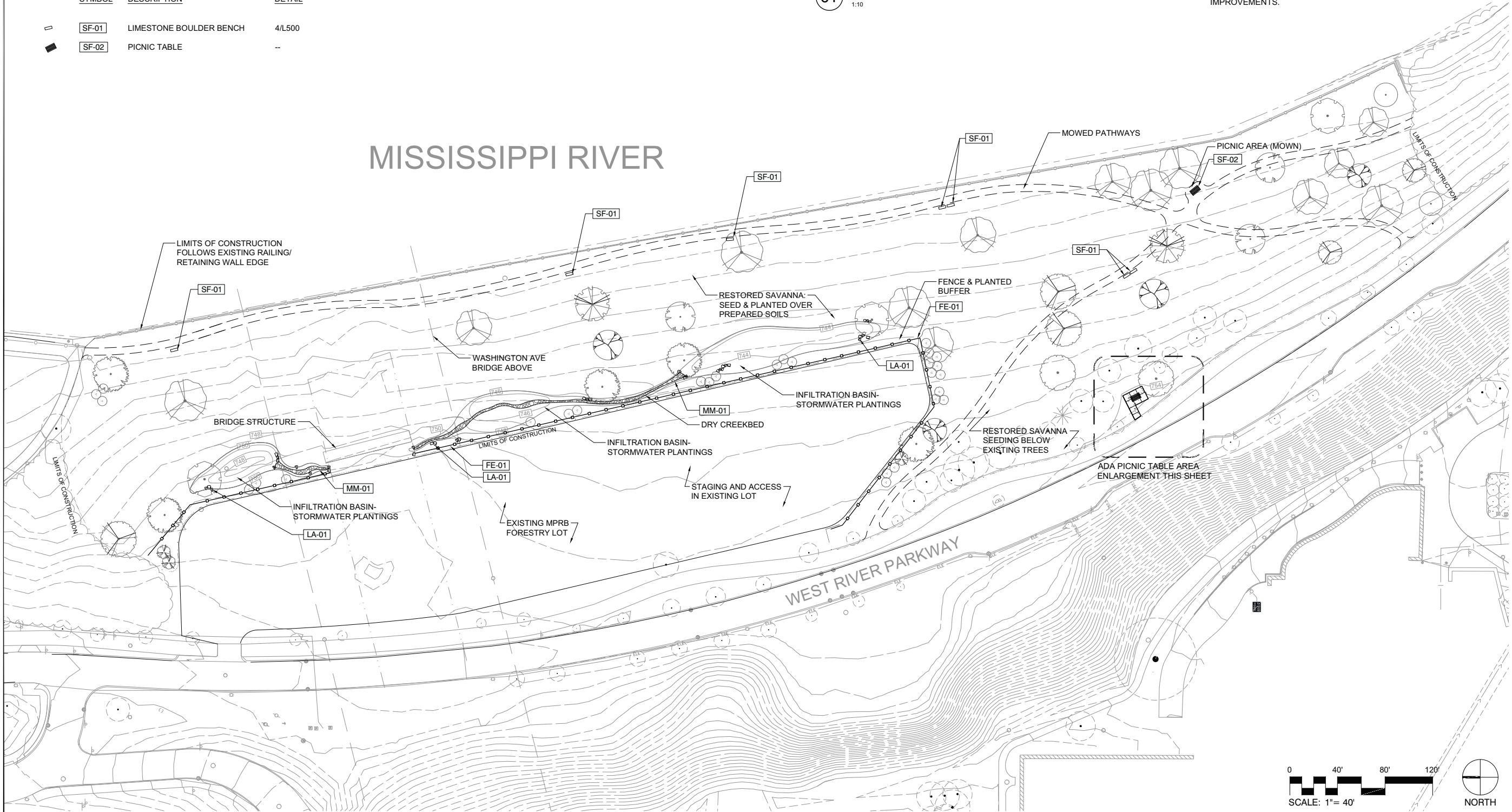

310 South 4th Avenue, Suite 7050  
Minneapolis, MN 55415  
p: 612.332.7522



SUBMITTAL  
BID DOCUMENTS

**BOHEMIAN FLATS  
OAK SAVANNA  
RESTORATION**

MINNEAPOLIS, MN

I hereby certify that this document was prepared by me or under my direct supervision and that I am a duly licensed Landscape Architect under the laws of the State of Minnesota.

Name: Thomas Whitlock  
Registration#: 26292  
Signature: [Signature] Date: 04/21/2023

DF/ Project #: 22-172a  
Scale: VARIES  
Drawn/Checked: JMR/MR

| REVISION |  |
|----------|--|
|          |  |
|          |  |
|          |  |

**SITE & MATERIALS PLAN**

**L100**

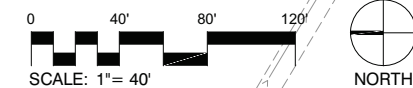

**NOTES**

- CONTRACTOR WILL PLACE SILT FENCE PRIOR TO ANY WORK ON SITE. EROSION CONTROL BMPs WILL REMAIN IN PLACE UNTIL ALL DISTURBED AREAS ARE STABILIZED.
- REFER TO L106 FOR EROSION CONTROL NOTES.
- REFER TO PLANTING PLAN, L161 FOR FINAL STABILIZATION.
- LANDSCAPE ARCHITECT TO REVIEW AND APPROVE FINAL GRADING OF CREEKBED AND INFILTRATION BASINS IN FIELD PRIOR TO REVEGETATION & PLANTING.
- EXTERIOR PORTION OF FE-01 FENCING TO BE INSTALLED IMMEDIATELY AFTER, OR BEFORE IF PRACTICAL, NATIVE SEED IS SOWN.
- INTERIOR PORTIONS OF FE-01 TO BE INSTALLED AFTER FIRST SEASON OF GROWTH. LOCATION OF INTERIOR FE-01 PORTION SHALL BE DIRECTED BY LANDSCAPE ARCHITECT OR OWNER. INTERIOR PORTIONS SHALL BE PLACED 12' APART AND CONTRACT SHALL MOW PATH BETWEEN, AT LEAST 6' IN WIDTH.
- PATHWAY SHALL BE MOWED TO A HEIGHT OF 2-3", SUITABLE FOR FOOT TRAFFIC THROUGH REMAINING DURATION OF ESTABLISHMENT PERIOD. MOWING SHALL OCCUR A MINIMUM OF 1X MONTH DURING THE GROWING SEASON OR WHEN VEGETATION REACHES A HEIGHT OF 4".

**AREA SUMMARY**

|   |           |          |
|---|-----------|----------|
| MAXIMUM DISTURBED AREA                            | 4.3 ACRES |          |
| (DISTURBED AREA INCLUDES AREA WITHIN WORK LIMITS) |           |          |
|   | EXISTING  | PROPOSED |
| IMPERVIOUS SURFACE                                | 0 SF      | 300 SF   |

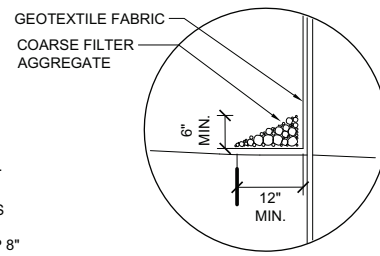

- NOTES:**
- COARSE FILTER AGGREGATE (MNDOT SPEC. 3149) SHALL BE INCIDENTAL.
  - TO PROTECT AREAS FROM SHEET FLOW, MAXIMUM CONTRIBUTING AREA: 1 ACRE.
  - DOUBLE SILT FENCE IS REQUIRED WHEN EARTH IS DISTURBED WITHIN 50 FOOT OF ANY SURFACE WATER. **INSTALL TWO ROWS OF SILT FENCE AT LEAST FIVE FEET APART.**
  - ENSURE SOIL PREPARATION, WEED REMOVAL, AND SEEDING OCCURS BETWEEN ROWS OF SILT FENCE

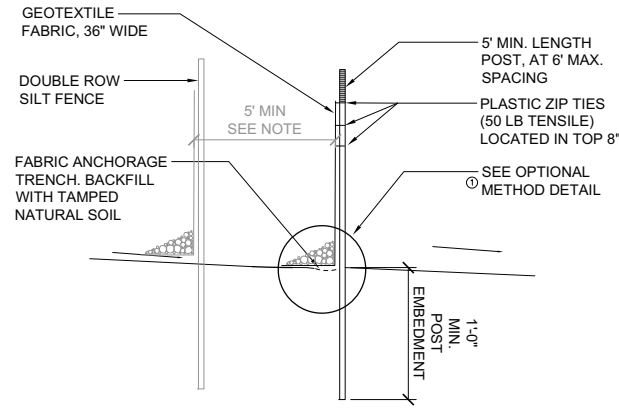

**1** DOUBLE ROW SILT FENCE- HAND INSTALLED  
1 1/2" = 1'-0"

P-22.172A-01

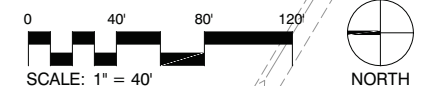
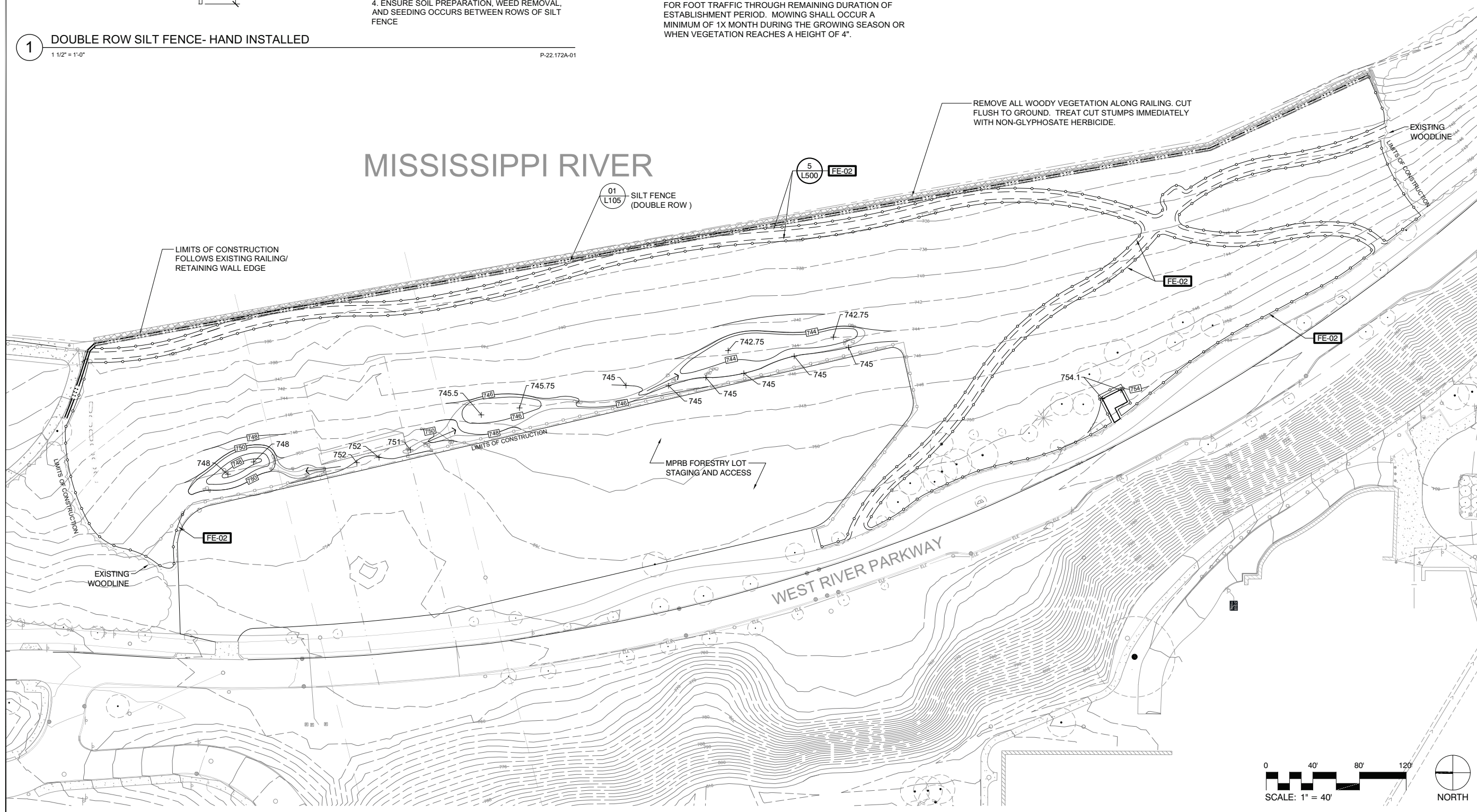

310 South 4th Avenue, Suite 7050  
Minneapolis, MN 55415  
p: 612.332.7522



SUBMITTAL  
BID DOCUMENTS

**BOHEMIAN  
FLATS  
OAK SAVANNA  
RESTORATION**

MINNEAPOLIS, MN

I hereby certify that this document was prepared by me or under my direct supervision and that I am a duly licensed Landscape Architect under the laws of the State of Minnesota.

Name Thomas Whitlock  
Registration# 26292  
*Tom Whitlock* 04/21/2023  
Signature Date

DFJ Project # 22-172a  
Scale VARIES  
Drawn/Checked JMR/MR

|          |  |
|----------|--|
| REVISION |  |
|          |  |
|          |  |
|          |  |

**GRADING &  
EROSION  
CONTROL  
-SWPPP**

**L105**

**PROJECT LOCATION & DESCRIPTION**

BOHEMIAN FLATS OAK SAVANNA STORM WATER POLLUTION PREVENTION PLAN (SWPPP) IS LOCATED AT WEST OF WEST RIVER PARKWAY AND BELOW THE WASHINGTON AVENUE BRIDGE IN MINNEAPOLIS, MN, IN HENNEPIN COUNTY, MN. THIS PROJECT WILL INSTALL STORMWATER BMPs AND RESTORE NATIVE VEGETATION.

AREA DISTURBED IS GREATER THAN 1 ACRE AND INCLUDES REMOVAL OF EXISTING TURF, SOIL DECOMPACTION, AND VEGETATION RESTORATION .

POTENTIAL POLLUTANTS GENERATED FROM THIS WORK INCLUDE THE FOLLOWING: STONE DUSTS AND SOIL SEDIMENTS.

**RECEIVING SURFACE WATERS AND ENVIRONMENTALLY SENSITIVE AREAS:**

THE RECEIVING WATER FOR STORM WATER RUNOFF FROM THIS PROJECT IS THE MISSISSIPPI RIVER. THE MISSISSIPPI RIVER IS AN IMPAIRED WATER BODY.

**SOIL TYPES:**

NO SOIL BORINGS HAVE BEEN PERFORMED. EXISTING TOPSOIL SAMPLES WERE TAKEN FROM PROJECT SITE AND ARE AVAILABLE FOR REVIEW. WEB SOIL SURVEY INDICATES URBAN LAND-UDORTHTENTS

**INVASIVE SPECIES:**

IF NOXIOUS WEEDS FROM THE MN DEPARTMENT OF AGRICULTURE NOXIOUS WEED LIST ARE OBSERVED, NOTIFY THE PROJECT MANAGER FOR DIRECTION BEFORE REMOVING.

**LONG TERM MAINTENANCE AND OPERATION**

CONTRACTOR SHALL BE RESPONSIBLE FOR MAINTENANCE WITHIN CONSTRUCTION LIMITS FOR THE DURATION OF CONSTRUCTION & ESTABLISHMENT MAINTENANCE PERIOD. MPRB (MINNEAPOLIS PARK AND RECREATION BOARD) IS RESPONSIBLE FOR LONG-TERM MAINTENANCE.

**PROJECT PERSONNEL AND TRAINING**

CONTRACTOR SHALL PROVIDE A CERTIFIED EROSION CONTROL SUPERVISOR IN GOOD STANDING WHO IS KNOWLEDGEABLE AND EXPERIENCED IN THE APPLICATION OF EROSION PREVENTION AND SEDIMENT CONTROL BEST MANAGEMENT PRACTICES. THE EROSION CONTROL SUPERVISOR WILL WORK WITH THE OWNER / PROJECT ENGINEER TO OVERSEE THE IMPLEMENTATION OF THE SWPPP AND THE INSTALLATION, INSPECTION, AND MAINTENANCE OF THE EROSION PREVENTION AND SEDIMENT CONTROL BMPs BEFORE, DURING, AND AFTER CONSTRUCTION UNTIL THE NOTICE OF TERMINATION (NOT) HAS BEEN FILED WITH THE MPCA. PROVIDE PROOF OF CERTIFICATION AT THE PRE-CONSTRUCTION MEETING. WORK WILL NOT BE ALLOWED TO COMMENCE UNTIL PROOF OF CERTIFICATION HAS BEEN PROVIDED TO THE PROJECT ENGINEER.

PROVIDE AT LEAST ONE CERTIFIED INSTALLER FOR EACH CONTRACTOR OR SUBCONTRACTOR THAT INSTALLS THE PRODUCTS LISTED IN SPECIFICATION SECTION 2573.3.A.2 CERTIFIED INSTALLERS. PROVIDE PROOF OF CERTIFICATION AT THE PRE-CONSTRUCTION MEETING. WORK WILL NOT BE ALLOWED TO COMMENCE UNTIL PROOF OF CERTIFICATION HAS BEEN PROVIDED TO THE PROJECT ENGINEER.

**CHAIN OF RESPONSIBILITY**

THE OWNER AND CONTRACTOR SHALL BE CO-PERMITTEES FOR THE NATIONAL POLLUTANT DISCHARGE ELIMINATION SYSTEM (NPDES) CONSTRUCTION PERMIT. THE CONTRACTOR IS RESPONSIBLE FOR OBTAINING THE NPDES PERMIT. THE CONTRACTOR IS RESPONSIBLE TO COMPLY WITH ALL ASPECTS OF THE NPDES CONSTRUCTION PERMIT AT ALL TIMES UNTIL THE NOTICE OF TERMINATION (NOT) HAS BEEN FILED WITH THE MPCA. THE CONTRACTOR WILL DEVELOP A CHAIN OF COMMAND WITH ALL OPERATORS ON THE SITE TO ENSURE THAT THE SWPPP WILL BE IMPLEMENTED AND STAY IN EFFECT UNTIL THE CONSTRUCTION PROJECT IS COMPLETE. THE ENTIRE SITE HAS UNDERGONE FINAL STABILIZATION, AND A NOTICE OF TERMINATION (NOT) HAS BEEN SUBMITTED TO THE MPCA.

**PROJECT CONTACTS**

THE CONTRACTOR IS RESPONSIBLE FOR IMPLEMENTATION OF THE SWPPP AND INSTALLATION, INSPECTION, AND MAINTENANCE OF THE EROSION PREVENTION AND SEDIMENT CONTROL BMPs BEFORE, DURING, AND AFTER CONSTRUCTION UNTIL THE NOTICE OF TERMINATION (NOT) HAS BEEN FILED. REFER TO COVER PAGE FOR PROJECT CONTACTS.

**SITE INSPECTION AND MAINTENANCE**

CONTRACTOR SHALL PROVIDE NAME, CONTACT INFO, AND TRAINING DOCUMENTATION FOR THE PERSON RESPONSIBLE FOR SWPPP IMPLEMENTATION AND INSPECTION/MAINTENANCE OF BMPs.

INSPECT THE ENTIRE CONSTRUCTION SITE A MINIMUM OF ONCE EVERY SEVEN DAYS DURING ACTIVE CONSTRUCTION AND WITHIN 24 HOURS AFTER A RAINFALL EVENT GREATER THAN 0.5 INCHES WITHIN A 24 HOUR TIME FRAME. INSPECT ALL TEMPORARY AND PERMANENT WATER QUALITY MANAGEMENT, EROSION PREVENTION AND SEDIMENT CONTROL BMPs UNTIL THE SITE HAS UNDERGONE FINAL STABILIZATION AND THE N.O.T. HAS BEEN SUBMITTED. INSPECT SURFACE WATER INCLUDING DRAINAGE DITCHES FOR SIGNS OF EROSION AND SEDIMENT DEPOSITION. INSPECT CONSTRUCTION SITE VEHICLE EXIT LOCATIONS FOR EVIDENCE OF TRACKING ONTO PAVED SURFACES. INSPECT SURROUNDING PROPERTIES FOR EVIDENCE OF OFF SITE SEDIMENT ACCUMULATION.

RECORD ALL INSPECTIONS AND MAINTENANCE ACTIVITIES IN WRITING WITHIN 24 HOURS. SUBMIT INSPECTION REPORTS IN A FORMAT THAT IS ACCEPTABLE TO THE PROJECT ENGINEER. FOR PROJECTS THAT DISCHARGE TO PROHIBITED WATERS, CONDUCT ROUTINE SITE INSPECTIONS AT A MINIMUM OF ONCE EVERY 72 HOURS (3 DAYS). INCLUDE THE FOLLOWING IN THE RECORDS OF EACH INSPECTION AND MAINTENANCE ACTIVITY:

- A. DATE AND TIME OF INSPECTIONS
- B. NAME OF PERSONS CONDUCTING INSPECTIONS
- C. FINDINGS OF INSPECTIONS, INCLUDING RECOMMENDATIONS FOR CORRECTIVE ACTIONS
- D. CORRECTIVE ACTION TAKEN, INCLUDING DATES, TIMES, AND PARTY COMPLETING MAINTENANCE ACTIVITIES
- E. DATE AND AMOUNT OF ALL RAINFALL EVENTS GREATER THAN 0.5 INCH IN 24 HOURS
- F. DOCUMENTS AND CHANGES MADE TO THE SWPPP REPLACE, REPAIR OR SUPPLEMENT ALL NONFUNCTIONAL BMPs BY IN THE TIME PROVIDED BELOW:
  - A. REPAIR, REPLACE, OR SUPPLEMENT PERIMETER CONTROL DEVICES WHEN IT BECOMES NONFUNCTIONAL OR SEDIMENT REACHES 1/2 THE HEIGHT OF THE DEVICE. COMPLETE REPAIRS BY: THE END OF THE NEXT BUSINESS DAY FOLLOWING DISCOVERY.
  - B. REPAIR OR REPLACE INLET PROTECTION DEVICES (IF APPLICABLE) WHEN THEY BECOME NONFUNCTIONAL OR SEDIMENT REACHES 1/2 THE HEIGHT AND/OR DEPTH OF THE DEVICE. COMPLETE REPAIRS BY THE END OF THE NEXT BUSINESS DAY FOLLOWING DISCOVERY.
  - C. DRAIN AND REMOVE SEDIMENT FROM TEMPORARY AND PERMANENT SEDIMENT BASINS ONCE THE SEDIMENT HAS REACHED 1/2 THE STORAGE VOLUME. COMPLETE WORK WITHIN 72 HOURS OF DISCOVERY.
  - D. REMOVE ALL DELTAS AND SEDIMENT DEPOSITED IN SURFACE WATER INCLUDING DRAINAGE WAYS, CATCH BASINS, AND OTHER DRAINAGE SYSTEMS. RESTABILIZED ANY AREAS THAT ARE DISTURBED BY SEDIMENT REMOVAL OPERATION. SEDIMENT REMOVAL AND STABILIZATION MUST BE COMPLETED WITHIN 7 DAYS OF DISCOVERY. PREPARE AND SUBMIT A SITE MANAGEMENT PLAN FOR WORKING IN SURFACE WATERS.
  - E. REMOVE TRACKED SEDIMENT FROM PAVED SURFACES BOTH ON AND OFF SITE WITHIN 24 HOURS OF DISCOVERY. STREET SWEEPING MAY HAVE TO OCCUR MORE OFTEN TO MINIMIZE OFF SITE IMPACTS. LIGHTLY WET THE PAVEMENT PRIOR TO SWEEPING
  - F. MAINTAIN ALL BMPs UNTIL WORK HAS BEEN COMPLETED, SITE HAS GONE UNDER FINAL STABILIZATION, AND THE NOTICE OF TERMINATION (NOT) HAS BEEN SUBMITTED TO THE MPCA.

**LOCATION OF SWPPP REQUIREMENTS**

THE REQUIRED SWPPP ELEMENTS MAY BE LOCATED IN MANY PLACES WITHIN THE PLAN SET.

**TIMING OF BMP INSTALLATION:**

DISTURBED, EXPOSED SOILS MUST BE STABILIZED IMMEDIATELY BY SEEDING AND MULCHING AND/OR RIPRAP WITH FILTER FABRIC IF THE SOILS ARE NOT TO BE WORKED WITHIN 24 HOURS (INCLUDING WEEKENDS AND HOLIDAYS).

**A SITE PLAN DETAILING PROPOSED EROSION CONTROL AND SEDIMENT CONTROL MEASURES AND A SCHEDULE INDICATING STARTING AND COMPLETION TIMES FOR CONSTRUCTION OPERATIONS SHALL BY SUBMITTED TO LANDSCAPE ARCHITECT BY THE CONTRACTOR. THE CONTRACTOR SHALL NOT START WORK UNTIL THE SCHEDULE AND SITE PLAN HAVE BEEN ACCEPTED.**

**GENERAL SWPPP NOTES FOR CONSTRUCTION ACTIVITY**

1. CONTRACTOR SHALL AMEND THE SWPPP AND DOCUMENT ANY AND ALL CHANGES TO THE SWPPP AND ASSOCIATED PLAN SHEETS WITHIN 7 DAYS UPON IMPLEMENTATION. STORE THE SWPPP AND ALL AMENDMENTS ON SITE AT ALL TIMES.
2. PREPARE AND SUBMIT A SITE MANAGEMENT PLAN FOR THE ENGINEER'S ACCEPTANCE FOR CONCRETE MANAGEMENT, CONCRETE SLURRY APPLICATION AREAS, WORK IN AND NEAR AREAS OF ENVIRONMENTAL SENSITIVITY, AREAS IDENTIFIED IN THE PLANS AS "SITE MANAGEMENT PLAN AREA", ANY WORK THAT WILL REQUIRE DEWATERING, AND AS REQUESTED BY THE ENGINEER. SUBMIT ALL SITE MANAGEMENT PLANS TO THE ENGINEER IN WRITING. ALLOW ALL MINIMUM OF 7 DAYS FOR THE ENGINEER TO REVIEW AND ACCEPT SITE MANAGEMENT PLAN SUBMITTALS. WORK WILL NOT BE ALLOWED TO COMMENCE IF A SITE MANAGEMENT PLAN IS REQUIRED UNTIL ACCEPTANCE HAS BEEN GRANTED BY THE ENGINEER. THERE WILL BE NO EXTRA TIME ADDED TO THE CONTRACT DUE TO THE UNTIMELY SUBMITTAL.
3. IT IS THE DESIGNER'S INTENT THAT THE CONTRACTOR INSTALL EROSION CONTROL BMPs BEFORE PUTTING THEM INTO ACTIVE SERVICE TO THE MAXIMUM EXTENT PRACTICABLE.
4. BURNING OF ANY MATERIAL IS NOT ALLOWED WITHIN PROJECT BOUNDARY.
5. DO NOT DISTURB AREAS OUTSIDE OF THE CONSTRUCTION LIMITS. DELINEATE AREAS NOT TO BE DISTURBED PRIOR TO STARTING GROUND DISTURBING ACTIVITIES. IF IT BECOMES NECESSARY TO DISTURBED AREAS OUTSIDE OF THE CONSTRUCTION LIMITS OBTAIN WRITTEN PERMISSION FROM THE PROJECT ENGINEER PRIOR TO PROCEEDING. PRESERVE ALL NATURAL BUFFERS SHOWN ON THE PLANS.
6. ROUTE STORMWATER AROUND UNSTABILIZED AREAS OF THE SITE WHENEVER FEASIBLE. PROVIDE EROSION CONTROL AND VELOCITY DISSIPATION DEVICES AS NEEDED TO KEEP CHANNELS FROM ERODING AND TO PREVENT NUISANCE CONDITIONS AT THE OUTLET.
7. DIRECT DISCHARGES FROM BMPs TO VEGETATED AREA WHENEVER FEASIBLE. PROVIDE VELOCITY DISSIPATION DEVICES AS NEEDED TO PREVENT EROSION.
8. THE EROSION PREVENTION AND SEDIMENT CONTROL BMPs SHALL BE PLACED AS NECESSARY TO MINIMIZE EROSION FROM DISTURBED SURFACES AND TO CAPTURE SEDIMENT ON SITE. ALL EROSION CONTROL MEASURES SHALL BE IN PLACE PRIOR TO COMMENCEMENT OF ANY REMOVAL WORK AND/OR GROUND DISTURBING ACTIVITIES COMMENCE.
9. ESTABLISH SEDIMENT CONTROL DEVICES ON ALL DOWN GRADIENT PERIMETERS AND UP GRADIENT OF ANY BUFFER ZONES BEFORE AND UP GRADIENT LAND DISTURBING ACTIVITIES BEGIN. MAINTAIN SEDIMENT CONTROL DEVICES UNTIL CONSTRUCTION IS COMPLETE AND THE SITE IS STABILIZED.
10. LOCATE PERIMETER CONTROL ON THE CONTOUR TO CAPTURE OVERLAND, LOW-VELOCITY SHEET FLOWS DOWN GRADIENT OF ALL EXPOSED SOILS AND PRIOR TO DISCHARGING TO SURFACE WATERS. PLACE J-HOOKS AT A MAXIMUM OF 100 FOOT INTERVALS.
11. PLACE CONSTRUCTION EXITS, AS NECESSARY, TO PREVENT TRACKING OF SEDIMENT ONTO PAVED SURFACES BOTH ON AND OFF THE PROJECT SITE. PROVIDE CONSTRUCTION EXITS OF SUFFICIENT SIZE TO PREVENT TRACK OUT. MAINTAIN CONSTRUCTION EXITS WHEN EVIDENCE OF TRACKING IS DISCOVERED. REGULAR STREET SWEEPING IS NOT AN ACCEPTABLE ALTERNATIVE TO PROPER CONSTRUCTION EXIT INSTALLATION AND MAINTENANCE. CONSTRUCTION EXITS ARE INCIDENTAL.
12. DISCHARGE TURBID OR SEDIMENT LADEN WATER TO TEMPORARY SEDIMENT BASINS WHENEVER FEASIBLE. IN THE EVENT THAT IT IS NOT FEASIBLE TO DISCHARGE THE SEDIMENT LADEN WATER TO A TEMPORARY SEDIMENT BASIN, THE WATER MUST BE TREATED SO THAT IT DOES NOT CAUSE A NUISANCE CONDITION IN THE RECEIVING WATERS OR TO DOWNSTREAM LANDOWNERS. CLEAN OUT ALL PERMANENT STORMWATER BASINS REGARDLESS OF WHETHER USED AS TEMPORARY SEDIMENT BASINS OR TEMPORARY SEDIMENT TRAPS TO THE DESIGN CAPACITY AFTER ALL UP GRADIENT LAND DISTURBING ACTIVITY IS COMPLETED.

**EROSION CONTROL MEASURES:**

THE CONTRACTOR IS RESPONSIBLE FOR MINIMIZING SOIL EROSION AND PREVENTING DAMAGE TO ADJACENT WETLANDS AND WATERBODIES FROM SEDIMENTATION OVER THE VARIOUS STAGES OF CONSTRUCTION AT SEASONAL TIMES DURING THE YEAR FOR THE DURATION OF THE CONTRACT.

THE CONTRACTOR SHALL PROVIDE APPROPRIATE EROSION CONTROL DEVICES FOR STOCKPILE AREAS (INCIDENTAL). . PLACE BMP A MINIMUM 5 FEET FROM THE TOE OF SLOPE WHERE FEASIBLE. DO NOT PLACE STOCKPILES IN NATURAL BUFFER AREAS, SURFACE WATERS OR STORMWATER CONVEYANCES. STOCKPILING SHALL OCCUR ALONG EDGES OF TRAIL WITHIN LIMITS OF WORK AND BE REUSED TO TIE INTO ADJACENT GRADES PER GRADING PLAN.

PRAIRIE/WETLAND VEGETATION, CONVEYANCE, AND OUTFALLS MUST BE PROTECTED FROM CEMENTITIOUS MATERIALS, SEDIMENTS, AND CHEMICAL CLEANING AGENTS BY AVOIDANCE, USE OF PLASTIC SHEETING, COMPOST FILTER LOGS OR OTHER PROJECT ENGINEER APPROVED METHODS. THE CONTRACTOR SHALL PREVENT DISCHARGE TO SURFACE AND GROUND WATERS BY VACUUM OR SWEEP COLLECTION OF CEMENTITIOUS MATERIALS, CLEANING AGENTS FROM PLASTIC GROUND COVERS, MATS, OR OTHER PROJECT ENGINEER APPROVED METHOD.

RUTS OR DAMAGED VEGETATION THAT COULD CREATE SEDIMENT DISCHARGE TO ADJACENT RIVER AND CONVEYANCE SYSTEMS MUST BE REPAIRED WITHIN 24 HOURS WITH SHAPING, SEEDING AND CERTIFIED WEED FREE STRAW MULCH MATERIALS. EFFORT MUST BE MADE TO PREVENT REOCCURRENCE OF SOIL DISTURBANCE BY PROTECTIVE SOIL COVERS.

TO PROTECT INLETS AND ADJACENT WATER BODIES OVER THE LIFE OF THE CONTRACT, PICKUP (ENCLOSED SKIDSTEER BROOM) SWEEPING OF PAVED SURFACES WILL BE REQUIRED, AS NECESSARY TO KEEP SEDIMENTS, MUD, DIRT, ROCK, OR OTHER MATERIALS FROM LEAVING THE PAVED SURFACE DUE TO RAIN OR VEHICLE TRACKING.

SLOPED GRADES MUST BE PROTECTED. SOIL IN DISTURBED AREAS SHALL BE KEPT IN A PERPETUALLY STABILIZED CONDITION.

SOFT SOIL CROSSING WILL REQUIRE DRIVABLE MATS CAPABLE OF MINIMIZING SOIL DISTURBANCE FOR THE CONTRACTORS' EQUIPMENT. THIS MAY BE ACCOMPLISHED BY USE OF PLYWOOD, MUD MATS, OR STRUCTURAL PLASTIC BASE UNITS.

PERIMETER CONTROL BMPs SHALL BE KEPT IN A FUNCTIONAL CONDITION, REGARDLESS OF NUMBER OF MOVEMENTS TO ACCOMMODATE THE CONTRACTORS OPERATIONS.

TRASH AND CONSTRUCTION DEBRIS SHALL BE PICKED UP AT THE END OF EACH DAY AND PLACED IN DUMPSTER OR OTHER SUITABLE CONTAINERS, AND REMOVED AS NECESSARY TO REMAIN FUNCTIONAL.

**POLLUTION PREVENTION:**

HAZARDOUS MATERIALS SUCH AS OIL AND FUEL MUST BE PROPERLY STORED, INCLUDING SECONDARY CONTAINMENT, TO PREVENT SPILLS, LEAKS, OR OTHER DISCHARGE FROM ENTERING RECEIVING WATERS. RESTRICTED ACCESS TO STORAGE AREAS MUST BE PROVIDED TO PREVENT VANDALISM. STORAGE AND DISPOSAL OF HAZARDOUS WASTE MUST BE IN COMPLIANCE WITH MPCA REGULATIONS. THE CONTRACTOR WILL BE REQUIRED TO SUBMIT A SITE PLAN FOR REFUELING METHODS. REFUELING AREAS MUST BE ON LEVEL GRADE AND LOCATED AT LEAST 45 FEET FROM ADJACENT RIVER. THE CONTRACTOR SHALL MAINTAIN ADEQUATE SUPPLIES OF ABSORBENT SPILL CLEAN-UP MATERIALS AND SPILL KITS IN FUELING AREAS AND ON MOBILE FUELING EQUIPMENT.

CHEMICAL SPILLS SHALL BE IMMEDIATELY PICKED UP, INCLUDING FERTILIZERS AND PORTABLE URINALS. SPILLED MATERIALS SHALL BE PROPERLY DISPOSED OF OR, IN THE CASE OF FERTILIZER, SPREAD ACCORDING TO MANUFACTURERS RECOMMENDATIONS FOR NPK, OR AS INDICATED IN THE TURF RESTORATION PLAN. THERE SHALL BE NO EQUIPMENT WASHING ON SITE UNLESS IN A PREAPPROVED BY THE PROJECT ENGINEER, AND IN A DESIGNATED SITE WITH TOTAL POLLUTION MANAGEMENT PROGRAM THAT PREVENTS AIR, LAND AND WATER POLLUTION.

**FINAL STABILIZATION:**

WITHIN TWO WEEKS OF FINISHED SITE GRADING, DISTURBED AREAS SHALL BE STABILIZED WITH SEED, SOD, MULCH OR ROCK BASE. FINAL STABILIZATION WILL OCCUR WHEN SOIL DISTURBING ACTIVITIES AT THE SITE HAVE BEEN COMPLETED AND SOILS ARE STABILIZED BY A UNIFORM PERENNIAL VEGETATIVE COVER WITH A DENSITY OF 70 PERCENT OF ITS EXPECTED FINAL GROWTH DENSITY OVER THE ENTIRE PVIOUS SURFACE AREA, OR OTHER EQUIVALENT MEANS NECESSARY TO PREVENT SOIL FAILURE UNDER EROSION CONDITIONS; AND

TEMPORARY SYNTHETIC AND STRUCTURAL EROSION PREVENTION AND SEDIMENT CONTROL BMPs (SUCH AS SILT FENCE) HAVE BEEN REMOVED ON THE PORTIONS OF THE SITE FOR WHICH THE CONTRACTOR IS RESPONSIBLE. BMPs DESIGNED TO DECOMPOSE ON SITE (SUCH AS SOME COMPOST LOGS) SHALL BE SPLIT AND THE FABRIC REMOVED.

1. INITIATE INLET STABILIZATION IMMEDIATELY WHEN CONSTRUCTION HAS TEMPORARILY OR PERMANENTLY CEASED ON ANY PORTION OF THE SITE. COMPLETE STABILIZATION WITHIN THE TIME FRAME LISTED. IN MANY INSTANCES THIS WILL REQUIRE STABILIZATION TO OCCUR MORE THAN ONCE DURING THE COURSE OF THE PROJECT. TEMPORARY SOIL STOCKPILES WITHOUT SIGNIFICANT CLAY OR SILT AND STOCKPILED AND CONSTRUCTED ROAD BASE ARE NOT APPROPRIATE AND THEREFORE EXEMPT FROM THE STABILIZATION REQUIREMENT.
2. APPLICATION OF MULCH, HYDROMULCH, TACKIFIER AND POLYACRYLAMIDE ARE NOT ACCEPTABLE STABILIZATION METHODS IN THESE AREAS.
3. STABILIZE ALL AREAS OF THE SITE PRIOR TO THE ONSET OF WINTER, ANY WORK STILL BEING PERFORMED WILL BE SNOW MULCHED, SEEDED, AND BLANKETED WITHIN THE TIME FRAMES IN THE NPDES PERMIT.
4. KEEP DITCHES AND EXPOSED SOILS IN AN EVEN ROUGH GRADED CONDITION IN ORDER TO BE ABLE TO APPLY EROSION CONTROL MULCHES, HYDROMULCHES AND BLANKETS

**DESCRIPTION OF PERMANENT STORMWATER TREATMENT SYSTEMS**

RESTORED PRAIRIE AND EXISTING NATIVE VEGETATION SHALL SERVE AS PERMANENT STORMWATER TREATMENT.

**RECORD RETENTION**

THE SWPPP, ALL CHANGES TO IT AND INSPECTION AND MAINTENANCE RECORDS MUST BE KEPT ON-SITE DURING CONSTRUCTION. THE OWNER MUST RETAIN A COPY OF THE SWPPP ALONG WITH THE FOLLOWING RECORDS FOR THREE (3) YEARS AFTER SUBMITTAL OF THE NOTICE OF TERMINATION (NOT).

1. ANY OTHER PERMITS REQUIRED FOR THE PROJECT.
2. RECORDS OF ALL INSPECTION AND MAINTENANCE CONDUCTED DURING CONSTRUCTION
3. ALL PERMANENT OPERATIONS AND MAINTENANCE AGREEMENT THAT HAVE BEEN IMPLEMENTED INCLUDING ALL RIGHT OF WAY, CONTRACTS, COVENANTS AND OTHER BINDING REQUIREMENTS REGARDING PERPETUAL MAINTENANCE; AND ALL REQUIRED CALCULATIONS FOR DESIGN OF THE TEMPORARY AND PERMANENT STORMWATER MANAGEMENT SYSTEMS.

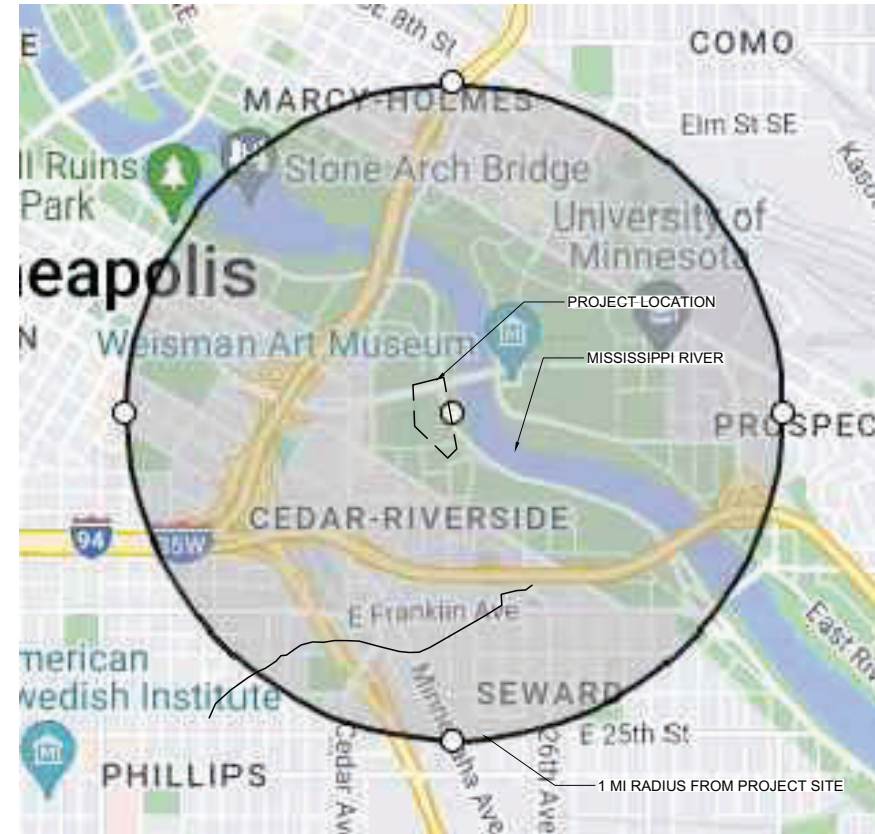

310 South 4th Avenue, Suite 7050  
Minneapolis, MN 55415  
p: 612.332.7522



SUBMITTAL  
BID DOCUMENTS  
-  
-

**BOHEMIAN FLATS OAK SAVANNA RESTORATION**

MINNEAPOLIS, MN

I hereby certify that this document was prepared by me or under my direct supervision and that I am a duly licensed Landscape Architect under the laws of the State of Minnesota.

|               |                     |
|---------------|---------------------|
| Name          | Thomas Whitlock     |
| Registration# | 26292               |
| Signature     | <i>Tom Whitlock</i> |
| Date          | 04/21/2023          |





|               |           |
|---------------|-----------|
| DF/ Project # | 22-172a   |
| Scale         | VARIABLES |
| Drawn/Checked | JMR/MR    |

| REVISION |  |
|----------|--|
|          |  |
|          |  |
|          |  |
|          |  |
|          |  |
|          |  |
|          |  |
|          |  |
|          |  |

**SWPPP NOTES**

**L106**

**LEGEND**

| SYMBOL  | DESCRIPTION   | DEPTH     | COMPOSITION  | NOTES   | PREPARATION  |
|---|---|-----------|--|---|--|
|  | SOIL TYPE 01A - NATIVE SEEDING SOIL<br>SPEC DF- 32 91 13              | 18"       | AMEND INSITU SOILS - NATIVE SEEDING AREA- ADD 1" TOPDRESSING OF BIOCHAR & COMPOST (50/50), BLEND INTO TOP 4" OF SOIL                         | PROVIDE FULLY BIODEGRADABLE EROSION CONTROL BLANKET, HYDROMULCH, OR CERTIFIED WEED-FREE NATIVE STRAW MULCH. | SEE SPECIFICATIONS, PROVIDE DECOMPACTION VIA DEEP TILLING TO DEPTH OF 18"  |
|  | SOIL TYPE 01B- NATIVE SEEDING- DEEP DECOMPACTION<br>SPEC DF- 32 91 13 | 24"       | AMEND INSITU SOILS - NATIVE SEEDING AREA- ADD 1" TOPDRESSING OF BIOCHAR & COMPOST (50/50), BLEND INTO TOP 4" OF SOIL                         | PROVIDE FULLY BIODEGRADABLE EROSION CONTROL BLANKET, HYDROMULCH, OR CERTIFIED WEED-FREE NATIVE STRAW MULCH. | SEE SPECIFICATIONS- PROVIDE DECOMPACTION VIA DEEP TILLING TO DEPTH OF 24"  |
|  | SOIL TYPE 02 - SOIL PREP BELOW EXISTING TREES<br>SPEC DF- 32 91 13    | 1-2"      | AMEND INSITU SOILS - LOW-IMPACT, HAND WORK BELOW TREES, TOP DRESS WITH 1" OF COMPOST.  | PROVIDE FULLY BIODEGRADABLE EROSION CONTROL BLANKET, HYDROMULCH, OR CERTIFIED WEED-FREE NATIVE STRAW MULCH. | SPRAY OUT / SOD CUT EXISTING TURF AND WEEDS (1" DEPTH, USE CAUTION SOD CUTTING BELOW DRIPLINES TO MINIMIZE ROOT DAMAGE). DO NOT SOD CUT WITHIN 6' OF TRUNK OF EXISTING TREES. HAND RAKE SOIL SURFACE- DO NOT TILL. SEE SPECIFICATIONS. DO NOT DISTURB SUBGRADE |
|  | SOIL TYPE 03 - 24" RAIN GARDEN FILTER SOIL<br>SPEC DF- 32 91 13       | 24" (MIN) | IMPORT SOILS -TO MEET REQUIREMENTS OF MNDOT FILTER TOPSOIL BORROW, ADD 1" TOPDRESSING OF BIOCHAR & COMPOST(50/50), BLEND INTO TOP 4" OF SOIL | FULLY BIODEGRADABLE EROSION CONTROL BLANKET, HYDROMULCH, OR CERTIFIED WEED-FREE NATIVE STRAW MULCH.         | SEE SPECIFICATIONS, ENSURE 24" OR MORE DEPTH OF FILTER TOPSOIL FOR FULL WIDTH OF RAIN GARDEN AREA.   |

**NOTES**

- EXISTING SOILS ARE KNOWN TO BE COMPACTED. TILLING WILL BE REQUIRED TO LOOSEN TO DEPTHS SPECIFIED.
- WHERE REGRADING IS TO OCCUR, STOCKPILE EXISTING TOPSOILS FOR REUSE & AMENDMENT. PROTECT STOCKPILES FROM EROSION. DO NOT STOCKPILE TO A HEIGHT GREATER THAN 48".
- PLANT MATERIAL, MULCH, SOILS, AND COMPOST SHALL BE INSPECTED FOR JUMPING WORMS PRIOR TO PLACEMENT AND DISTRIBUTION OF MATERIALS ON SITE. INSPECTION SHALL BE PERFORMED BY LANDSCAPE ARCHITECT. NOTIFY LA MINIMUM OF 48 HRS PRIOR TO MATERIAL ARRIVAL. SEE SPECIFICATIONS FOR SUBMITTAL REQUIREMENTS. JUMPING WORMS ARE AN UNCLASSIFIED INVASIVE SPECIES IN MINNESOTA AND PROVIDE A THREAT TO NATURAL ECOSYSTEMS.
- PROVIDE MYCORRHIZAE INOCULUM IN SEEDING AND PLANTING AREAS - SEE PLANTING PLANS.
- IMPORT BACKFILL FOR TREE AND SHRUB PLANTINGS CONFORMING TO MNDOT LOAM TOPSOIL BORROW.



310 South 4th Avenue, Suite 7050  
Minneapolis, MN 55415  
p: 612.332.7522



SUBMITTAL  
BID DOCUMENTS

**BOHEMIAN  
FLATS  
OAK SAVANNA  
RESTORATION**

MINNEAPOLIS, MN

I hereby certify that this document was prepared by me or under my direct supervision and that I am a duly licensed Landscape Architect under the laws of the State of Minnesota.

Name Thomas Whitlock  
Registration# 26292  
*Tom Whitlock* 04/21/2023  
Signature Date

DF/ Project # 22-172a  
Scale VARIABLES  
Drawn/Checked JMR/MR

| REVISION | DATE |
|----------|------|
|          |      |
|          |      |
|          |      |
|          |      |

**SOILS PLAN**

**L120**

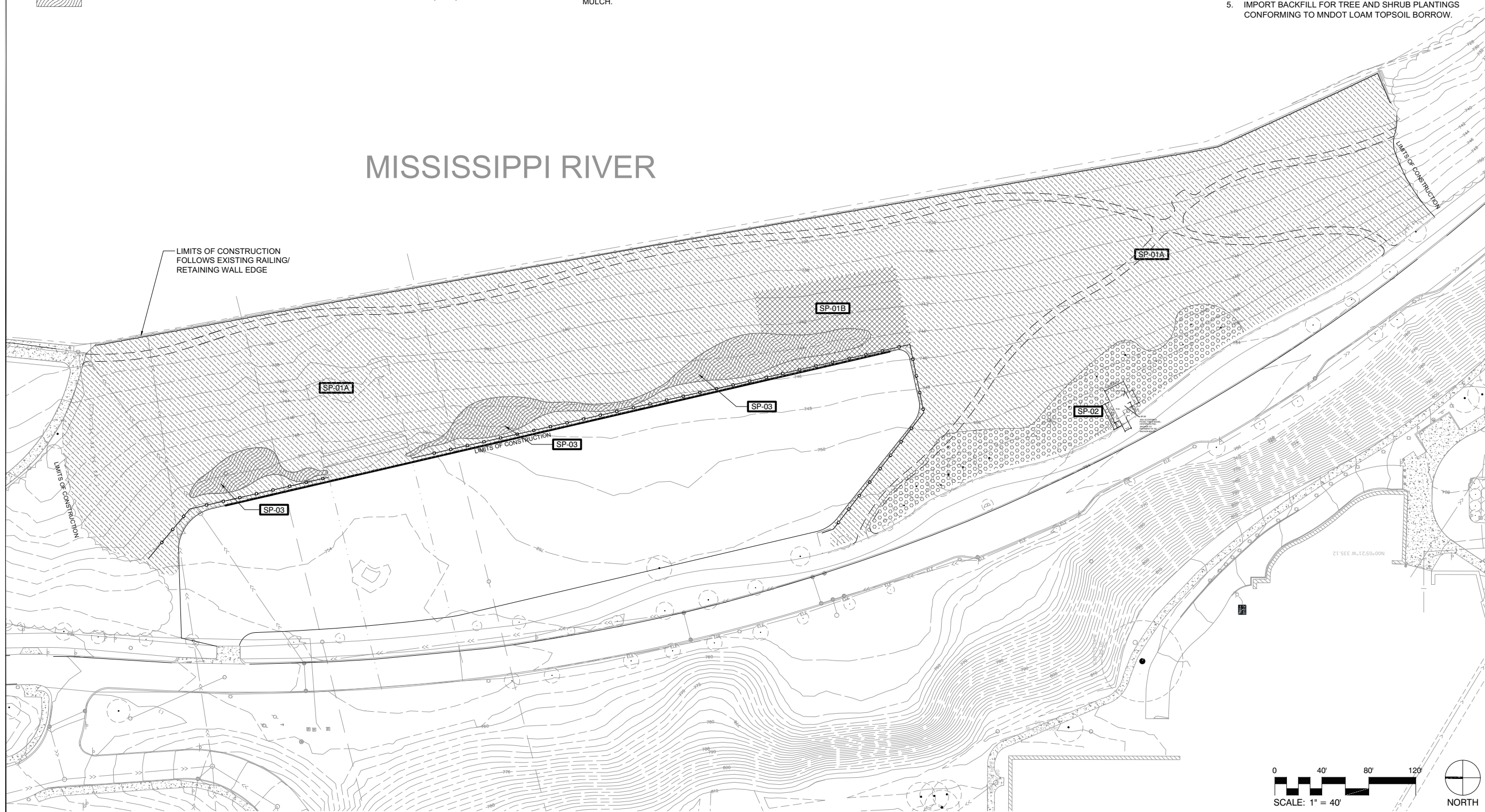

**LEGEND**

| TREES | CODE | BOTANICAL / COMMON NAME                                       | SIZE         | CONT.     |  |     |   |           |           |
|-------|------|---|--------------|-----------|--|-----|---|-----------|-----------|
|       | AL   | AMELANCHIER LAEVIS<br>ALLEGHENY SERVICEBERRY                  | 8' HT. CLUMP | B&B       |  | QC  | QUERCUS MUEHLENBERGII<br>CHINKAPIN OAK                              | 2" CAL.   | B&B       |
|       | PD   | POPULUS DELTOIDES 'SIOUXLAND'<br>EASTERN COTTONWOOD SIOUXLAND | 2.5" CAL.    | B&B       |  | QR1 | QUERCUS RUBRA<br>RED OAK  | 1" CAL.   | BARE ROOT |
|       | PA   | PRUNUS AMERICANA<br>AMERICAN PLUM<br>1" CAL                   | #10          | CONT.     |  | QR2 | QUERCUS RUBRA<br>RED OAK  | 2.5" CAL. | B&B       |
|       | PW   | PRUNUS SEROTINA<br>BLACK CHERRY<br>~1.25" CAL                 | #15          | CONT/ BAG |  | QV1 | QUERCUS VELUTINA<br>BLACK OAK                                       | 1" CAL.   | BARE ROOT |
|       | PV   | PRUNUS VIRGINIANA<br>CHOKECHERRY<br>1.25" CAL                 | #15          | CONT/ BAG |  | QV2 | QUERCUS VELUTINA<br>BLACK OAK                                       | 2" CAL.   | B&B       |
|       | QB   | QUERCUS BICOLOR<br>SWAMP WHITE OAK                            | 2.5" CAL.    | B&B       |  | TA  | TILIA AMERICANA<br>AMERICAN LINDEN                                  | 3" CAL.   | B&B       |
|       | QM1  | QUERCUS MACROCARPA<br>BUR OAK                                 | 1" CAL.      | BARE ROOT |  | UO  | ULMUS AMERICANA 'LEWIS & CLARK'<br>PRAIRIE EXPEDITION® AMERICAN ELM | 2.5" CAL. | B&B       |
|       | QM2  | QUERCUS MACROCARPA<br>BUR OAK                                 | 2.5" CAL.    | B&B       |  |     | EXISTING TREE   |           |           |
|       | QM4  | QUERCUS MACROCARPA<br>BUR OAK                                 | 4" CAL.      | B&B       |  |     |   |           |           |

**NOTES**

- REFER TO PLANTING SCHEDULES SHEET FOR PLANT SPACING, SEEDING RATES, AND PLANTING NOTES.
- REFER TO SHEET L161 FOR PERENNIAL PLANTING AND SEEDING.
- REFER TO L106 FOR EROSION CONTROL NOTES & DETAILS.
- REFER TO SOILS PLAN, L130 FOR SOIL PREPARATION AND DECOMPACTION REQUIREMENTS.
- DO NOT USE HEAVY EQUIPMENT WITHIN DRIPLINE OF EXISTING TREES.
- CONTRACTOR TO PROVIDE ESTABLISHMENT WATERING FOR TREES AND SHRUBS. METERED HYDRANT ACCESS AVAILABLE FROM MPRB. REFER TO WATERING NOTES ON SHEET L001
- PLANT MATERIAL, MULCH, SOILS, AND COMPOST SHALL BE INSPECTED FOR JUMPING WORMS PRIOR TO PLACEMENT AND DISTRIBUTION OF MATERIALS ON SITE. INSPECTION SHALL BE PERFORMED BY LANDSCAPE ARCHITECT. NOTIFY LA MINIMUM OF 48 HRS PRIOR TO MATERIAL ARRIVAL. SEE SPECIFICATIONS FOR SUBMITTAL REQUIREMENTS. JUMPING WORMS ARE AN UNCLASSIFIED INVASIVE SPECIES IN MINNESOTA AND PROVIDE A THREAT TO NATURAL ECOSYSTEMS.
- PROVIDE MYCORRHIZAE INOCULUM IN SEEDING AND PLANTING AREAS AT RATE OF 1.4LBS/ACRE. DISTRIBUTE INOCULUM EVENLY OVER SOILS IMMEDIATELY AFTER SEEDING AND BEFORE PLANTING. COVER THE EXPOSED SEED AND INOCULUM WITH LIGHT RAKING/HARROW.



310 South 4th Avenue, Suite 7050  
Minneapolis, MN 55415  
p: 612.332.7522



SUBMITTAL  
BID DOCUMENTS

**BOHEMIAN  
FLATS  
OAK SAVANNA  
RESTORATION**

MINNEAPOLIS, MN

I hereby certify that this document was prepared by me or under my direct supervision and that I am a duly licensed Landscape Architect under the laws of the State of Minnesota.

Name: Thomas Whitlock  
Registration#: 26292  
Signature: *Tom Whitlock* Date: 04/21/2023

DF/ Project #: 22-172a  
Scale: VARIES  
Drawn/Checked: JMR/MR

| REVISION |  |
|----------|--|
|          |  |
|          |  |
|          |  |
|          |  |

**TREE  
PLANTING  
PLAN**

**L160**

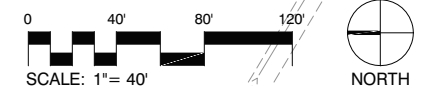
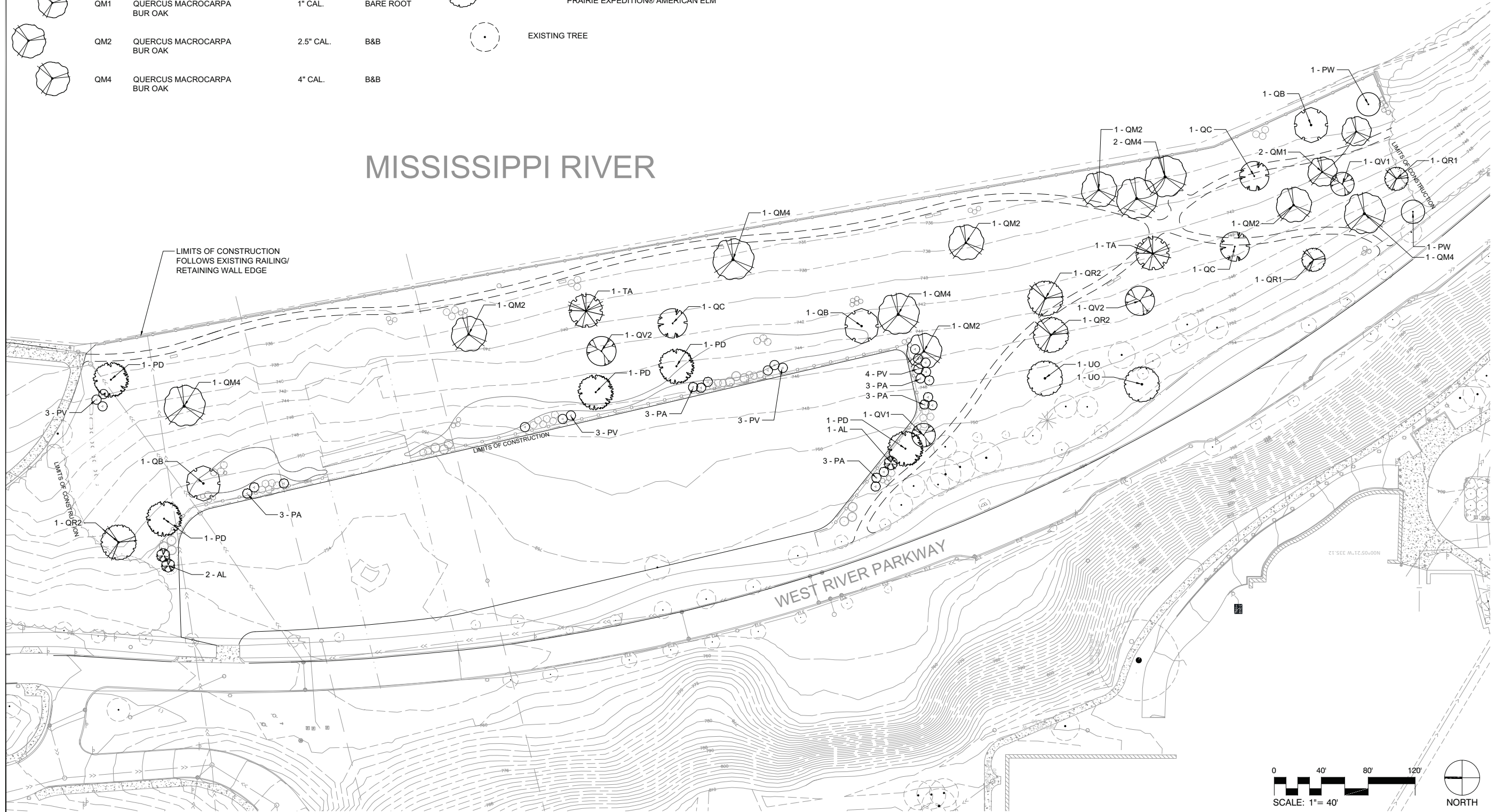

**LEGEND**

| SHRUB AREAS | CODE | BOTANICAL / COMMON NAME                        | SIZE | SHRUBS | CODE | BOTANICAL / COMMON NAME                       | SIZE |
|-------------|------|--|------|--------|------|---|------|
|             |      | STORMWATER SEEDING AND PLANTING                |      |        | AC   | AMORPHA CANESCENS LEADPLANT                   | #5   |
|             | AI   | ASCLEPIAS INCARNATA SWAMP MILKWEED             | PLUG |        | AF   | AMORPHA FRUTICOSA FALSE INDIGO                | #5   |
|             | EJ   | EUPATORIUM MACULATUM JOE PYE WEED              | PLUG |        | BA   | BAPTISIA AUSTRALIS BLUE WILD INDIGO           | #2   |
|             | FQ   | FILIPENDULA RUBRA QUEEN-OF-THE-PRAIRIE         | PLUG |        | CR   | CORNUS RACEMOSA GRAY DOGWOOD                  | #5   |
|             | HF   | HELIOPSIS HELIANTHOIDES FALSE SUNFLOWER        | PLUG |        | CS   | CORNUS SERICEA RED TWIG DOGWOOD               | #5   |
|             | LG   | LIATRIS PYCNOSTACHYA GAYFEATHER                | PLUG |        | CA   | CORYLUS AMERICANA AMERICAN HAZELNUT           | #5   |
|             | SC   | SILPHIUM PERFOOLIATUM CUP PLANT                | PLUG |        | RG   | RHUS GLABRA SMOOTH SUMAC                      | #5   |
|             | SN   | SYMPHYOTRICHUM NOVAE-ANGLIAE NEW ENGLAND ASTER | PLUG |        | SY   | SYMPHORICARPOS OCCIDENTALIS WESTERN SNOWBERRY | #5   |
|             | VF   | VERNONIA FASCICULATA IRONWEED                  | PLUG |        |      |   |      |
|             |      | SAVANNA PLUGS                                  |      |        |      |   |      |
|             | AP   | ANEMONE PATENS PASQUE FLOWER                   | PLUG |        |      |   |      |
|             | AT   | ASCLEPIAS TUBEROSA BUTTERFLY MILKWEED          | PLUG |        |      |   |      |
|             | BB   | BAPTISIA ALBA WHITE WILD INDIGO                | PLUG |        |      |   |      |
|             | CP   | COREOPSIS PALMATA STIFF TICKSEED               | PLUG |        |      |   |      |
|             | EC   | ECHINACEA PALLIDA PALE PURPLE CONEFLOWER       | PLUG |        |      |   |      |
|             | GT   | GEUM TRIFLORUM PRAIRIE SMOKE                   | PLUG |        |      |   |      |
|             | LG2  | LIATRIS PYCNOSTACHYA GAYFEATHER                | PLUG |        |      |   |      |
|             | SL   | SILPHIUM LACINIATUM COMPASS PLANT              | PLUG |        |      |   |      |
|             | SO   | SYMPHYOTRICHUM OOLENTANGIENSIS SKY BLUE ASTER  | PLUG |        |      |   |      |
|             | TO   | TRADESCANTIA OHIENSIS OHIO SPIDERWORT          | PLUG |        |      |   |      |
|             | ZA   | ZIZIA AUREA GOLDEN ALEXANDER                   | PLUG |        |      |   |      |

**MISSISSIPPI RIVER**

**NOTES**

- REFER TO PLANTING SCHEDULES SHEET FOR PLANT SPACING, SEEDING RATES, AND PLANTING NOTES.
- REFER TO SHEET L160 FOR TREE PLANTING PLAN.
- PROVIDE CERTIFIED WEED FREE NATIVE STRAW MULCH (MNDOT TYPE 8) TO PREVENT EROSION AND PROTECT SEED. MULCH AT 1.5 TONS/ ACRE.
- REFER TO L106 FOR EROSION CONTROL NOTES & DETAILS.
- REFER TO SOILS PLAN, L130 FOR SOIL PREPARATION AND DECOMPACTION REQUIREMENTS.
- PROVIDE HAND SEEDING & RAKING BELOW EXISTING TREES. DO NOT USE HEAVY EQUIPMENT WITHIN DRIPLENE OF EXISTING TREES.
- CONTRACTOR TO PROVIDE ESTABLISHMENT WATERING FOR TREES AND SHRUBS. METERED HYDRANT ACCESS AVAILABLE FROM MPRB. REFER TO WATERING NOTES ON SHEET L001
- PLANT MATERIAL, MULCH, SOILS, AND COMPOST SHALL BE INSPECTED FOR JUMPING WORMS PRIOR TO PLACEMENT AND DISTRIBUTION OF MATERIALS ON SITE. INSPECTION SHALL BE PERFORMED BY LANDSCAPE ARCHITECT. NOTIFY LA MINIMUM OF 48 HRS PRIOR TO MATERIAL ARRIVAL. SEE SPECIFICATIONS FOR SUBMITTAL REQUIREMENTS. JUMPING WORMS ARE AN UNCLASSIFIED INVASIVE SPECIES IN MINNESOTA AND PROVIDE A THREAT TO NATURAL ECOSYSTEMS.
- PROVIDE MYCORRHIZAE INOCULUM IN SEEDING AND PLANTING AREAS AT RATE OF 1.4LBS/ACRE. DISTRIBUTE INOCULUM EVENLY OVER SOILS IMMEDIATELY AFTER SEEDING AND BEFORE PLANTING. COVER THE EXPOSED SEED AND INOCULUM WITH LIGHT RAKING/HARROW .
- PROVIDE VEGETATION PROTECTION FENCE (FE-02) TO PROTECT SEEDED AREAS FROM DISTURBANCE THROUGH ESTABLISHMENT PERIOD. REFER TO SHEET L105 FOR FENCE LOCATION.

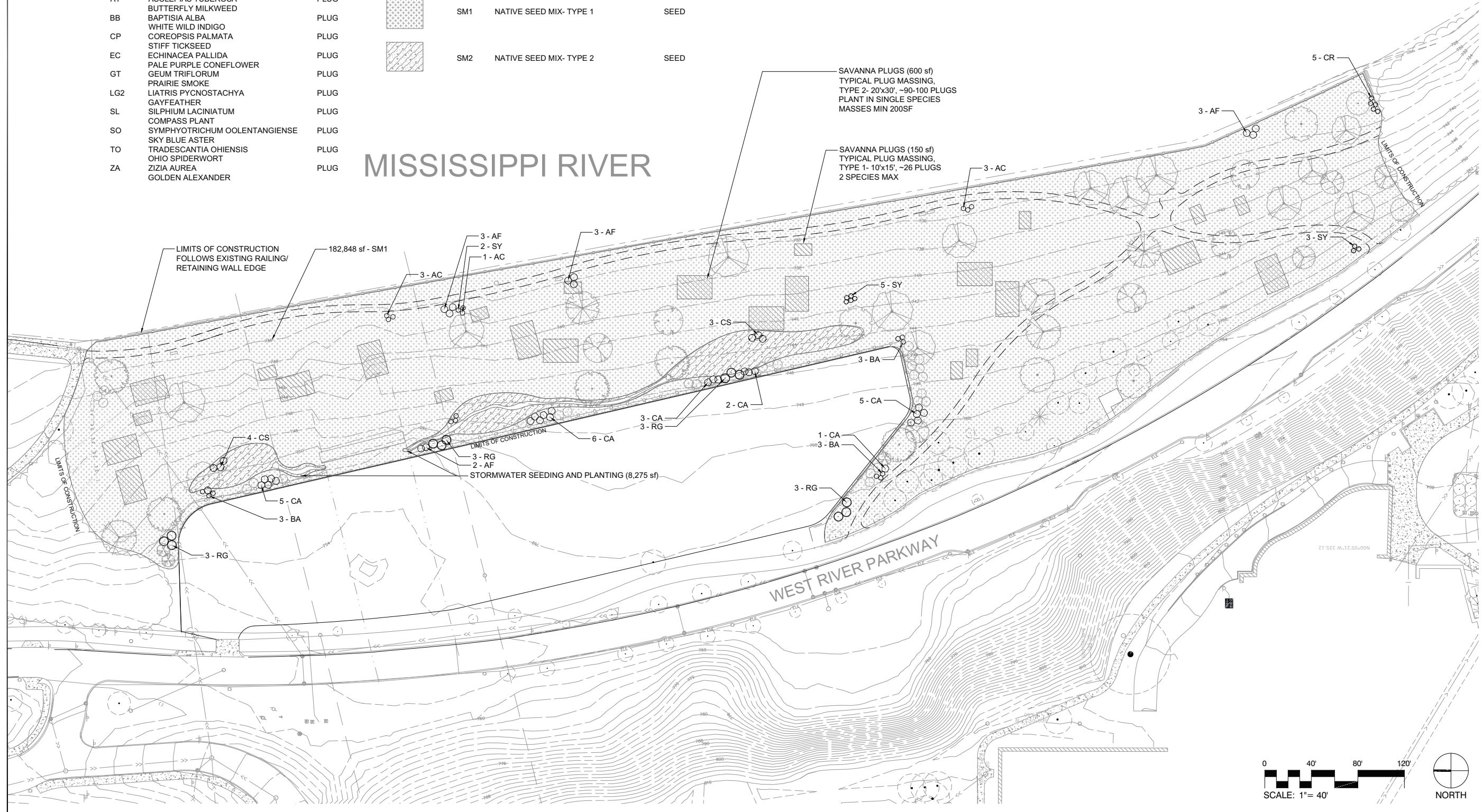

310 South 4th Avenue, Suite 7050  
 Minneapolis, MN 55415  
 p: 612.332.7522



SUBMITTAL  
 BID DOCUMENTS

**BOHEMIAN  
 FLATS  
 OAK SAVANNA  
 RESTORATION**

MINNEAPOLIS, MN

I hereby certify that this document was prepared by me or under my direct supervision and that I am a duly licensed Landscape Architect under the laws of the State of Minnesota.

Name: Thomas Whitlock  
 Registration#: 26292  
 Signature: *Tom Whitlock* Date: 04/21/2023

DF/ Project #: 22-172a  
 Scale: VARIES  
 Drawn/Checked: JMR/MR

| REVISION |  |
|----------|--|
|          |  |
|          |  |
|          |  |
|          |  |

**SEEDING &  
 PLANTING  
 PLAN**

**L161**

# BOHEMIAN FLATS OAK SAVANNA RESTORATION

MINNEAPOLIS, MN

I hereby certify that this document was prepared by me or under my direct supervision and that I am a duly licensed Landscape Architect under the laws of the State of Minnesota.

Name Thomas Whitlock

Registration# 26292

Signature Tom Whitlock Date 04/21/2023

DF/ Project # 22-172a

Scale VARIES

Drawn/Checked JMR/MR

REVISION

## DETAILS

# L500

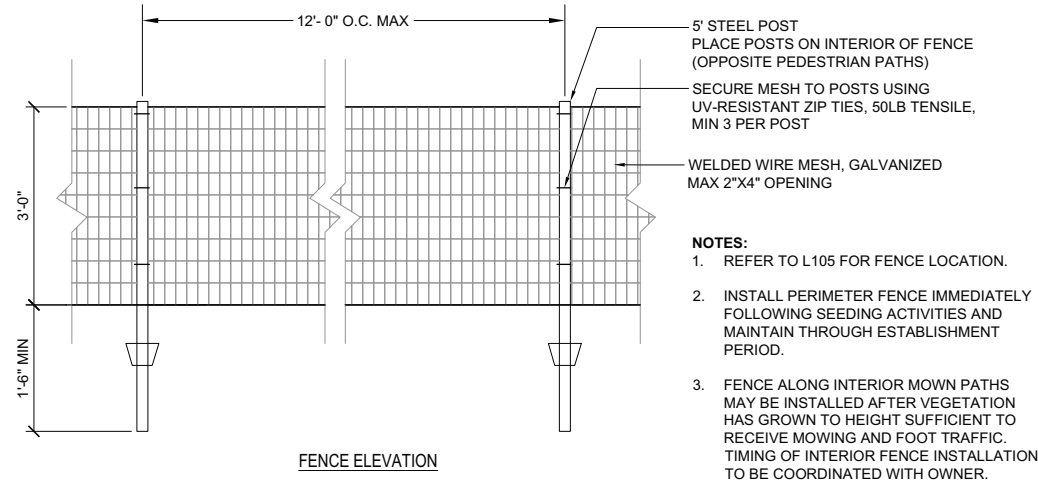

**5** WELDED WIRE MESH VEGETATION PROTECTION FENCE  
3/4" = 1'-0" P-22.172A-101

- NOTES:**
- REFER TO L105 FOR FENCE LOCATION.
  - INSTALL PERIMETER FENCE IMMEDIATELY FOLLOWING SEEDING ACTIVITIES AND MAINTAIN THROUGH ESTABLISHMENT PERIOD.
  - FENCE ALONG INTERIOR MOWN PATHS MAY BE INSTALLED AFTER VEGETATION HAS GROWN TO HEIGHT SUFFICIENT TO RECEIVE MOWING AND FOOT TRAFFIC. TIMING OF INTERIOR FENCE INSTALLATION TO BE COORDINATED WITH OWNER.

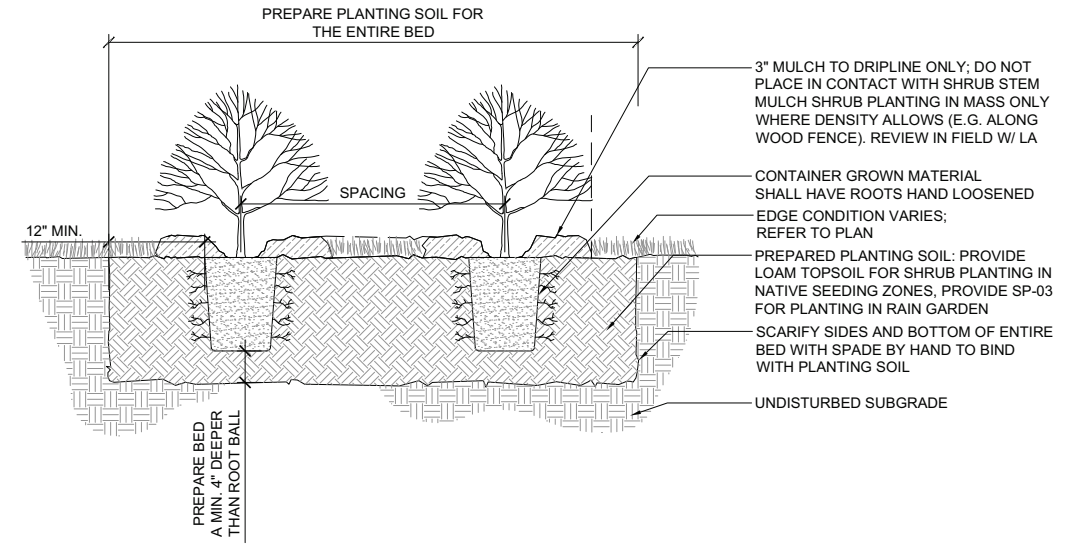

**2** DETAIL - SHRUB PLANTING  
1" = 1'-0" P-22.172A-02

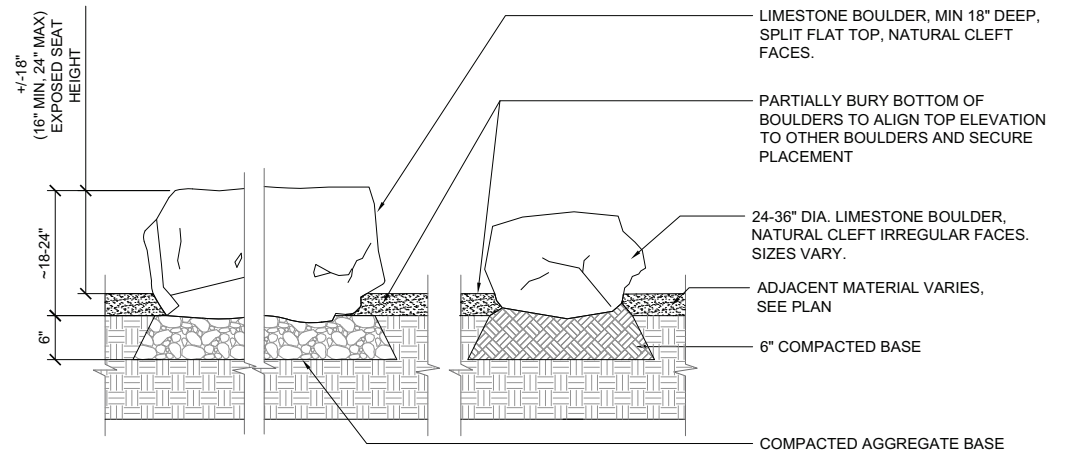

**4** LANDSCAPE BOULDERS (LA-01 & SF-01)  
1" = 1'-0" P-22.172A-07

- NOTE:** WHERE BOULDERS ARE TO BE USED AS SEATING ELEMENT, PROVIDE BOULDERS FREE FROM SHARP EDGES AND WITH FLAT TOPS. BOULDERS SHALL NOT APPEAR TO BE RESTING ON TOP OF GROUND AND MUST BE SET INTO GROUND.

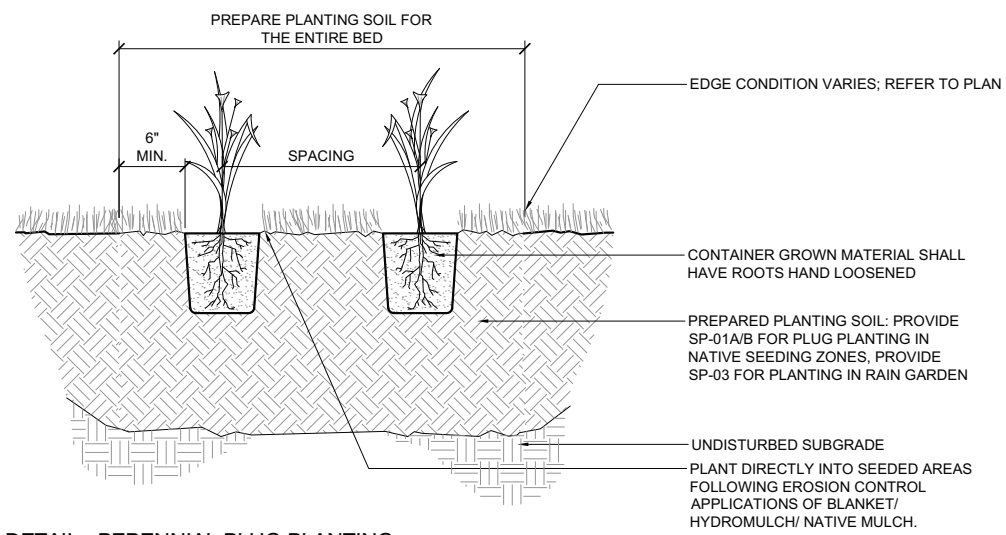

**3** DETAIL - PERENNIAL PLUG PLANTING  
1 1/2" = 1'-0" P-22.172A-04

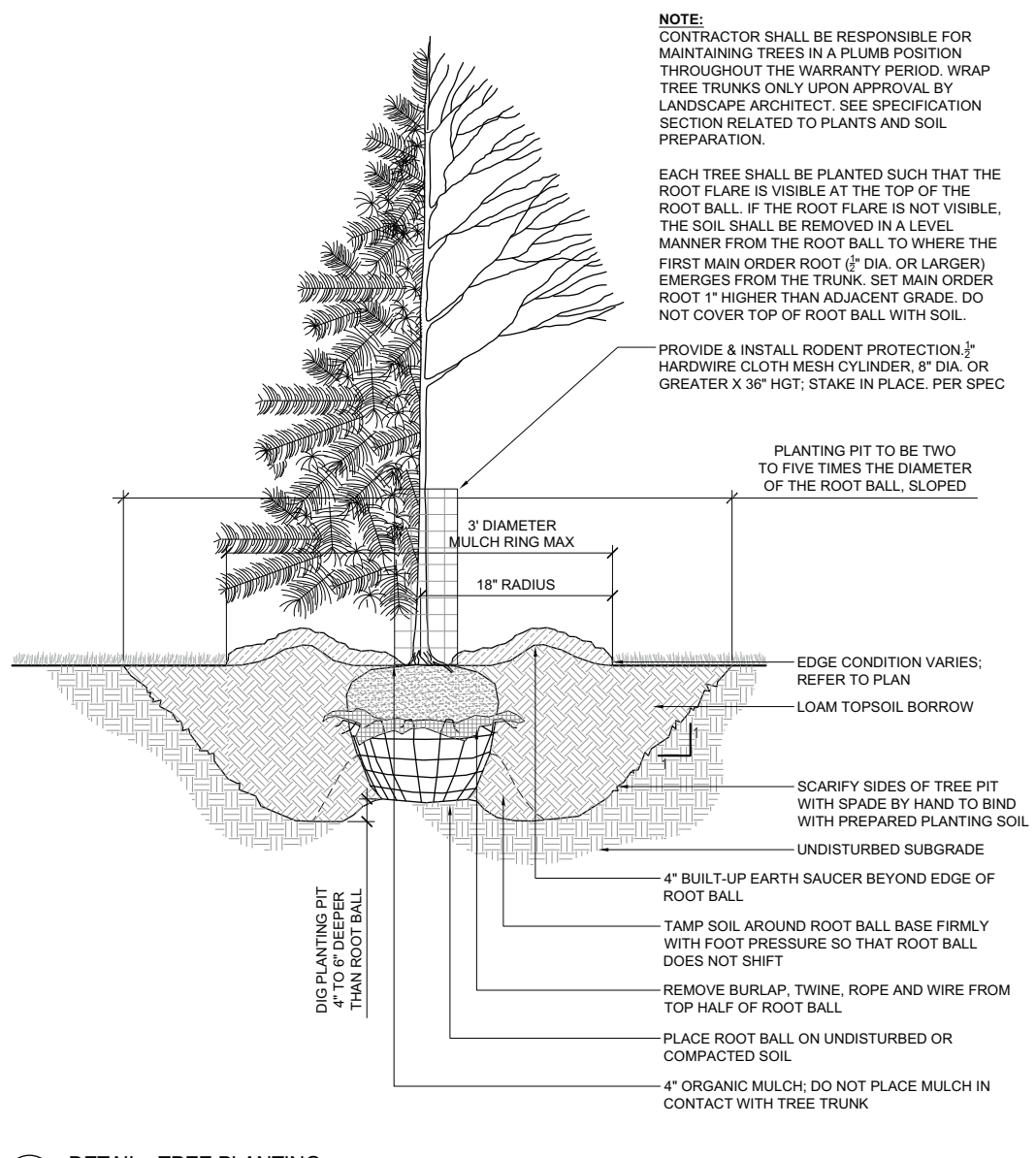

**1** DETAIL - TREE PLANTING  
3/4" = 1'-0" P-22.172A-03

- NOTE:** CONTRACTOR SHALL BE RESPONSIBLE FOR MAINTAINING TREES IN A PLUMB POSITION THROUGHOUT THE WARRANTY PERIOD. WRAP TREE TRUNKS ONLY UPON APPROVAL BY LANDSCAPE ARCHITECT. SEE SPECIFICATION SECTION RELATED TO PLANTS AND SOIL PREPARATION.
- EACH TREE SHALL BE PLANTED SUCH THAT THE ROOT FLARE IS VISIBLE AT THE TOP OF THE ROOT BALL. IF THE ROOT FLARE IS NOT VISIBLE, THE SOIL SHALL BE REMOVED IN A LEVEL MANNER FROM THE ROOT BALL TO WHERE THE FIRST MAIN ORDER ROOT (3/4" DIA. OR LARGER) EMERGES FROM THE TRUNK. SET MAIN ORDER ROOT 1" HIGHER THAN ADJACENT GRADE. DO NOT COVER TOP OF ROOT BALL WITH SOIL.
- PROVIDE & INSTALL RODENT PROTECTION 3/4" HARDWARE CLOTH MESH CYLINDER, 8" DIA. OR GREATER X 36" HGT; STAKE IN PLACE. PER SPEC

# BOHEMIAN FLATS OAK SAVANNA RESTORATION

MINNEAPOLIS, MN

I hereby certify that this document was prepared by me or under my direct supervision and that I am a duly licensed Landscape Architect under the laws of the State of Minnesota.

Name: Thomas Whitlock

Registration#: 26292

Signature: *Tom Whitlock* Date: 04/21/2023

DFJ Project #: 22-172a

Scale: VARIES

Drawn/Checked: JMR/MR

REVISION: \_\_\_\_\_

## DETAILS

# L501

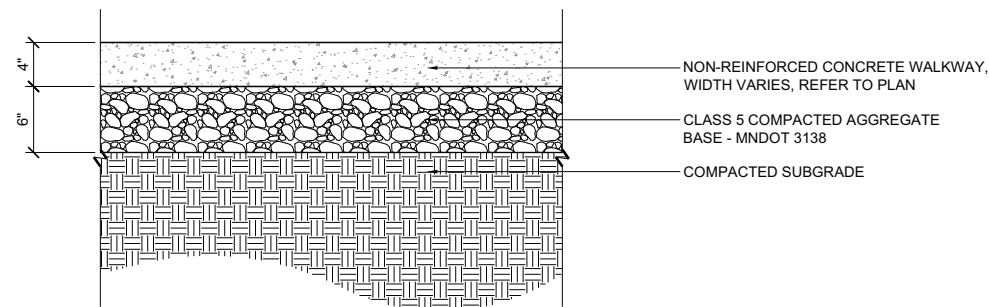

4 DETAIL-CONCRETE WALKWAY

NTS

P-22.172A-05

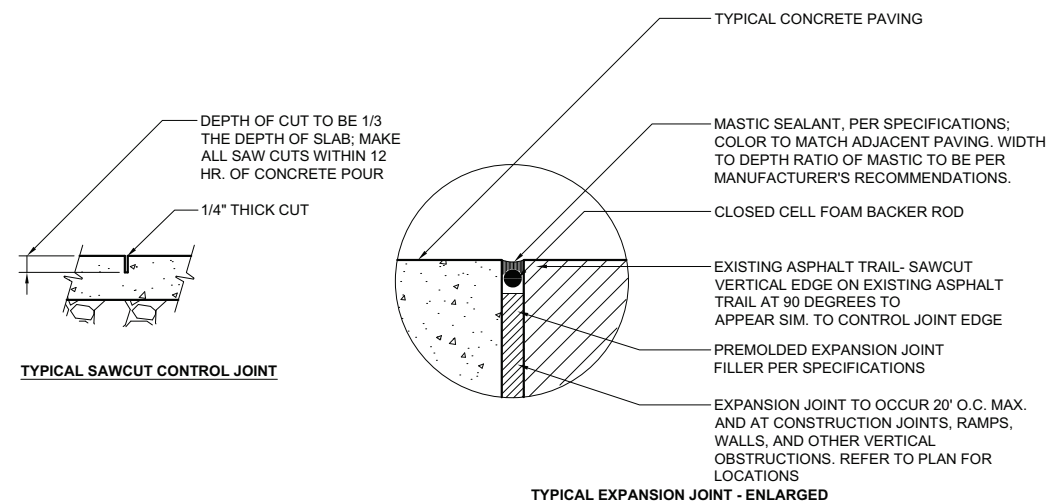

2 DETAIL - TYPICAL CONCRETE JOINTING

NTS

P-22.172A-06

**NOTES:**

1. CONCRETE TO BE MINIMUM COMPRESSIVE STRENGTH OF 4000 PSI AT 28 DAYS.
2. POSTS, RAILS, AND CAP TO BE SFI/ FSC TREATED WOOD (SPRUCE PINE FIR OR SOUTHERN YELLOW PINE) AND FREE FROM MAJOR DEFECTS OR BLEMISHES AFFECTING STRUCTURAL PERFORMANCE.
3. FASTENERS SHALL BE STAINLESS STEEL OR COATED DECK SCREWS SUITABLE FOR OUTDOOR USE. EMBED FASTENERS 3/4 INTO RECEIVING MEMBER. SPACE FASTENERS UNIFORMLY AND EVENLY.
4. INSTALL POSTS PLUMB.
5. HORIZONTAL RAILS SHALL FOLLOW HORIZONTAL GRADE BETWEEN POSTS.
6. MITER RAILS & CAP AT CORNERS.
7. PROVIDE FRESH CUT ENDS AT BUTT JOINTS ON RAILS.
8. SPACE POSTS EVENLY ALONG STRAIGHT RUNS, 8'-0" MAX.
9. STAKE FENCE LOCATION IN FIELD FOR REVIEW BY LANDSCAPE ARCHITECT.
10. SUBMIT SHOP DRAWINGS PRIOR TO INSTALLATION FOR REVIEW AND APPROVAL BY LANDSCAPE ARCHITECT.

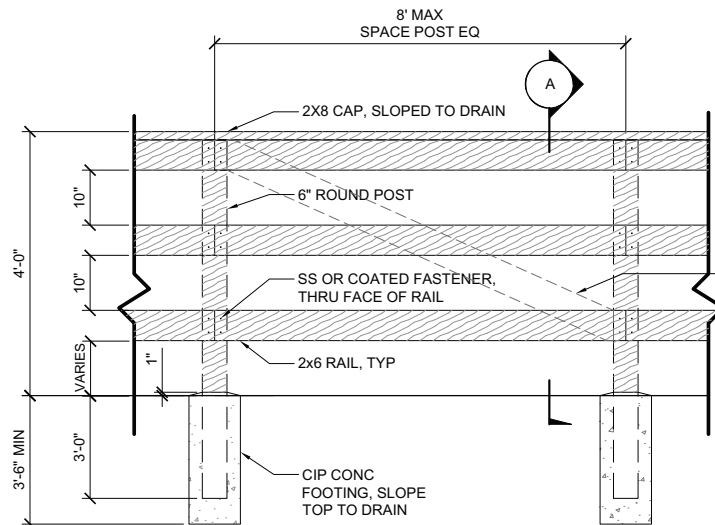
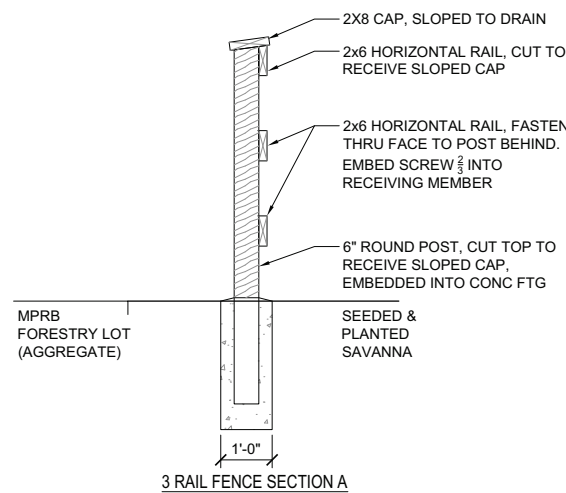

3 THREE-RAIL FENCE

3/4" = 1'-0"

P-22.172A-100

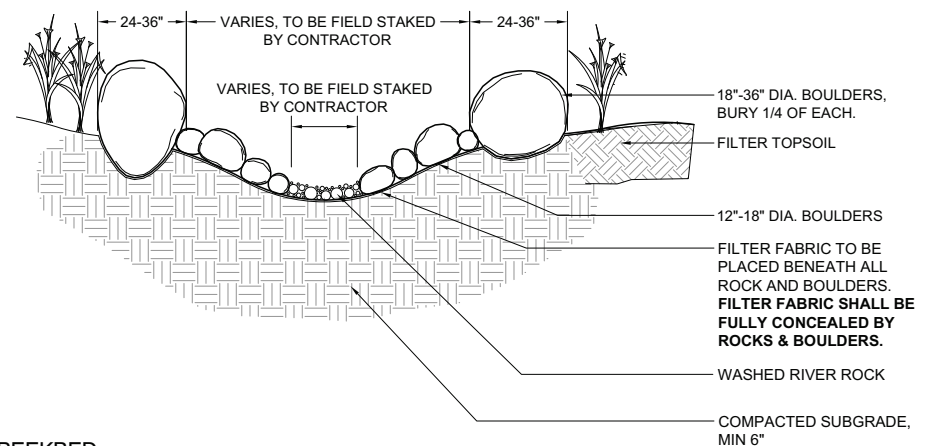
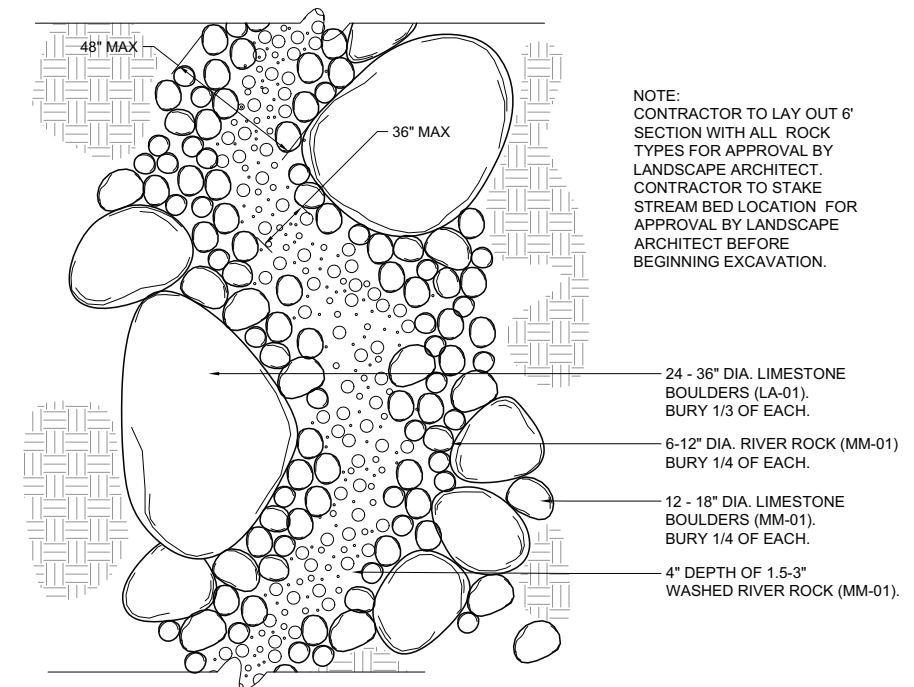

1 DRY CREEKBED

1" = 1'-0"

P-22.172A-59