

TELL US WHAT YOU THINK!

FOLWELL PARK IMPROVEMENTS

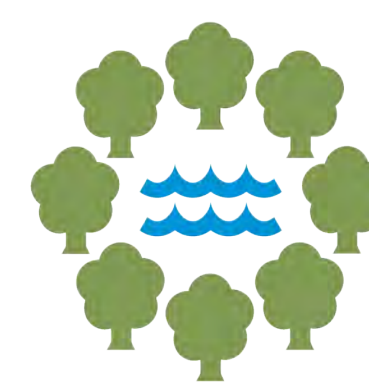

Minneapolis
Park & Recreation Board
www.minneapolisparcs.org

Planning and Implementation Work Done to Date:

In 2019 The Minneapolis Park and Recreation Board (MPRB) adopted the North Service Area Master Plan, including a conceptual master plan for Folwell Park. This master plan was created to:

- set goals for long-term development and improvements at the park, and
- provide a guidebook for general concept-level elements slated as future improvements.

After the adoption of the master plan, **Phase I improvements** were done in Folwell Park that included:

- new multi-use field lighting
- a new ADA pathway from Knox Ave to the playground area
- playground improvements, and
- tennis court improvements.

We are now in **Phases II and III of improvements** to Folwell Park, and need your input today to identify what is most important to the community! Improvements under consideration include:

- a new all-wheel park
- an additional outdoor basketball court
- community gathering space improvements
- stormwater management improvements
- parking lot improvements, and
- other thoughts you may have!

Please visit the various boards and stations here today to discuss the project with the team and provide your valuable input!

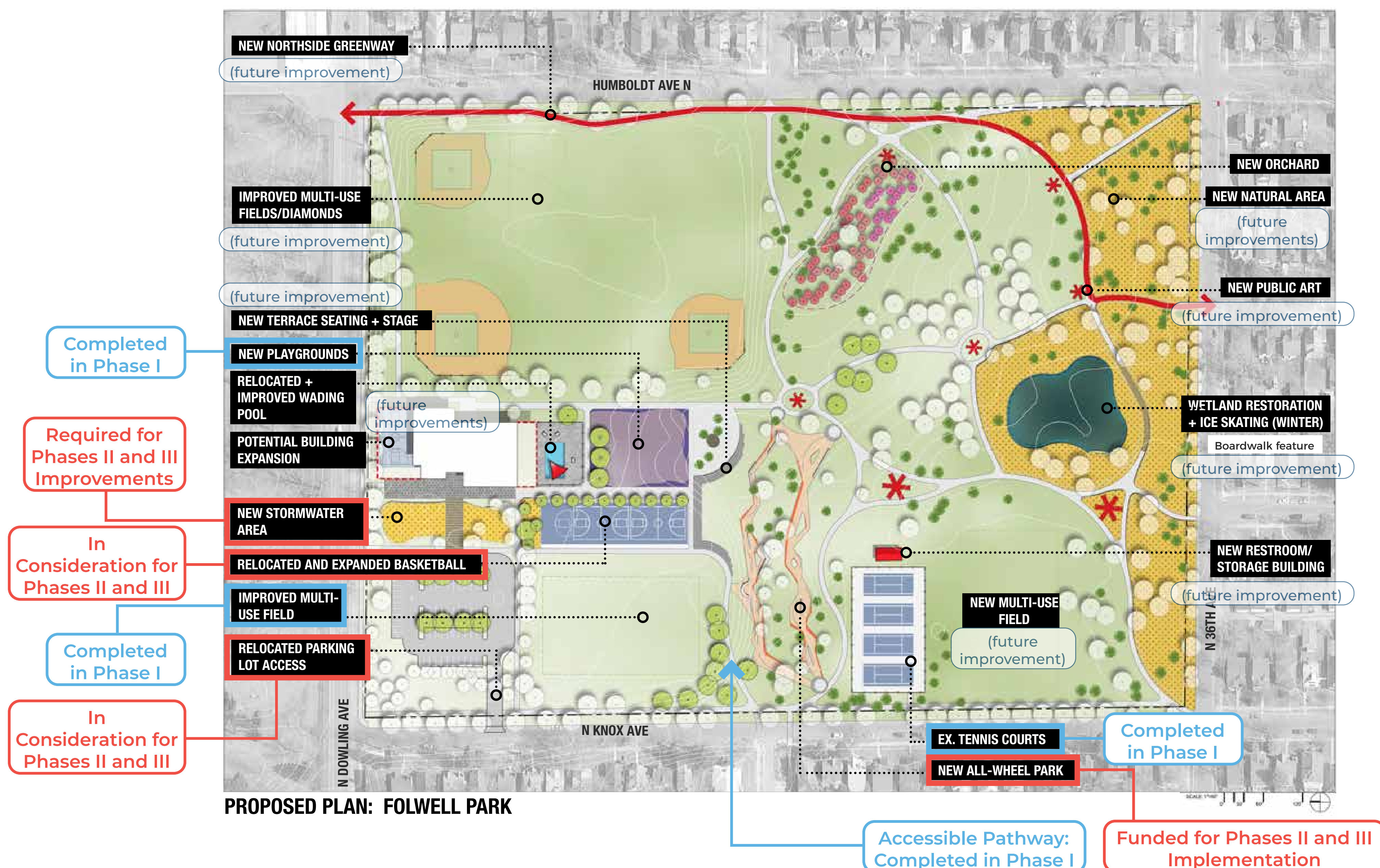

TELL US WHAT YOU THINK! FOLWELL PARK IMPROVEMENTS

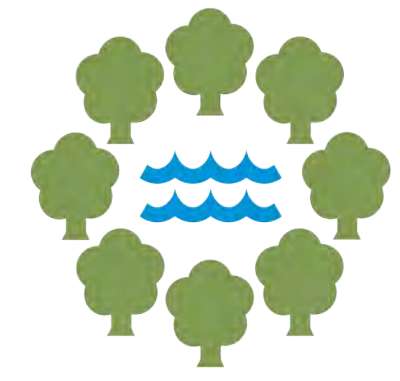

Minneapolis
Park & Recreation Board
www.minneapolisparcs.org

Community Engagement Survey Results:

In April and May, an online community-wide survey provided the below insight into where community preferences were trending for park improvements being considered for phases II and III of the Folwell Park implementation:

Q8 In what zip code do you live? (5 digits ex. 55417)

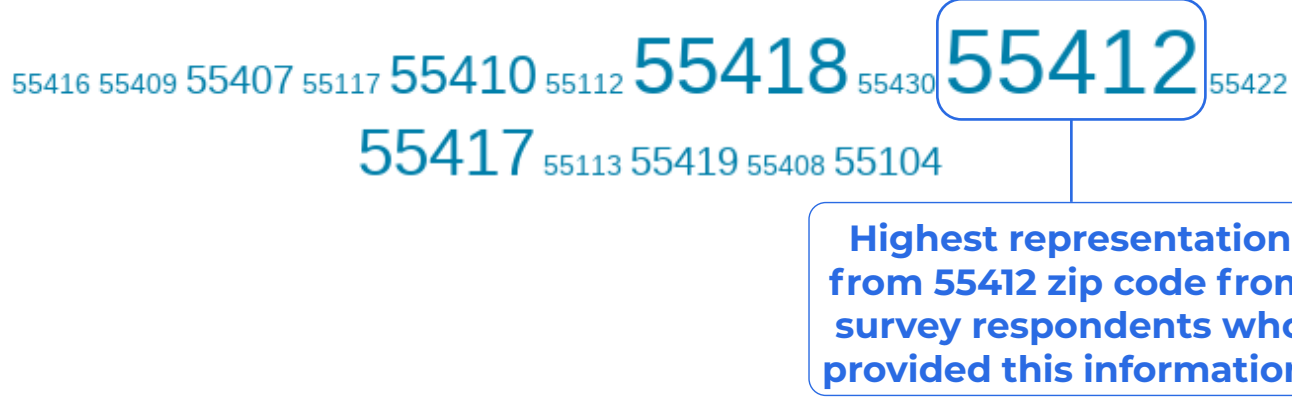

Q10 When you visit Folwell Park, what do you do when you are there? (Select all that apply)

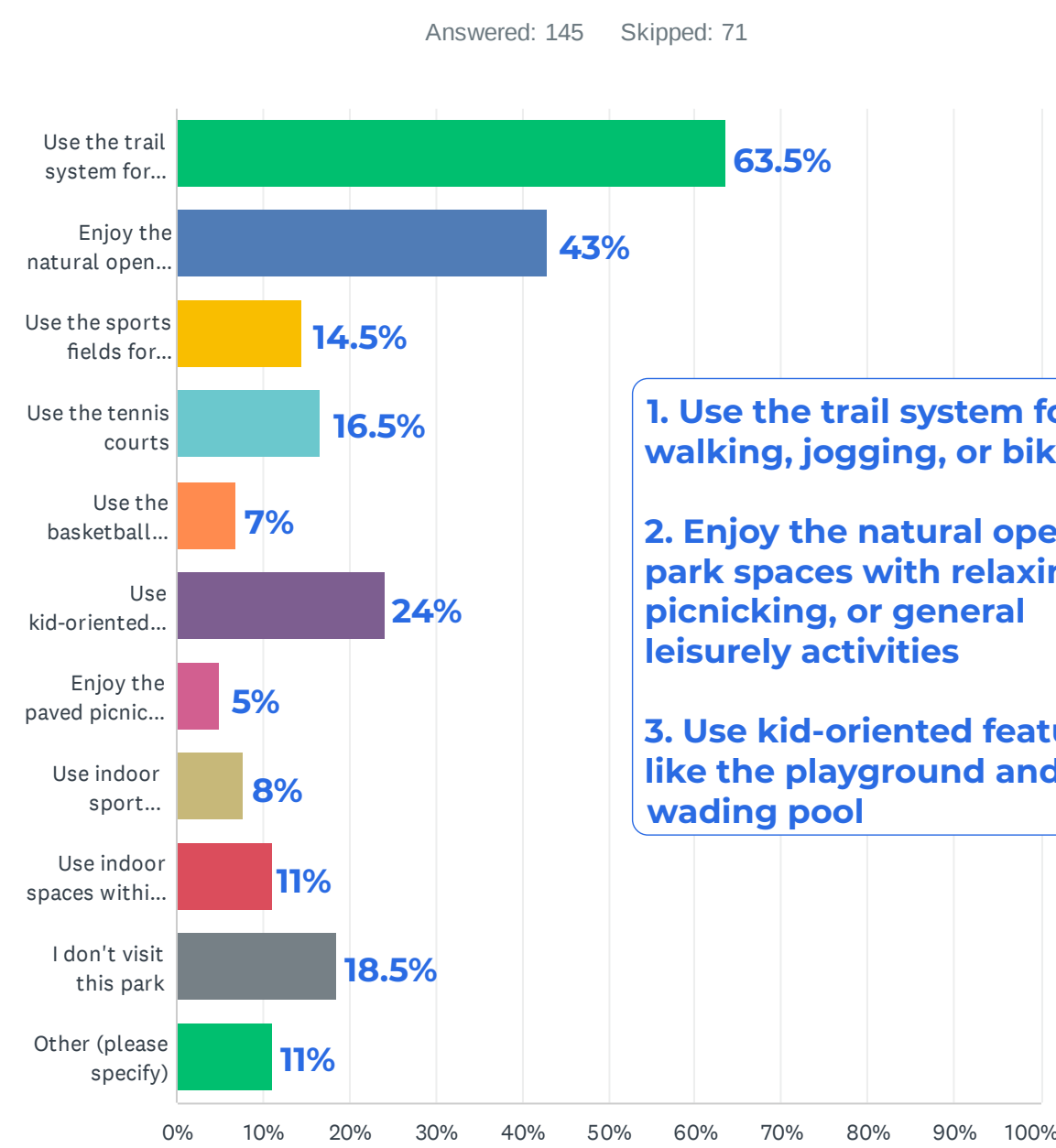

Q14 Do you see a need for an additional basketball court in the park? (Select one)

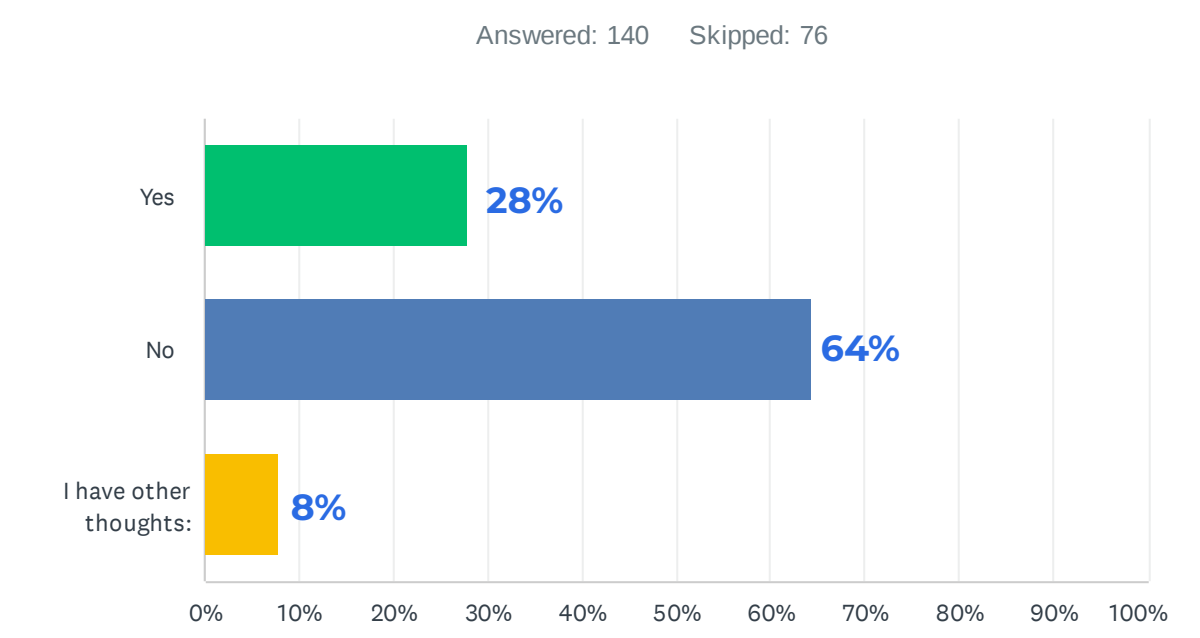

Q9 How often do you visit Folwell Park? Select one.

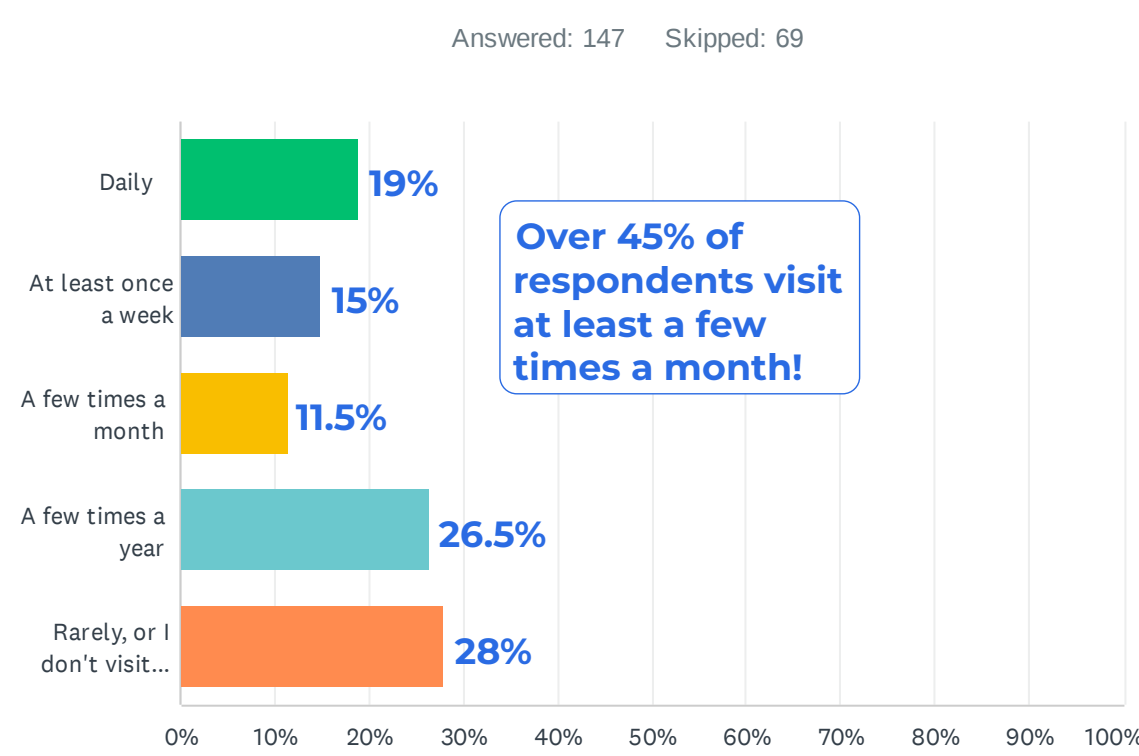

Q15 How do you use this paved picnic area? (Select all that apply)

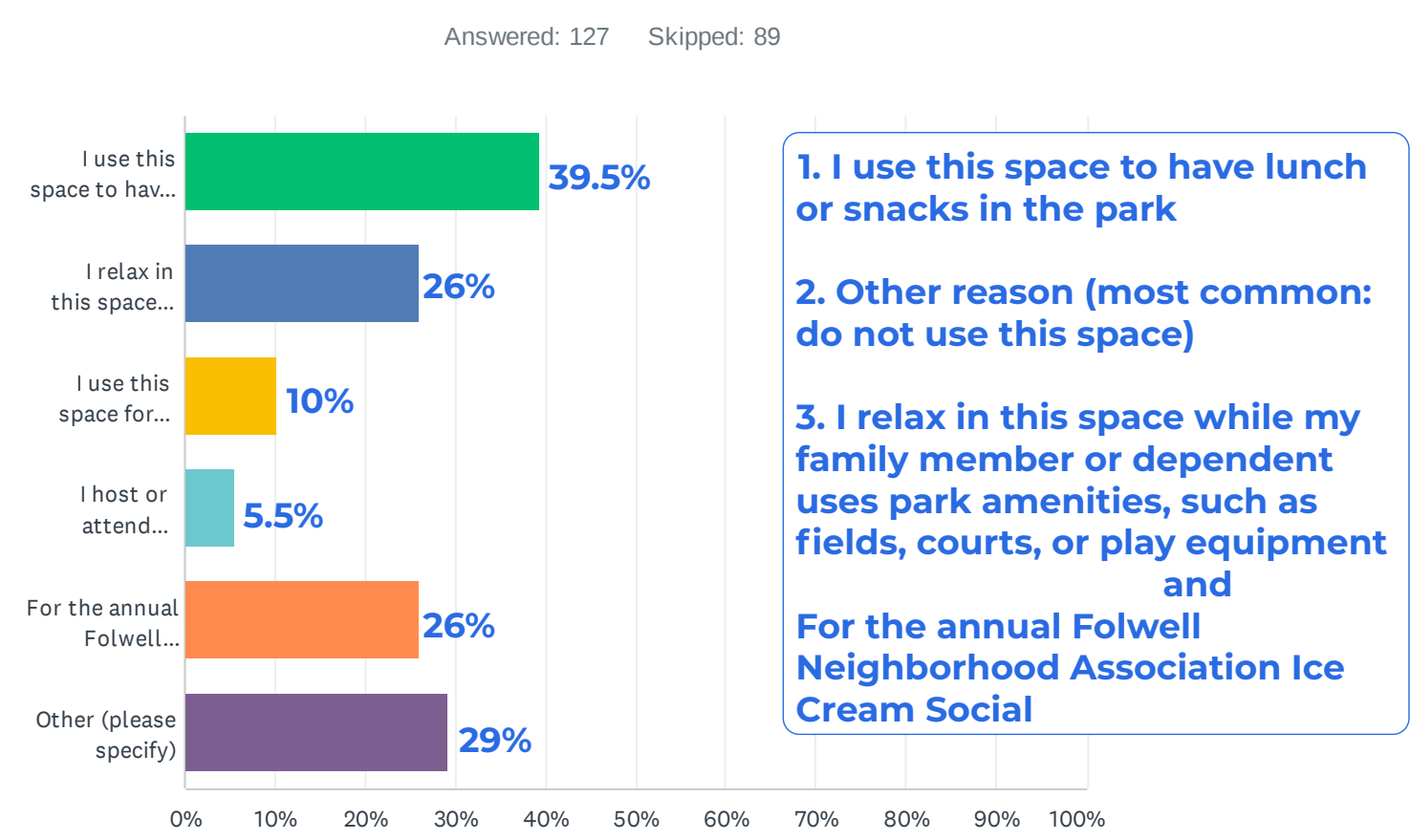

Q16 If you have used the paved picnic area next to the park building, what are your thoughts on this space? Please select one.

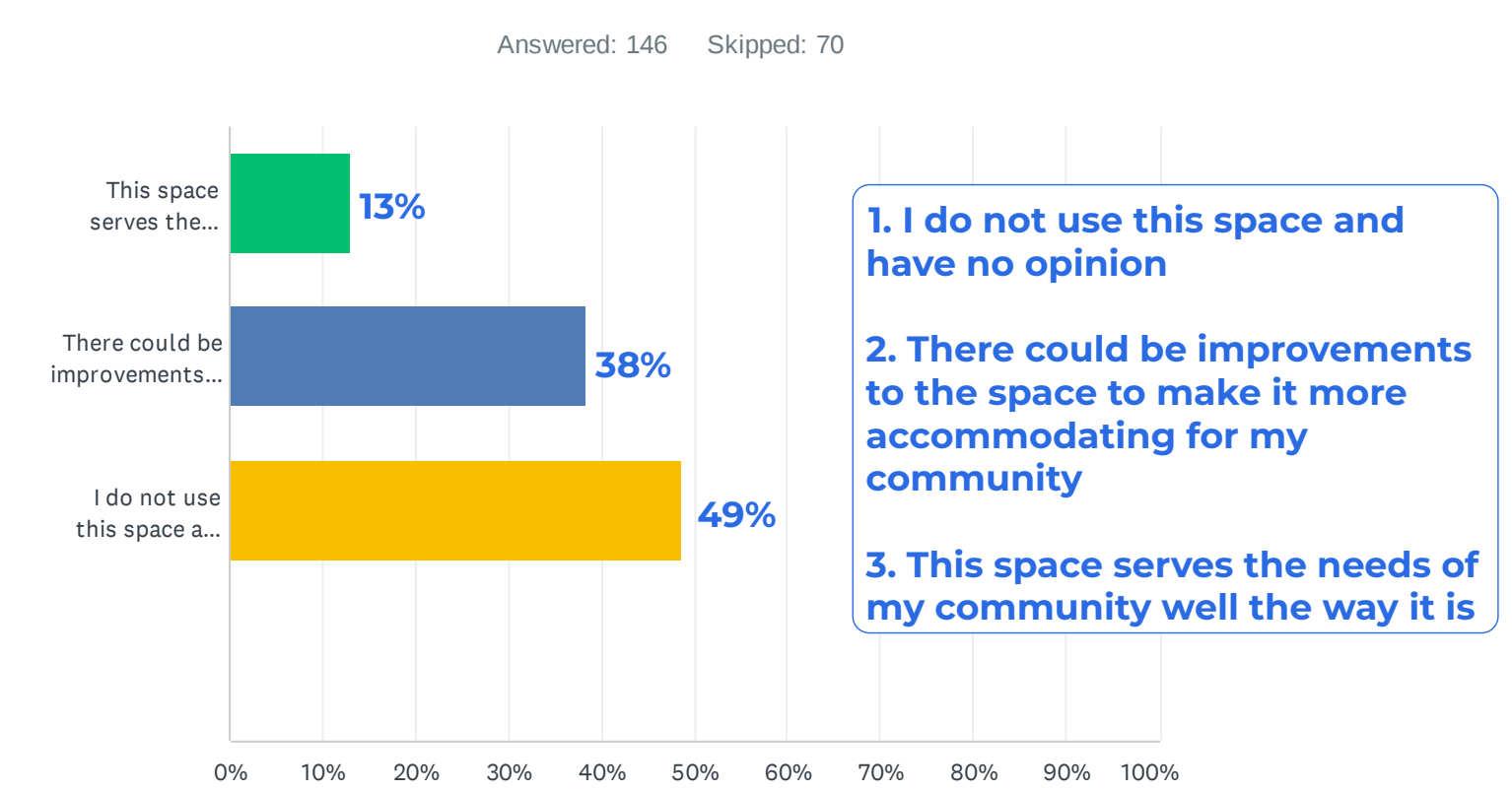

Q22 Of the features you selected previously, please rank the top three most important ones (Select your top 3)

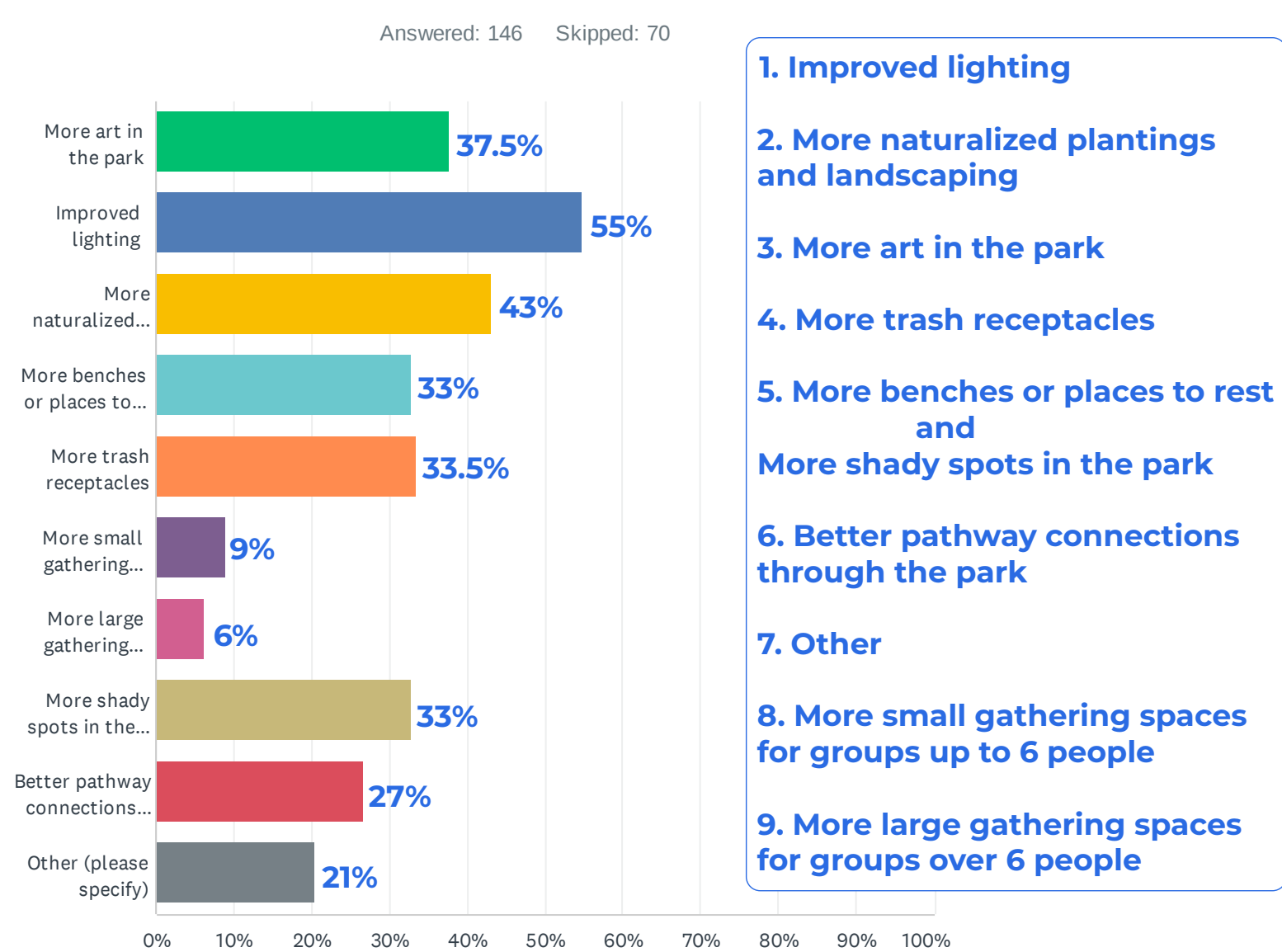

Q24 In the MPRB Plans for Folwell Park, an all-wheel park is identified as a new feature to be added to the park. Is this new feature something that you or someone you know would be interested in using in this park? (Note: an all-wheel park is a skate-style outdoor track/paved area that accommodates all types of individual non-motorized wheel-based equipment, such as BMX bikes, skateboard, scooters, roller blades, roller skates, and wheelchairs. Please reference two images below.)

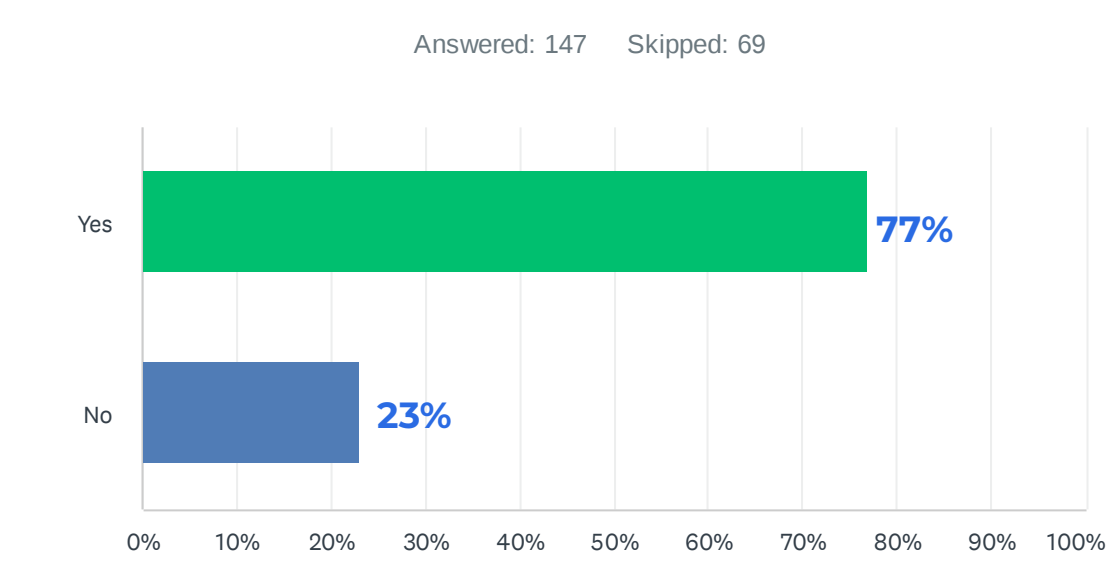

Q25 Are you a...?

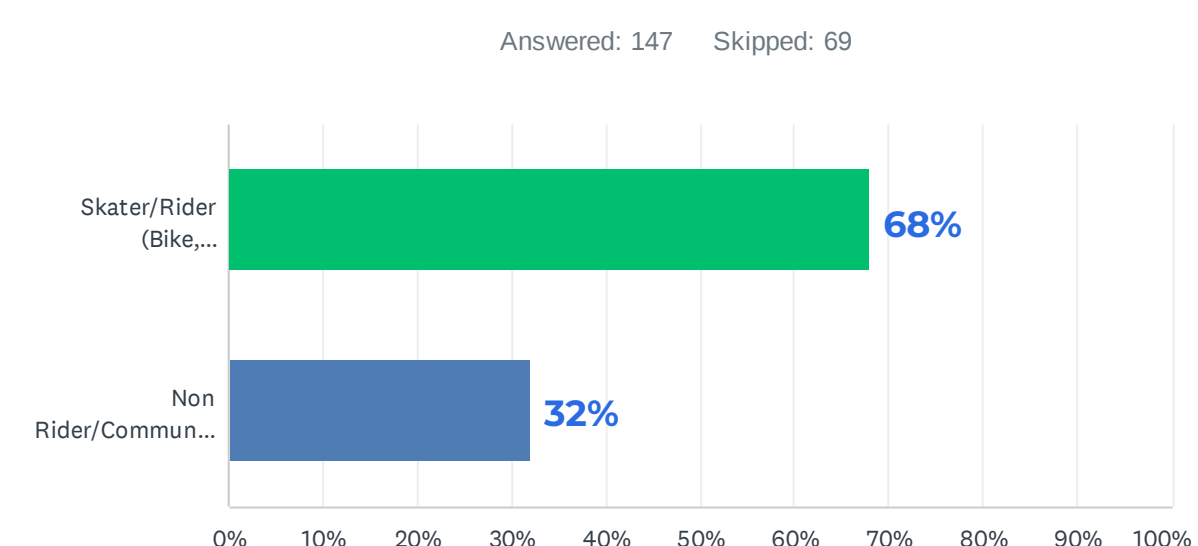

TELL US WHAT YOU THINK!

FOLWELL PARK IMPROVEMENTS

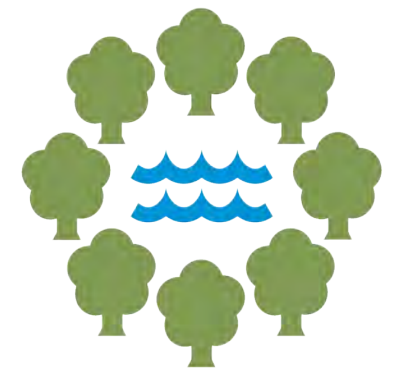

Minneapolis
Park & Recreation Board
www.minneapolisparcs.org

Which park improvements do you prefer?
Use the sticker dots to vote for your preferred images!

Community Gathering Areas: Park Shelters



Small size shelter



Medium size shelter



Large size shelter

Community Gathering Areas: Existing Plaza Renovation



Programmed space for food and flexible seating



Casual space, smaller group seating

Community Gathering Areas: Park Gathering Spaces



Gathering integrated into park amenities



Natural and casual relaxation spaces



Open and flexible spaces

TELL US WHAT YOU THINK!

FOLWELL PARK IMPROVEMENTS

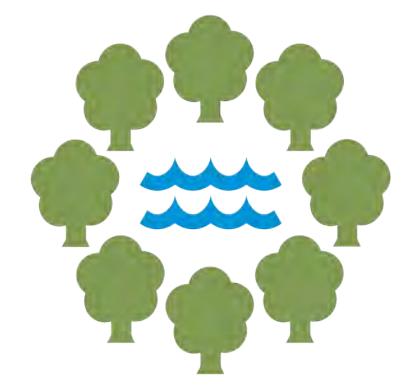

Minneapolis
Park & Recreation Board
www.minneapolisparcs.org

Which park improvements do you prefer?
Use the sticker dots to vote for your preferred images!

Additional Basketball Court



Color and unique character



Court-side seating and shade



Multi-sport opportunities

Park Comfort Elements



Nature-inspired seating



Traditional park seating



Modern / unique seating



Accessible/dog friendly fountains

New Landscaped Areas



Large areas of native / natural landscaping



Combination lawn and areas of natural



Predominantly mown lawn

TELL US WHAT YOU THINK!

FOLWELL PARK IMPROVEMENTS

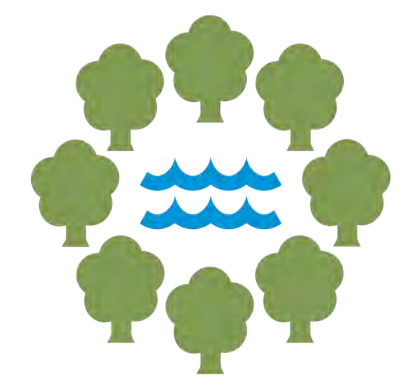

Minneapolis
Park & Recreation Board
www.minneapolisparcs.org

Which park improvements do you prefer?
Use the sticker dots to vote for your preferred images!

Tot Exploration Area



Nature-inspired play



Multi-play opportunities



Sculpture / artful play



Flexible non-programmed play



Bike safety course



Mountain bike learning course

Mountain Bike Skills Trail



Boulder trails



Wavy bridges



Bank turns

TELL US WHAT YOU THINK!

FOLWELL PARK IMPROVEMENTS

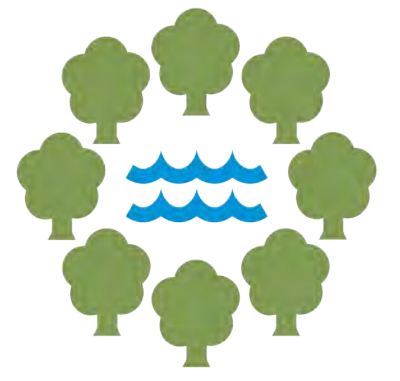

Minneapolis
Park & Recreation Board
www.minneapolisparcs.org

Park Improvements Concept 1:

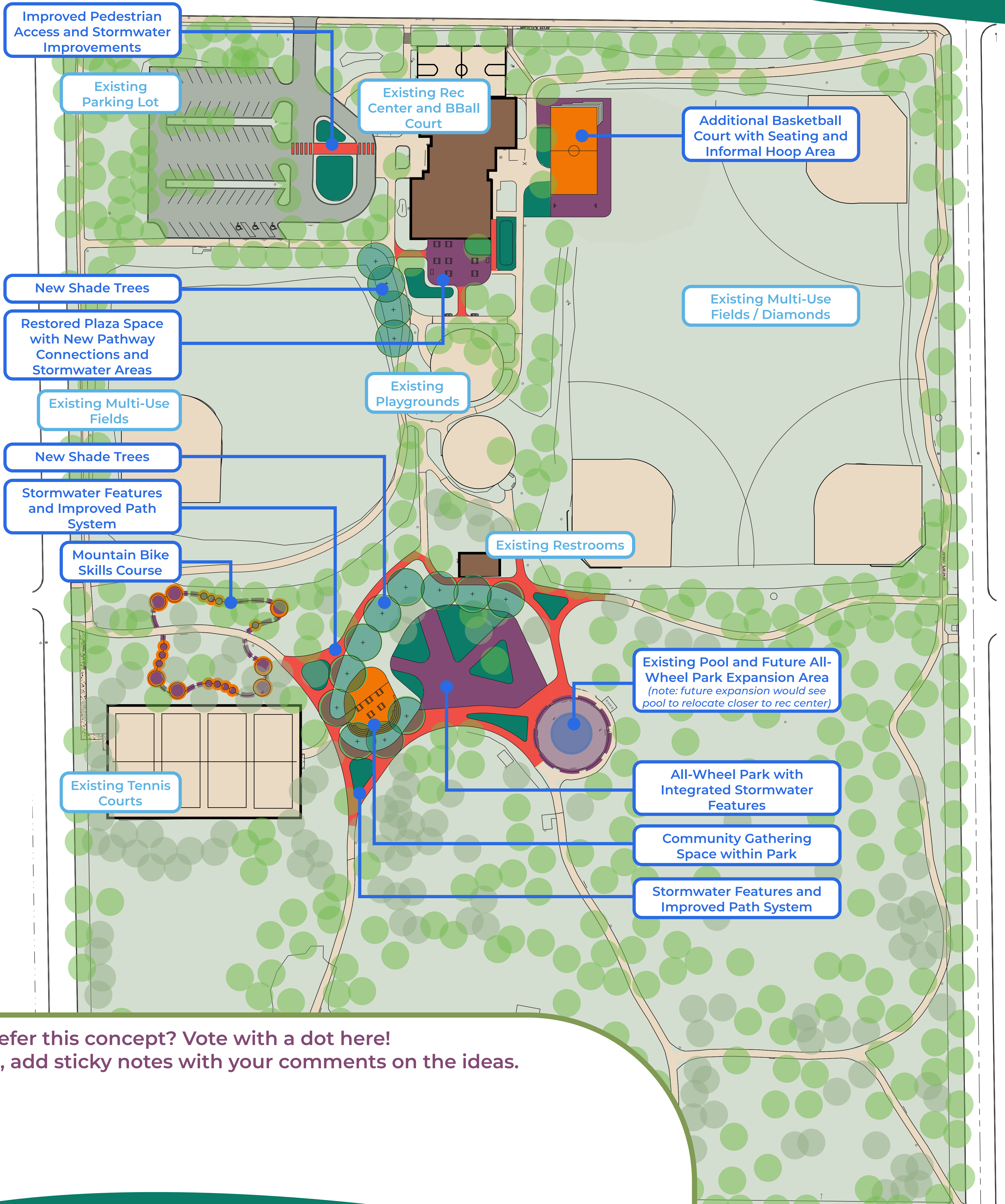

Prefer this concept? Vote with a dot here!
Or, add sticky notes with your comments on the ideas.

TELL US WHAT YOU THINK!

FOLWELL PARK IMPROVEMENTS

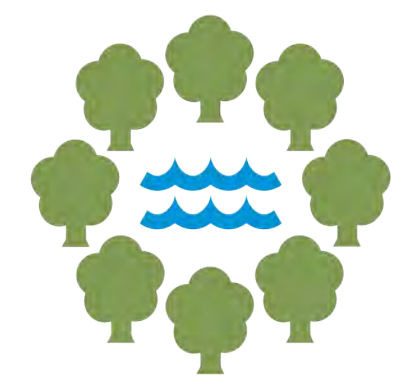

Minneapolis
Park & Recreation Board
www.minneapolisparcs.org

Park Improvements Concept 2:

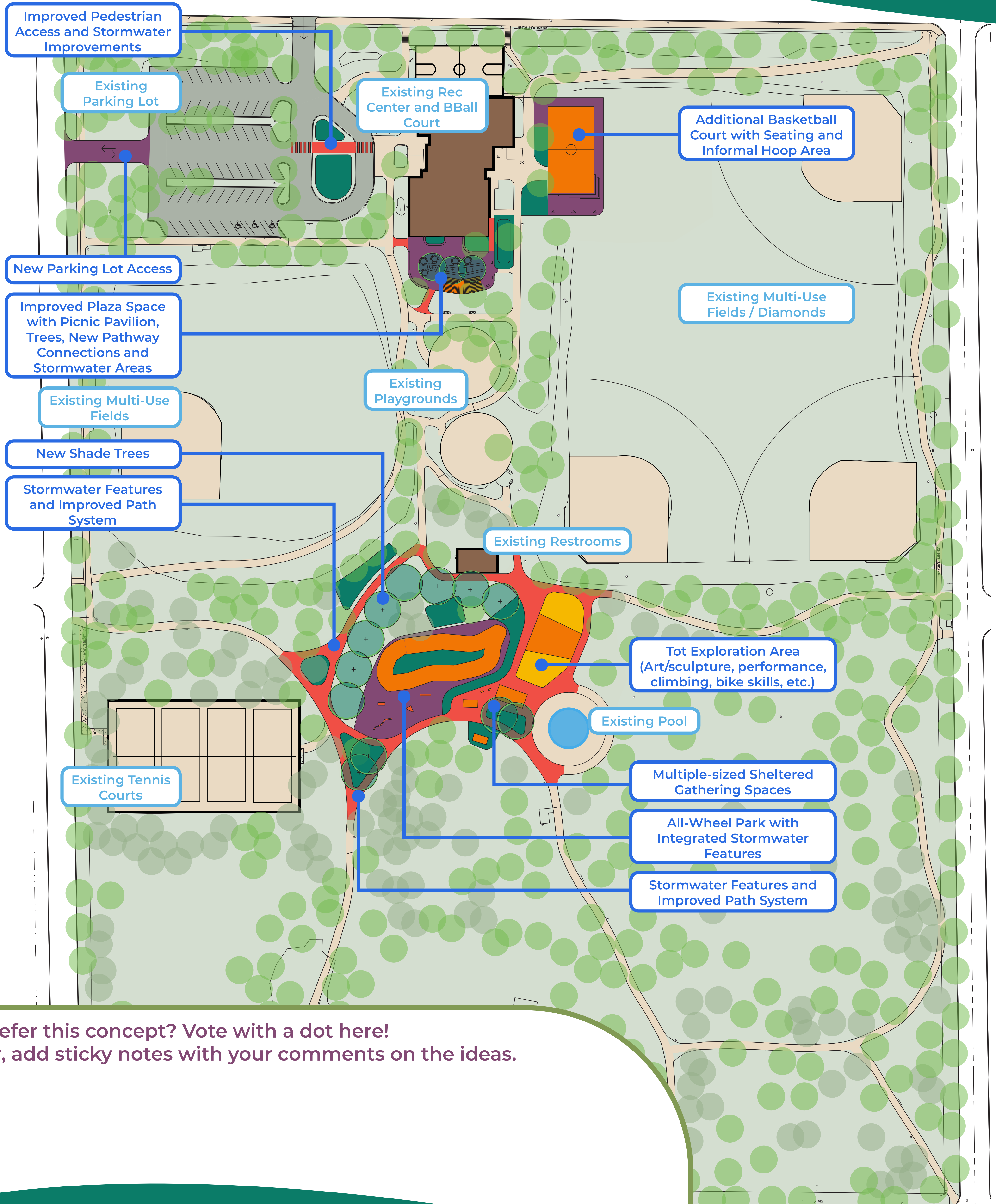

Prefer this concept? Vote with a dot here!
Or, add sticky notes with your comments on the ideas.

TELL US WHAT YOU THINK!

FOLWELL PARK IMPROVEMENTS

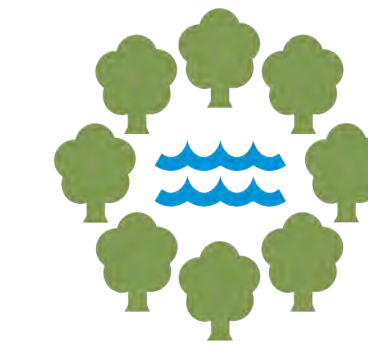

Minneapolis
Park & Recreation Board
www.minneapolisparcs.org

Build your own park!

Around \$1,088,814 has been allocated for the construction of the phases II and III improvements in Folwell Park. As much as we would love to see as many improvements built in this phase as possible, not everything may be able to fit within this budget.

Help the design team prioritize community-based improvement desires with this activity! You will be given 10 marbles to spend on the below improvements. Shop for what you would prefer to see in these phases.

Note: the all-wheel park and stormwater improvements are required elements based on funding sources and environmental regulations. Those costs have been factored into what you are able to budget with your marbles.

Additional Basketball Court

3 Marbles

Community Gathering Areas:

2 marbles - New Large Shelter

1 marble - New Small Shelter

3 marbles - Renovate Existing Plaza

2 marbles - New General Park Gathering Space

New Tot Exploration Area

2 Marbles

New Mountain Bike Skills Trail

2 Marbles

Additional Entrance to Parking Lot

4 Marbles

New Park Comfort Elements (benches, drinking fountains, lighting, etc.)

2 Marbles

TELL US WHAT YOU THINK!

FOLWELL PARK IMPROVEMENTS

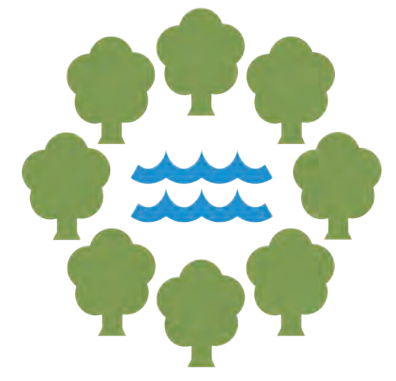

Minneapolis
Park & Recreation Board
www.minneapolisparcs.org

LAYOUT:

HERE ARE 3 EXAMPLES THAT ARE REALISTIC WITHIN THE BUDGET WE HAVE TO WORK WITH. **SELECT YOUR FAVORITE LAYOUT OF THE THREE, AND WRITE A BRIEF EXPLANATION OF WHY YOU CHOSE THIS.** A HYBRID VERSION OF THE THREE WILL BE CREATED CONSIDERING ALL OF YOUR CHOICES AND ANSWERS.

PLACE 1 STICKY NOTE BELOW

JUMP LINE WITH STREET STAGES



1.

PUMP TRACK WITH STREET LANE



2.

PUMP TRACK WITH SPACIOUS STREET PLAZA



3.

TELL US WHAT YOU THINK!

FOLWELL PARK IMPROVEMENTS

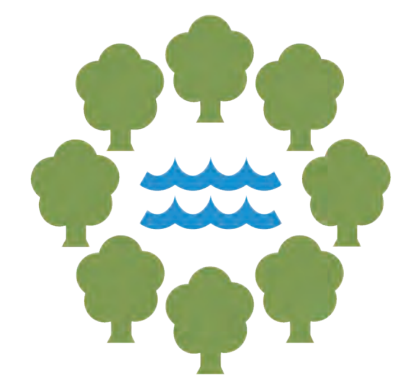

Minneapolis
Park & Recreation Board
www.minneapolisparcs.org

BIKERS:

WHAT BIKE FEATURES GET YOU MOST EXCITED?

PLACE 3 STICKY DOTS ON YOUR FAVORITE FEATURES. PLEASE PLACE ON THE EDGE OF THE IMAGE.



BOX JUMP/ JUMP LINE

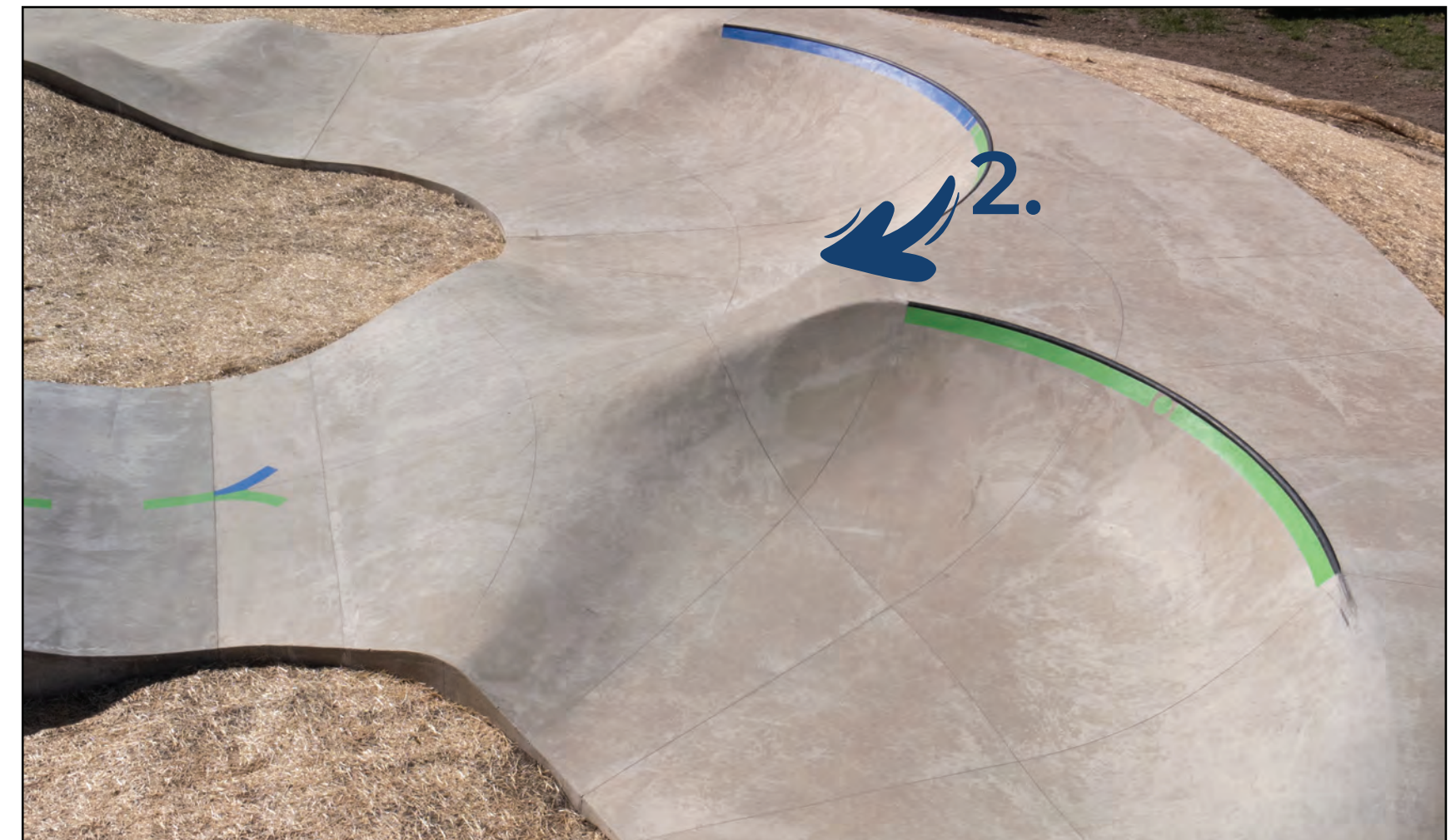

BERM TRANSFER



FLARED BOX JUMP



WALL RIDE



TABLE TOP WITH ROLLER



DOUBLE/TRIPPLE ROLLERS

TELL US WHAT YOU THINK!

FOLWELL PARK IMPROVEMENTS

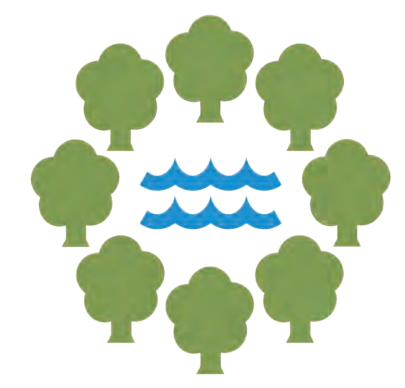

Minneapolis
Park & Recreation Board
www.minneapolisparcs.org

SKATEABLE ART:

ANY IDEAS FOR A SKATEABLE ART FEATURE? PLEASE SHARE!

EXAMPLE PIECES BY HUNGER SKATEPARKS

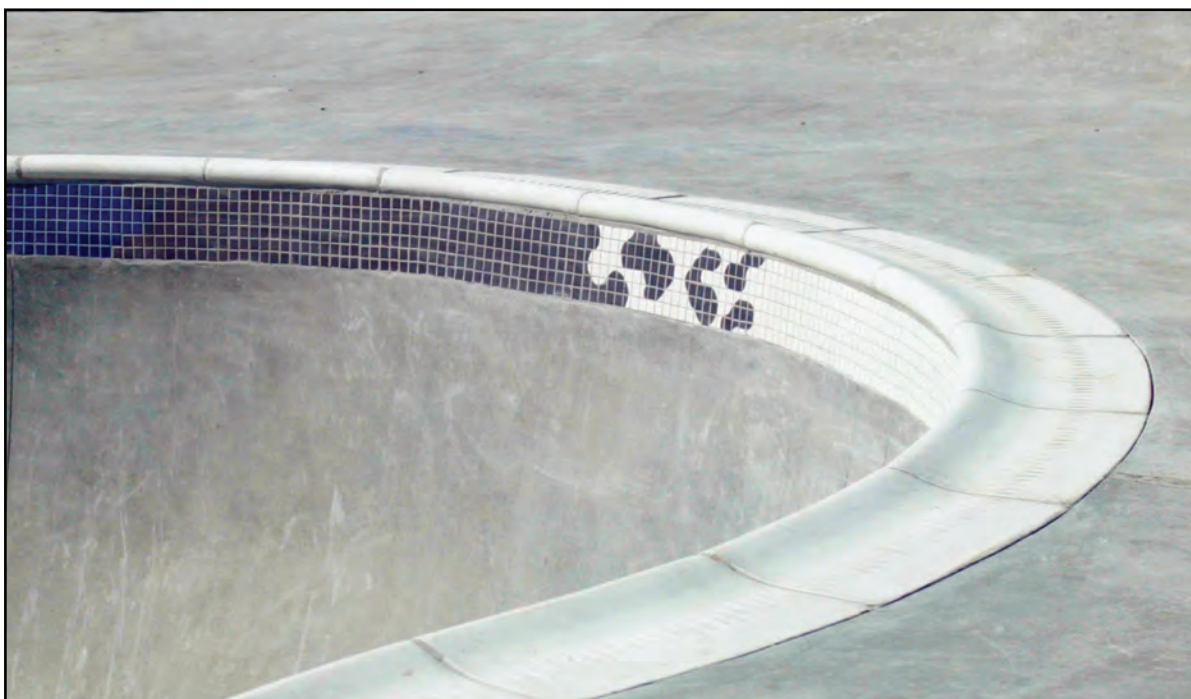

COW SPOT TILE WORK



ASL FLAT RAIL AND BOOK BANKS



BOULDER VOLCANO



COFFIN EXTENSION



RAINBOW WALL



ACID STAINED KIDNEY FURNISHINGS

LEAVE COMMENTS HERE

